

ERGOCUT S 25K



CE EN60974-7



CODE	↔	☐
------	---	---

PAS004M-095-BB3	4 m	12.5'	2 WIRES
-----------------	-----	-------	---------

PAS004M-096-BB3	4 m	12.5'	4 WIRES
-----------------	-----	-------	---------

TECHNICAL DATA		
----------------	--	--

NO HF		
1m	0,4 kg	0,88 lb
V PEAK	500	
2 bar		
31 l/min		
X 35%	20A	
4÷6 mm		

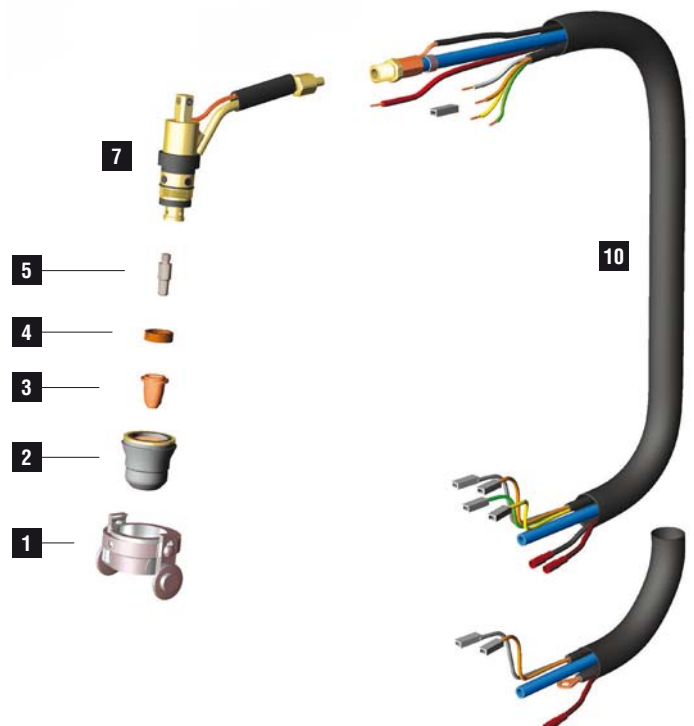
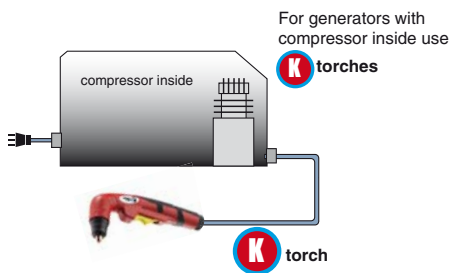

	CODE		Description	Ø	↔	CONTACT		DRAG		GOUGING	REF	
1	CV0024		plasma stand off guide	23,5 mm	33 mm							1
2	PC0117		1 ring		28 mm							4
3	PD0103-09		40 A	0,9 mm	.035"	25,8 mm					-	10
3	PD0103-65		20 A	0,65 mm	.025"	25,8 mm					-	10
3	PD0116-06		20 A	0,6 mm	.023"	17,3 mm					-	10
3	PD0116-08		30 A	0,8 mm	.030"	17,3 mm					-	10
3	PD0116-09		40 A	0,9 mm	.035"	17,3 mm					-	10
4	PE0106		plasma diffuser								-	2
5	PR0106		plasma electrode		30,5 mm							10
5	PR0110		plasma electrode		21,8 mm							10

	CODE	
7	EA0330	
7	PF0127	
8	TP0400	
9	TP0401	

	CODE	
10	PH4115	
10	PH4116	
10	QB0044	

STANDARD

CONTACT SHORT CONTACT LONG DRAG SHORT DRAG LONG

ERGOCUT S 35K



CE EN60974-7



CODE	↔	
------	---	--

PAS104M-095-BB3	4 m	12.5'	2 WIRES
-----------------	-----	-------	---------

PAS104M-096-BB3	4 m	12.5'	4 WIRES
-----------------	-----	-------	---------

TECHNICAL DATA		
----------------	--	--

	NO HF	
	0,4 kg	0,88 lb
	500	
	2.5 bar	
	60 l/min	
	32A	
	6÷8 mm	

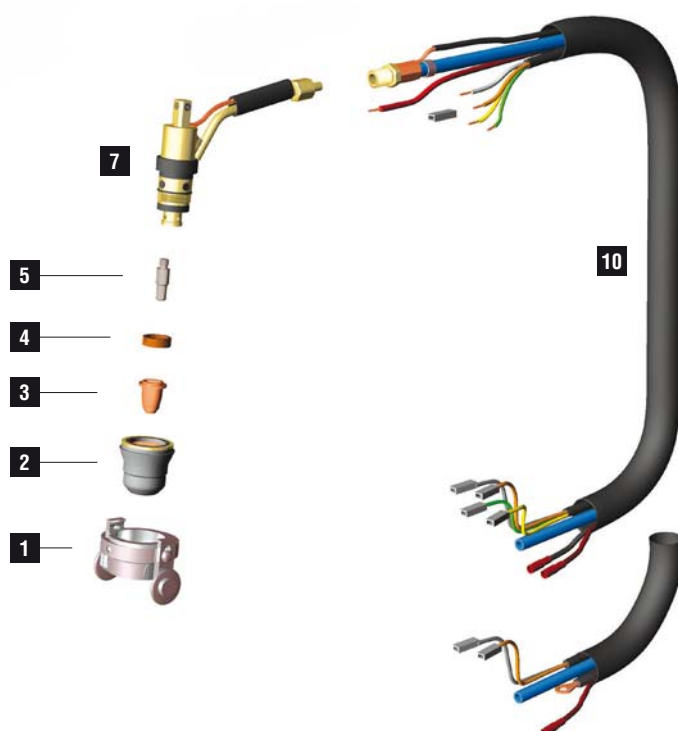
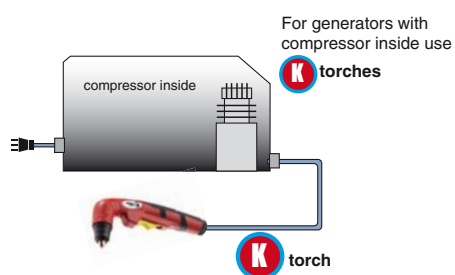

	CODE		Description	Ø	↔	CONTACT		DRAG		GOUGING	REF	
1	CV0024		plasma stand off guide	23,5 mm	33 mm							1
2	PC0135		2 rings		28 mm							4
3	PD0103-09		40 A	0,9 mm	.035"	25,8 mm					-	10
3	PD0103-65		20 A	0,65 mm	.025"	25,8 mm					-	10
3	PD0116-06		20 A	0,6 mm	.023"	17,3 mm					-	10
3	PD0116-08		30 A	0,8 mm	.030"	17,3 mm					-	10
3	PD0116-09		40 A	0,9 mm	.035"	17,3 mm					-	10
4	PE0106		plasma diffuser								-	2
5	PR0106		plasma electrode		30,5 mm							10
5	PR0110		plasma electrode		21,8 mm							10

	CODE	
7	EA0330	
7	PF0127	plasma torch head
8	TP0400	kit trigger
9	TP0401	handle kit

	CODE	
10	PH4115	4 m - direct 4 wires
10	PH4116	4 m - direct 2 wires
10	QB0044	cover (mt)

STANDARD

CONTACT SHORT CONTACT LONG DRAG SHORT DRAG LONG

ERGOCUT S 25



CE EN60974-7



CODE	↔	
------	---	--

PAS204M-095-BB3	4 m	12.5'	2 WIRES
-----------------	-----	-------	---------

TECHNICAL DATA		
----------------	--	--

NO HF		
1m	0,4 kg	0,88 lb
V PEAK	500	
5 bar		
95 l/min		
X 60%	25A	
6÷8 mm		

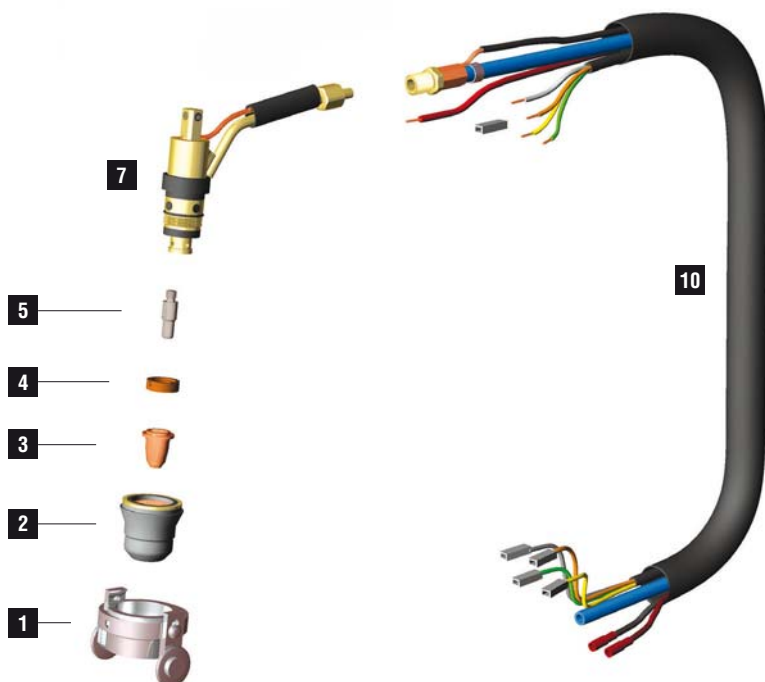
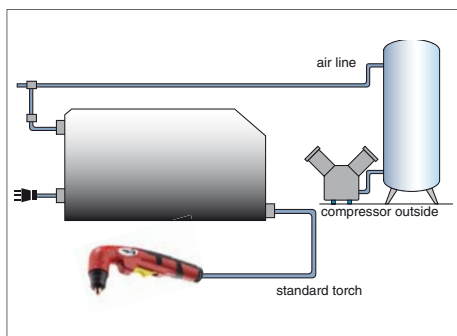

	CODE		Ø	↔	CONTACT		DRAG		GOUGING	REF		
1	CV0024		plasma stand off guide	23,5 mm	33 mm						1	
2	PC0116		no ring		28 mm						4	
3	PD0103-09		40 A	0,9 mm	.035"	25,8 mm					-	10
3	PD0103-65		20 A	0,65 mm	.025"	25,8 mm					-	10
3	PD0116-06		20 A	0,6 mm	.023"	17,3 mm					-	10
3	PD0116-08		30 A	0,8 mm	.030"	17,3 mm					-	10
3	PD0116-09		40 A	0,9 mm	.035"	17,3 mm					-	10
4	PE0106		plasma diffuser								-	2
5	PR0106		plasma electrode		30,5 mm						10	
5	PR0110		plasma electrode		21,8 mm						10	

	CODE	
7	EA0330	10
7	PF0127	1
8	TP0400	1

	CODE	
9	TP0401	1
10	PH4116	1
10	QB0044	100

STANDARD

CONTACT SHORT CONTACT LONG DRAG SHORT DRAG LONG

ERGOCUT S 45



CE EN60974-7



CODE	↔		
PAS304M-050-BB3	4 m	12.5'	 1/4 G S
PAS306M-000-BA3	6 m	19.7'	 1/4 GAS
PAS306M-004-BA3	6 m	19.7'	 CENTRAL
PAS306M-304-BA3	6 m	19.7'	 TRAFIMECTOR®

TECHNICAL DATA		
NO HF		
	0,4 kg	0,88 lb
V PEAK	500	
	5 bar	
	115 l/min	
X 60%	40A	
	8÷12 mm	

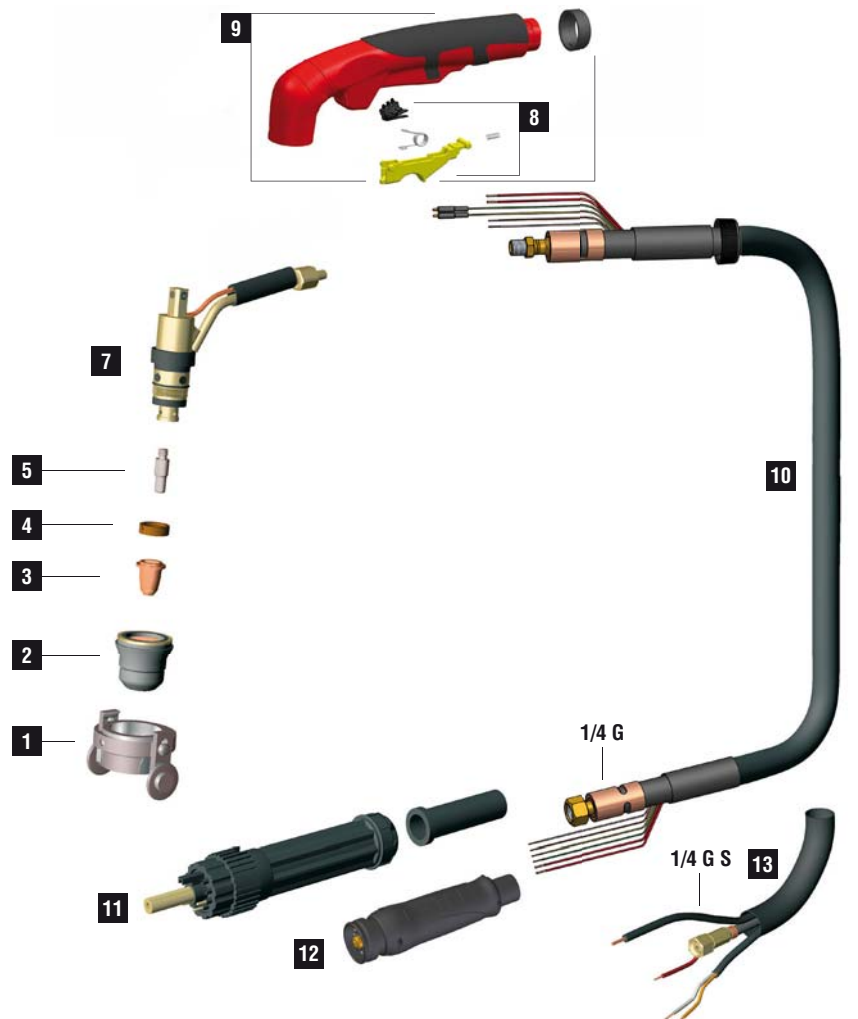
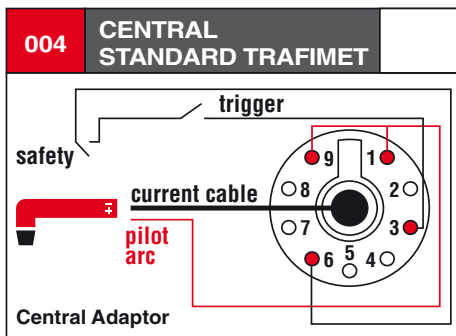

	CODE		Description	Ø	↔	CONTACT		DRAG		GOUGING	REF	
1	CV0010		plasma stand off guide		18,5 mm		●				743.0149 0618	10
1	CV0024		plasma stand off guide	23,5 mm	33 mm		●					1
2	PC0116		no ring		28 mm		●	●	●			4
3	PD0102-08		30 A	0,8 mm	.030"	13,3 mm					-	10
3	PD0102-10		50 A	1,0 mm	.040"	13,3 mm					-	10
3	PD0103-09		40 A	0,9 mm	.035"	25,8 mm			●		-	10
3	PD0103-65		20 A	0,65 mm	.025"	25,8 mm			●		-	10
3	PD0116-06		20 A	0,6 mm	.023"	17,3 mm		●			-	10
3	PD0116-08		30 A	0,8 mm	.030"	17,3 mm		●			-	10
3	PD0116-09		40 A	0,9 mm	.035"	17,3 mm		●			-	10
4	PE0106		plasma diffuser				●	●	●		-	2
5	PR0105		plasma electrode		17,8 mm		●					10
5	PR0106		plasma electrode		30,5 mm				●			10
5	PR0110		plasma electrode		21,8 mm			●				10

	CODE		Description	Quantity
7	EA0330			10
7	PF0127		plasma torch head	1
8	TP0400		kit trigger	1
9	TP0401		handle kit	1

	CODE		Description	Quantity
10	PH4127		6 m - 1/4 G	1
11	FY0023		central adaptor	1
12	FY0090		TRAFIMECTOR®	1
13	PH4148		4 m - 1/4 G S	1

STANDARD

CONTACT SHORT

CONTACT LONG

DRAG SHORT

DRAG LONG









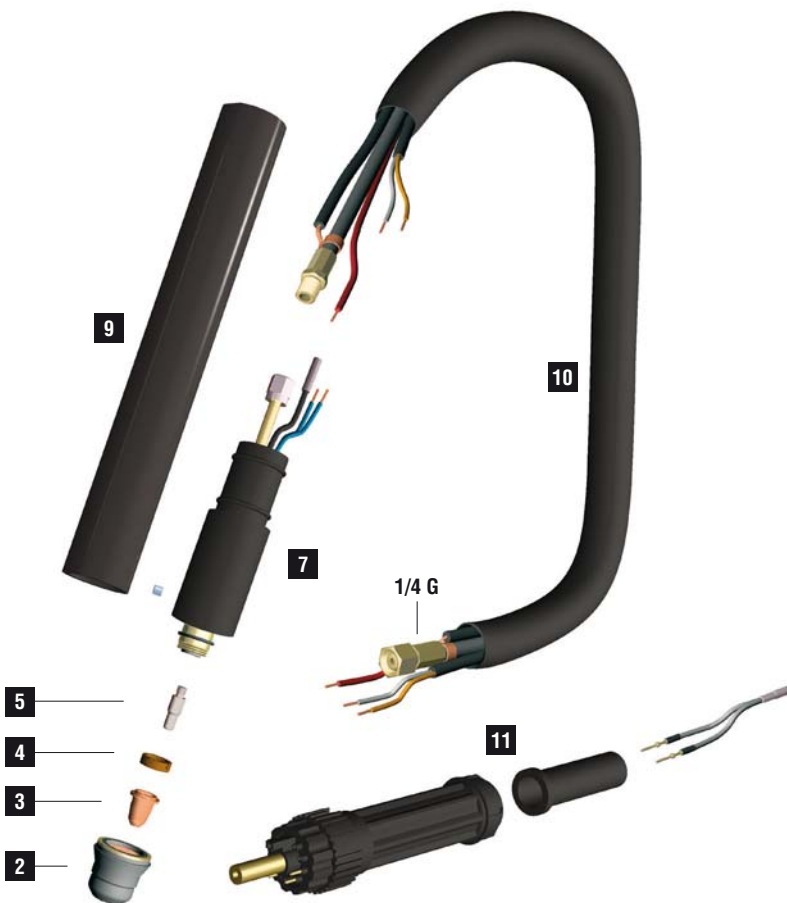
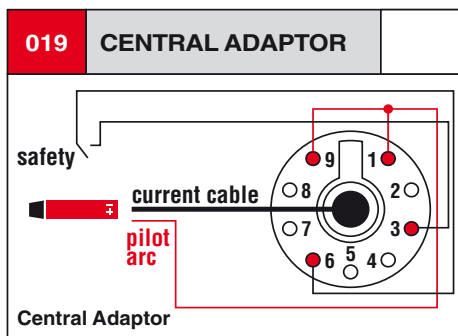
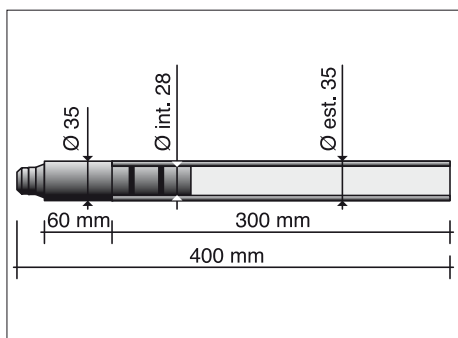





AUTO CUT S 45P













CODE	↔	⚡
PA1580	6 m	19.7'
		1/4 GAS
PA1581	6 m	19.7'
		CENTRAL

TECHNICAL DATA		
NO HF		
1 m	0,6 kg	1,32 lb
V PEAK	500	
5 bar		
115 l/min		
X 60%	40A	
8÷12 mm		



	CODE		Ø		CONTACT		REF			
										
2	PC0116		no ring			28 mm				4
3	PD0116-06		20 A	0,6 mm	.023"	17,3 mm			-	10
3	PD0116-08		30 A	0,8 mm	.030"	17,3 mm			-	10
3	PD0116-09		40 A	0,9 mm	.035"	17,3 mm			-	10
4	PE0106		plasma diffuser						-	2
5	PR0110		plasma electrode			21,8 mm				10

	CODE	
7	EA0330	 10
7	PF0126	 plasma torch head 1
7	PT0030	 repair kit 1
9	TP0061	 1
10	PH0270	 6 m - 1/4 G 1

	CODE	
10	QB0096	 cover (m) 100
11	BW0073	 10
11	BX0029	 1
11	FY0023	 central adaptor 1

STANDARD

 CONTACT SHORT

 CONTACT LONG