

ERGOCUT S 75



CE EN60974-7

CODE	↔		
PAS506M-000-BA3	6 m	19.7'	1/4 GAS
PAS506M-071-BA3	6 m	19.7'	3/8 GAS
PAS506M-004-BA3	6 m	19.7'	CENTRAL
PAS506M-304-BA3	6 m	19.7'	TRAFIMECTOR®

TECHNICAL DATA		
NO HF		
1 m	0,7 kg	1.54 lb
PEAK	500	
	5 bar	
	150 l/min	
X 60%	70A	
X 100%	50A	
	18÷23 mm	

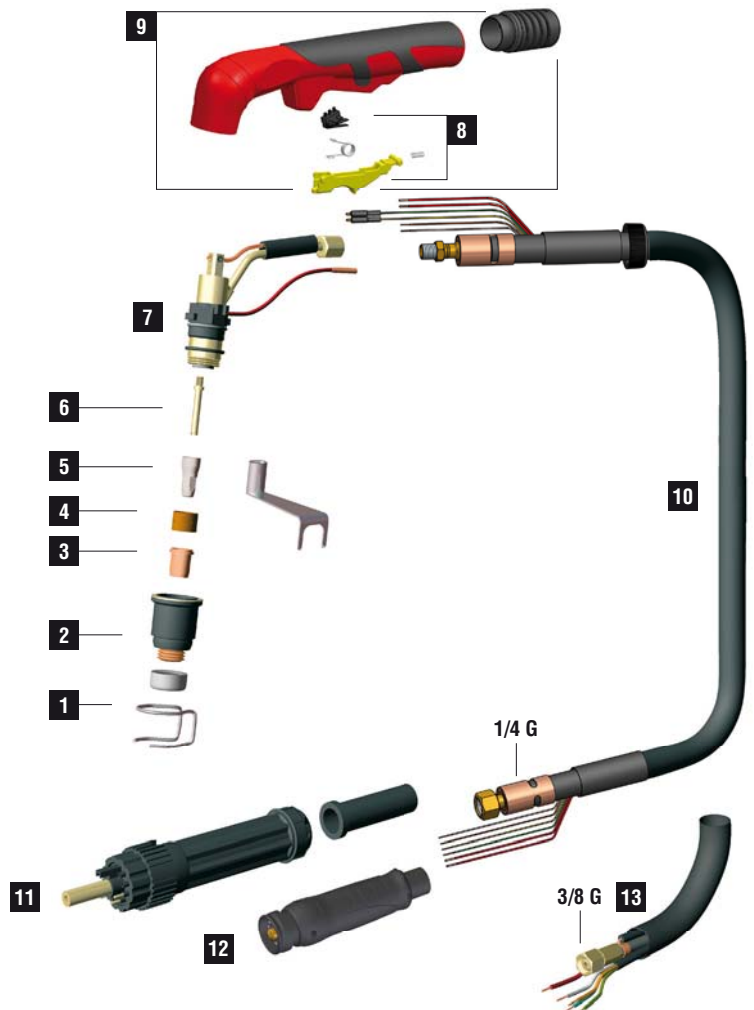
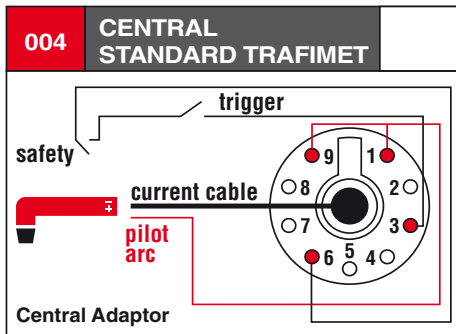

	CODE		Description	Ø	Length	CONTACT					DRAG		GOUGING	REF	
1	CV0026		plasma stand off guide		25,5 mm	•									2
1	CV0028		plasma stand off guide		20,5 mm		•								10
1	CV0033		plasma stand off guide		26 mm			•							2
1	CV0051		plasma stand off guide	24,3 mm	31 mm				•						1
2	CV0076		for PC0114												10
2	PC0114		CV0076 included		39,5 mm	•	•	•	•	•					2
3	PD0114-10		50 A	1,0 mm	.040"	18,6 mm	•	•	•					-	10
3	PD0114-12		70 A	1,2 mm	.045"	18,6 mm	•	•	•					-	10
3	PD0118-10		50 A	1,0 mm	.040"	31,1 mm				•				-	10
4	PE0112		plasma diffuser				•	•	•	•				-	2
5	CV0080														1
5	PR0117		plasma electrode		23,7 mm	•	•	•							10
5	PR0119		plasma electrode		36,2 mm					•					10
6	FH0647						•	•	•	•					10

	CODE		Description	Quantity
7	EA0223			10
7	PF0135		plasma torch head	1
8	TP0400		kit trigger	1
9	TP0402		handle kit	1
10	PH4103		6 m - 1/4 G	1

	CODE		Description	Quantity
11	CY0002		cable support	1
11	FY0023		central adaptor	1
12	FY0090		TRAFIMECTOR®	1
13	PH4109		6 m - 3/8 G	1

STANDARD

CONTACT SHORT

CONTACT LONG

DRAG SHORT

DRAG LONG

AUTO CUT S 75P



CODE	↔	
------	---	--

PA1620	6 m	19.7'	 CENTRAL
--------	-----	-------	-------------

PA1621	6 m	19.7'	 1/4 GAS
--------	-----	-------	-------------

TECHNICAL DATA		
----------------	--	--

NO HF		
	0,6 kg	1,32 lb
V PEAK	500	
	5 bar	
	150 l/min	
X 60%	70A	
X 100%	50A	
	18÷23 mm	

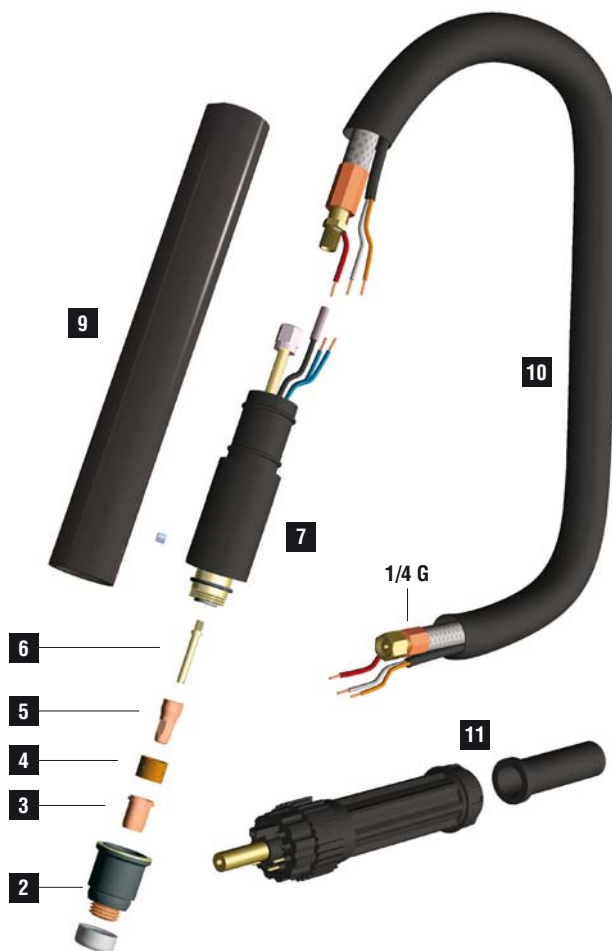
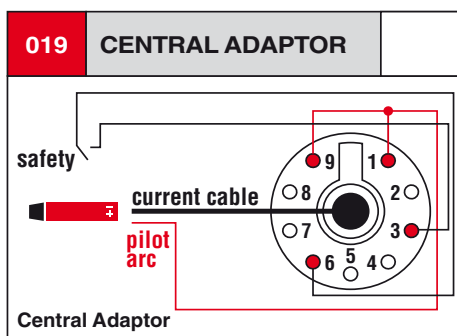
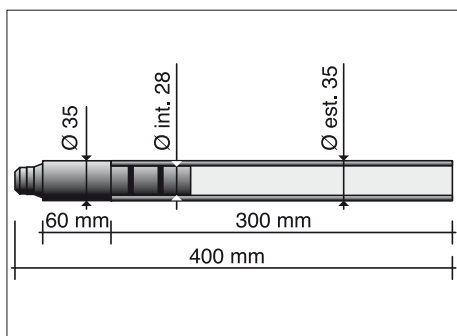

	CODE		Ø		CONTACT		REF			
2	CV0076		for PC0114						10	
2	PC0114		CV0076 included			39,5 mm			2	
3	PD0114-10		50 A	1,0 mm	.040"	18,6 mm			-	10
3	PD0114-12		70 A	1,2 mm	.045"	18,6 mm			-	10
4	PE0112		plasma diffuser						-	2
5	CV0080									1
5	PR0117		plasma electrode			23,7 mm				10
6	FH0647									10

	CODE	
7	EA0223	10
7	PF0134	plasma torch head 1
7	PT0030	repair kit 1
9	TP0061	1
10	PH0132	6 m - 1/4 G 1

	CODE	
10	PH0207	power cable 6 m - 1/4 G 1
10	QB0097	cover (mt) 100
11	CY0002	cable support 1
11	FY0023	central adaptor 1

STANDARD

CONTACT SHORT

CONTACT LONG