

# ERGOCUT A 81



CE EN60974-7

CODE	↔		📐
PAA106M-000-BA3	6 m	19.7'	1/4 GAS
PAA106M-071-BA3	6 m	19.7'	3/8 GAS
PAA106M-004-BA3	6 m	19.7'	CENTRAL
PAA106M-304-BA3	6 m	19.7'	TRAFIMECTOR®

TECHNICAL DATA		
HF		
1m	0,6 kg	1,32 lb
V PEAK	500	
5 bar		
155 l/min		
X 60%	80A	
X 100%	60A	
20÷25 mm		

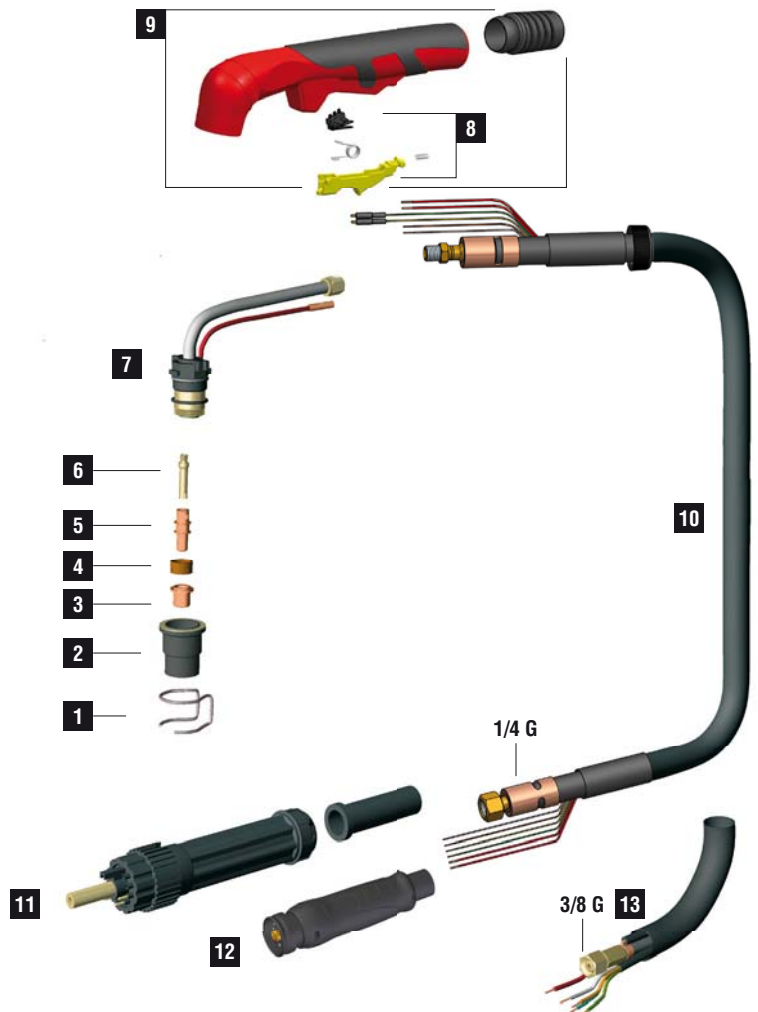
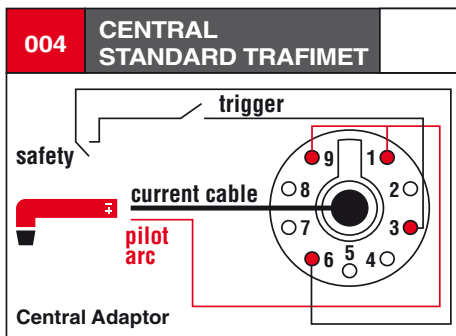

	CODE		Description	Ø	↔	CONTACT				DRAG		GOUGING	REF	
1	CV0026		plasma stand off guide		25,5 mm	●								2
1	CV0028		plasma stand off guide		20,5 mm		●							10
1	CV0033		plasma stand off guide		26 mm			●						2
1	CV0051		plasma stand off guide	24,3 mm	31 mm				●					1
1	CV0201		plasma stand off guide		30 mm					●				1
2	PC0115				35,4 mm	●	●	●	●	●				2
3	PD0105-10		50 A	1,0 mm	.040"	13,3 mm	●	●	●	●			-	10
3	PD0105-12		80 A	1,2 mm	.045"	13,3 mm	●	●	●	●			-	10
3	PD0106-12		80 A	1,2 mm	.045"	25,8 mm				●			-	10
4	PE0107		plasma diffuser				●	●	●	●			-	2
5	PR0109		plasma electrode		27 mm		●	●	●					10
5	PR0115		plasma electrode		39,5 mm					●				10
6	FH0560						●	●	●					1
6	FH0561									●				1

	CODE		Description	Quantity
7	EA0125			10
7	PF0140		plasma torch head	1
8	TP0400		kit trigger	1
9	TP0402		handle kit	1
10	PH4103		6 m - 1/4 G	1

	CODE		Description	Quantity
11	CY0002		cable support	1
11	FY0023		central adaptor	1
12	FY0090		TRAFIMECTOR®	1
13	PH4109		6 m - 3/8 G	1

STANDARD

CONTACT SHORT CONTACT LONG DRAG SHORT DRAG LONG