

MIG/MAG Welding Torch MB 602

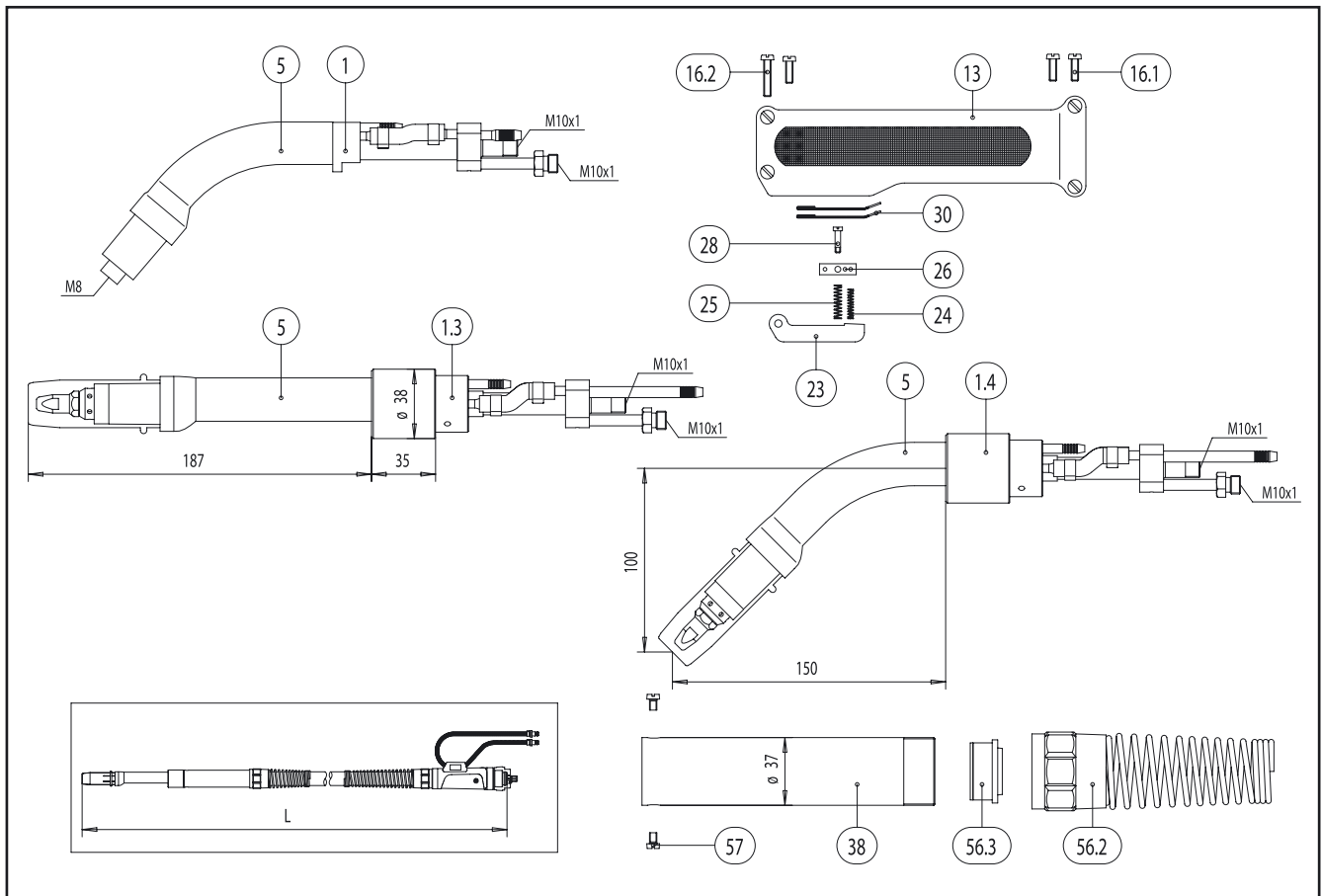

Pos.	Description	Units	Part-No.	Product-group
	Torch			
	MB 602; industrial handle; central adaptor WZ-2; 3.00 m		039.0023	1002
	MB 602; industrial handle; central adaptor WZ-2; 4.00 m		039.0025	1002
	MB 602; industrial handle; central adaptor WZ-2; 5.00 m		039.0037	1002
	AUT 602; 0°; handle tube; central adaptor WZ-2; 3.00 m		939.0083	1003
	AUT 602; 45°; handle tube; central adaptor WZ-2; 3.00 m		939.0086	1003
	Swan neck			
1	Swan neck MB 602; 50° bent		039.0001	1009
1.3	Swan neck AUT 602; straight		939.0064	1010
1.4	Swan neck AUT 602; 45° bent		939.0062	1010
5	Outer cover		024.0030	1095
	Handle			
13	Industrial handle cpl.		180.0032	1095
16.1	Flat headed screw M4x12	20 Pcs.	000.0556	9010
16.2	Pan head screw M4x20	20 Pcs.	000.0558	9010
23	Trigger		400.0032	1095
24	Pressure spring	20 Pcs.	400.0056	1095
25	Pressure spring	20 Pcs.	400.0037	1095
26	Trigger blade center	20 Pcs.	400.0038	1095
28	Center blade screw	20 Pcs.	400.0036	1095
30	Trigger blade	20 Pcs.	400.0049	1095
	Handle tube AUT			
38	Handle tube AUT		180.0097	1095
	Cable assembly			
41	Power cable MB / RB (HDH) for 3.00 m		115.0404	1012
41	Power cable MB / RB (HDH) for 4.00 m		115.0405	1012
41	Power cable MB / RB (HDH) for 5.00 m		115.0406	1012
42	Wire conduit MB cpl. red (up to wire Ø 1.2) for 3.00 m		156.0040	1012

MIG/MAG Welding Torch MB 602

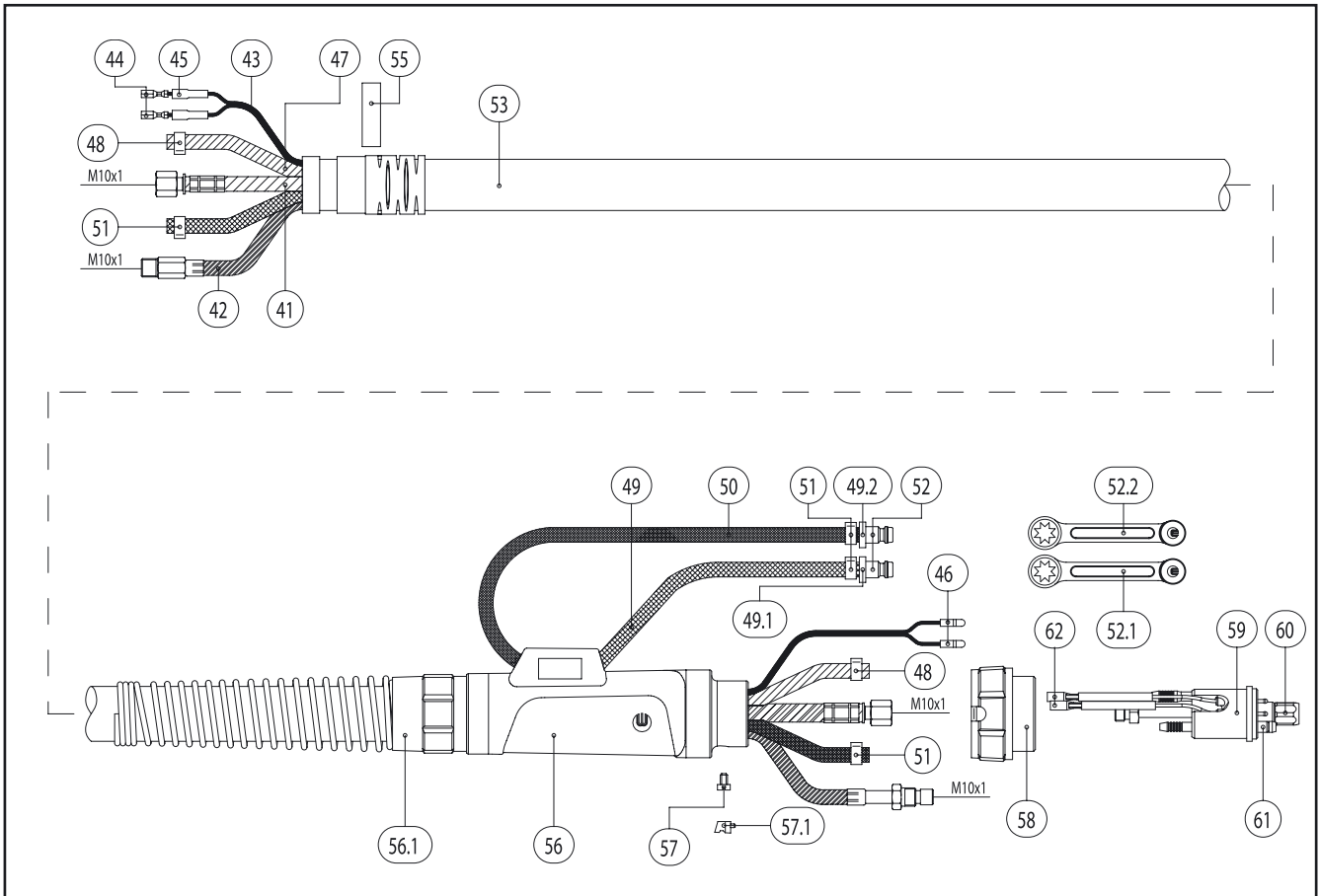

Pos.	Description	Units	Part-No.	Product-group
42	Wire conduit MB cpl. red (up to wire Ø 1.2) for 4.00 m		156.0042	1012
42	Wire conduit MB cpl. red (up to wire Ø 1.2) for 5.00 m		156.0045	1012
42	Wire conduit MB cpl. blue (wire Ø 1.6 onwards) for 3.00 m		155.0018	1012
42	Wire conduit MB cpl. blue (wire Ø 1.6 onwards) for 4.00 m		155.0020	1012
42	Wire conduit MB cpl. blue (wire Ø 1.6 onwards) for 5.00 m		155.0022	1012
43	Control cable 2-pole	200 m	100.0019	4050
44	Trigger wire connector	20 Pcs.	175.0022	9010
45	Insulating sleeve	20 Pcs.	400.0119	1095
46	Plug	20 Pcs.	175.0004	9010
47	Hose 30 black Ø 4.9x1.5	100 m	109.0040	4050
48	Hose clamp Ø 8.7 mm	20 Pcs.	171.0002	9010
49	Hose 42 HDH black; Ø 5.5x1.5	40 m	109.0052	4050
49.1	Code colour ring blue	20 Pcs.	501.2167	9010
49.2	Code colour ring red	20 Pcs.	501.2166	9010
50	Hose 46 black Ø 5.5x1.5 cpl. with plug nipple ND 5; 0.6 m		103.0108	1095
51	Hose clamp Ø 9.0 mm with ring (mark 9.5)	20 Pcs.	173.0001	9010
52	Plug nipple ND 5 mm / Ø 6.0 mm	20 Pcs.	501.0114	9010
52.1	Fastener cap red		501.2423	1095
52.2	Fastener cap blue		501.2424	1095
53	Outer cover with cable support Ø 25x1.5 for 3.00 m		107.0079	1095
53	Outer cover with cable support Ø 25x1.5 for 4.00 m		107.0044	1095
53	Outer cover with cable support Ø 25x1.5 for 5.00 m		107.0080	1095
w/o. fig.	Outer cover Ø 25x1.5	40 m	107.0004	4050
55	Ring		400.0097	1095
56	Cable support machine side big cpl. ND 31		500.0342	9010
56.1	Cable support spring		500.0233	9010
56.1	Biclip inside		400.0328	9010
56.1	Biclip outside		400.0329	9010

MIG/MAG Welding Torch MB 602

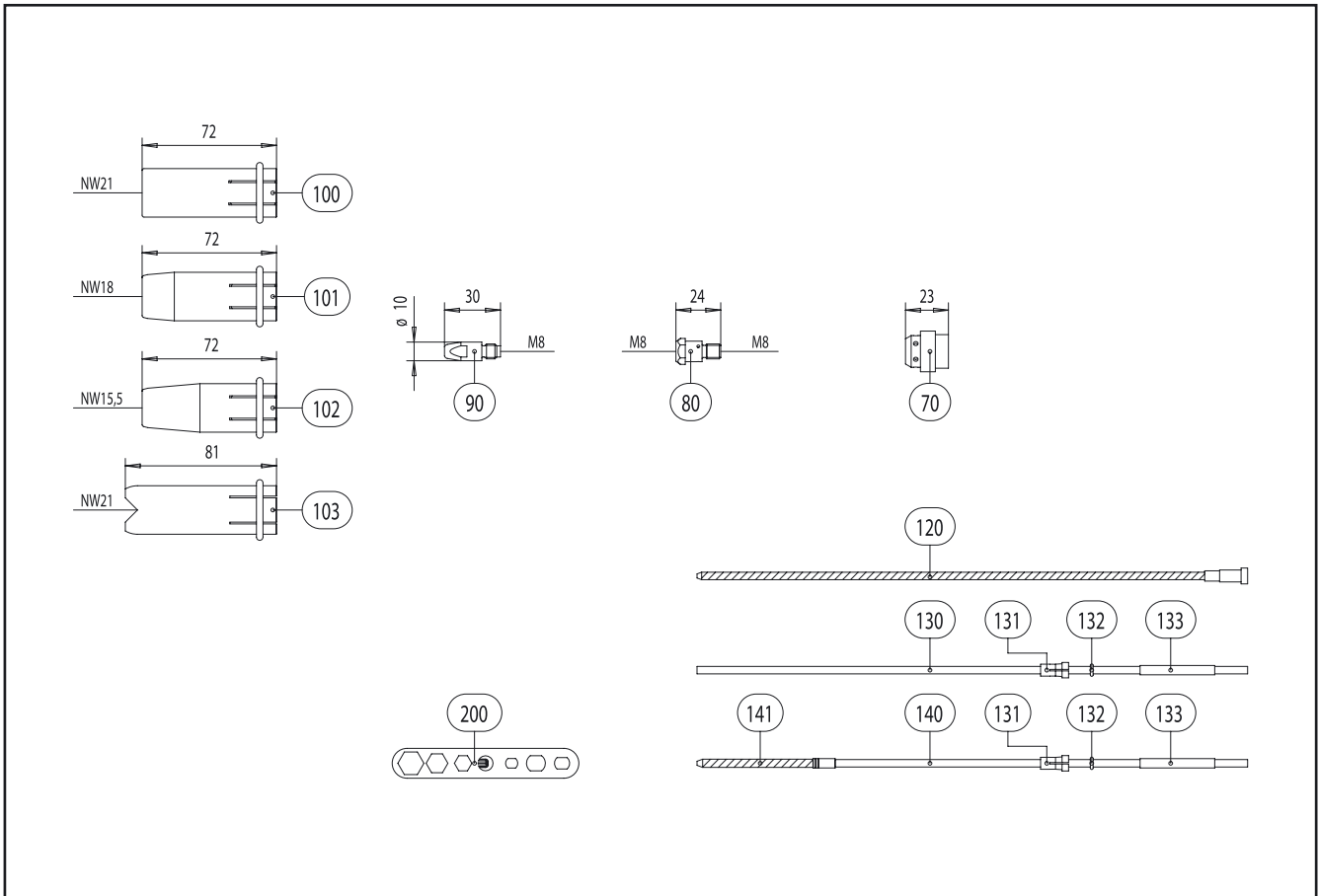

Pos.	Description	Units	Part-No.	Product-group
56.2	Cable support spring		500.0235	1095
56.3	Biclip Set 25/28		400.0332	9010
57	Pan head screw M4x6	20 Pcs.	000.0552	9010
57.1	Screw cap 1	20 Pcs.	500.0251	9010
58	Adaptor nut M33x2		500.0213	9010
59	Central adaptor WZ-2		501.0015	9010
59	Central adaptor WZ-2 without control leads		501.0034	9010
60	Coupling nut M10x1	10 Pcs.	501.0082	9010
61	O-Ring 4x1	20 Pcs.	165.0002	9010
62	Trigger wire connector; female	20 Pcs.	175.0003	9010
	Wear parts			
70	Gas diffuser	10 Pcs.	039.0008	1032
70	Gas diffuser, ceramic	10 Pcs.	039.0090	1032
80	Contact tip holder M8; 24.0 mm	10 Pcs.	142.0023	1033
90	Contact tip M8 E-Cu; Ø 1.0 (10x30)	10 Pcs.	140.0313	1030
90	Contact tip M8 E-Cu; Ø 1.2 (10x30)	10 Pcs.	140.0442	1030
90	Contact tip M8 E-Cu; Ø 1.6 (10x30)	10 Pcs.	140.0587	1030
90	Contact tip M8 E-Cu; Ø 2.0 (10x30)	10 Pcs.	140.0653	1030
90	Contact tip M8 E-Cu; Ø 2.4 (10x30)	10 Pcs.	140.0677	1030
90	Contact tip M8 CuCrZr; Ø 1.0 (10x30)	10 Pcs.	140.0316	1031
90	Contact tip M8 CuCrZr; Ø 1.2 (10x30)	10 Pcs.	140.0445	1031
90	Contact tip M8 CuCrZr; Ø 1.6 (10x30)	10 Pcs.	140.0590	1031
90	Contact tip M8 CuCrZr; Ø 2.0 (10x30)	10 Pcs.	140.0656	1031
90	Contact tip M8 CuCrZr; Ø 2.4 (10x30)	10 Pcs.	140.0679	1031
90	Contact tip M8 E-Cu; Ø 1.0 for alu wire (10x30)	10 Pcs.	141.0008	1030
90	Contact tip M8 E-Cu; Ø 1.2 for alu wire (10x30)	10 Pcs.	141.0015	1030
90	Contact tip M8 E-Cu; Ø 1.6 for alu wire (10x30)	10 Pcs.	141.0022	1030
90	Contact tip M8 CuCrZr silver-plated; Ø 1.0 (10x30)	10 Pcs.	147.0316	1031

