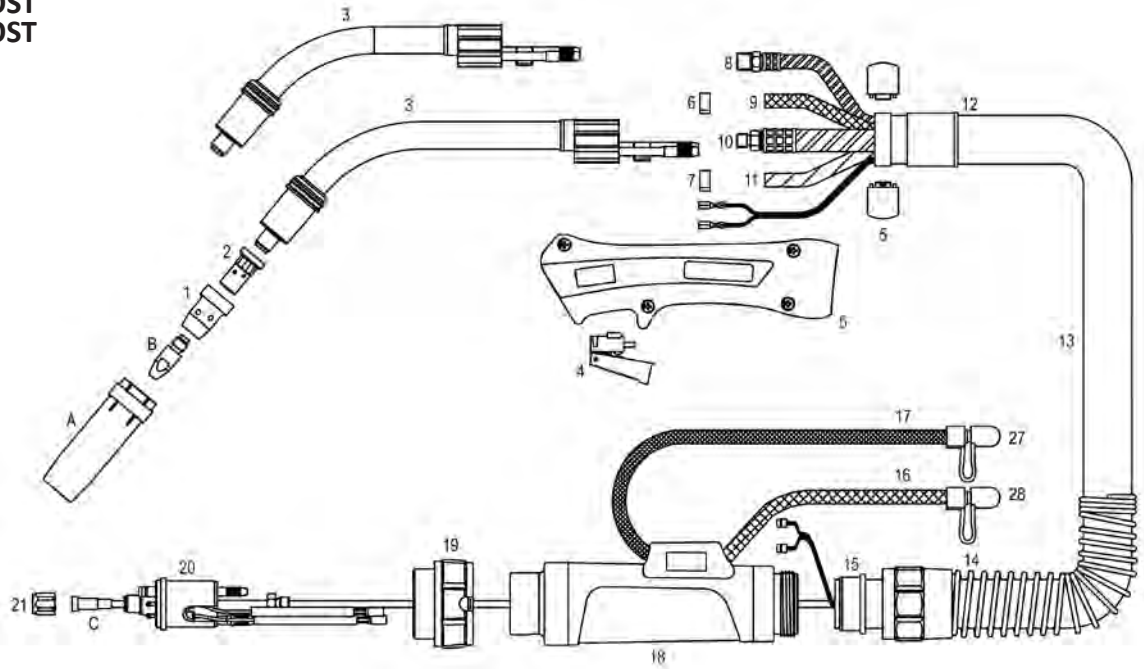

M401+ MOST
M501+ MOST

No.	Name	Catalogue No.
A	Cylindrical nozzle 20x76	55 13 000610
	Conical nozzle 16x76*	55 13 000600
	Tapered nozzle 14x76	55 13 000615
	Spot welding nozzle	55 13 000613
1	Diffuser ceramic 401/501*	55 13 009493
1.1	Diffuser white 401/501	55 13 009491
2	Tip adaptor M401/501 M6x25	55 13 003991
2.1	Tip adaptor M401/501 M6x29	55 13 003993
2.2	Tip adaptor M401/501 M8x25*	55 13 003990
2.3	Tip adaptor M401/501 M8x29	55 13 003992
3	Swan neck M401	55 13 014085
3.1	Swan neck M501	55 13 014095
4	MOST+ Handle trigger M15/501 58/000044	55 13 006962
5	MOST+ Handle kit with ball joint M15/501	55 13 018000
6	Water hose clamp Ger 8,7	50 15 000087
7	Water hose lamp Ger 10,0	50 15 000100
14	MOST+ Spring cable support M401/501 58/000025	55 13 006886
15	MOST+ Water hose lamp (set) M401/501 58/000074	55 13 006888
16	Water outlet hose nipple fi 6	50 14 182003
17	Water outlet hose M401/501 58/000075	55 13 006984
18	MOST+ Gun plug housing assembly M401/501 58/000077	55 13 006887
19	MOST+ Gun plug nut M15/501 58/000024	51 13 006983
20	MOST+ Gun plug nut body / spring pins M401/501 58/000076	55 13 006981
21	Liner nut	55 13 004300
27	Red cap stopper UBD 80320	55 13 006838
28	Lue cap stopper UBD 80320	55 13 006840
B	Contact tips (see in the page 17)	
C	Steel liner (see table page 17)	

*) standard version

Type	M401+ MOST
Cooling	Liquid
Technical data according to EN 60 974-7	
Max. Load At 60% duty cycle	400 A CO ₂ 350 A mix gas M21
Diameter of wire	0,8 - 1,6 mm
Length	Catalogue No.
3,0 m	55 08 104013
4,0 m	55 08 104014
5,0 m	55 08 104015

Type	M501+ MOST
Cooling	Liquid
Technical data according to EN 60 974-7	
Max. Load At 60% duty cycle	520 A CO ₂ 420 A mix gas M21
Diameter of wire	0,8 - 1,6 mm
Length	Catalogue No.
3,0 m	55 08 105013
4,0 m	55 08 105014
5,0 m	55 08 105015

Lp.	Description	3,0 m	4,0 m	5,0 m
8	Input cable assembly	55 13 0015999	55 13 016000	55 13 016001
		58/000068	58/000069	58/000070
9	Water inlet hose assembly 5x1,5	51 13 007120 (rm)		
10	Power cable assembly	55 13 015999	55 13 016000	55 13 016001
		58/000008	58/000009	58/000010
11	Gas hose assembly	5513015370 (rm)		
12	Cover assembly	55 13 006990	55 13 006991	55 13 006992
		58/000071	58/000072	58/000073
13	Cable set	5513006994	5513006995	5513006996
			58/000066	58/000067

Spare parts for welding torches MIG/MAG

Type	Contact tips					
	MOST M15, MB-15, (M6 slim), M6x25	MOST M24/M25/ M36, MB-24, MB- 25, MB-36, MB- 240D (M6 thick), M6x28	MOST M401/M501, MB-401D, MB-501D GRIP ALW M8x30	Abimig 155 MB 15 (M6 slim) M6x25 (No. Abicor Binzel)	Abimig 255 MB 24, MB 25, MB 36 MB-240D (M6 thick) M6x28 (No. Abicor Binzel)	Abimig 305/355/405 MB 401 D MB 501 D GRIP ALW M8x30 (No. Abicor Binzel)
0,6 mm	55 13 002150	-	-	140.0008	-	-
0,8 mm	55 13 002170	55 13 002180	55 13 002250	140.0059	140.0051	140.0114
1,0 mm	55 13 002320	55 13 002330	55 13 002340	140.0253	140.0242	140.0313
1,2 mm	55 13 002470	55 13 002480	55 13 002490	-	140.0379	140.0442
1,4 mm	-	55 13 002610	55 13 002600	-	-	-
1,6 mm	55 13 002720	55 13 002730	55 13 002800	-	140.0555	140.0587
0,6 mm CuCrZr	55 13 002151	-	-	140.0855	-	-
0,8 mm CuCrZr	55 13 002171	55 13 002190	55 13 002251	140.0062	140.0054	140.0117
1,0 mm CuCrZr	55 13 002321	55 13 002331	55 13 002341	140.0256	140.0245	140.0316
1,2 mm CuCrZr	55 13 002473	55 13 002482	55 13 002491	-	140.0382	140.0445
1,4 mm CuCrZr	-	-	55 13 002602	-	-	140.0536
1,6 mm CuCrZr	55 13 002725	55 13 002731	55 13 002801	-	140.0558	140.0590
0,8 mm al.	55 13 002172	55 13 002210	55 13 002253	141.0002	141.0001	141.0003
1,0 mm al.	55 13 002324	55 13 002335	55 13 002365	141.0007	141.0006	141.0008
1,2 mm al.	55 13 002475	55 13 002484	55 13 002493	-	141.0010	141.0015
1,6 mm al.	55 13 002726	55 13 002732	55 13 002808	-	141.0020	141.0022

Diameter	Steel liners for welding torches MIG/MAG – spiral liners for steel wires					
	MOST M15/M24/M25/M36, MB-15AK, MB-24KD, MB-25AK, MB-36KD, GRIP ALW			MOST M401/M501, MB-240D, MB-401D, MB-501D non - coated		
	3,0 m	4,0 m	5,0 m	3,0 m	4,0 m	5,0 m
0,8 mm	55 13 012390*	55 13 012400*	55 13 012402*	55 13 012390	55 13 012400	55 13 012402
1,0 mm	55 13 012440**	55 13 012470**	55 13 012480**	55 13 012490	55 13 012500	55 13 012505
1,2 mm	55 13 012440**	55 13 012470**	55 13 012480**	55 13 012490	55 13 012500	55 13 012505
1,6 mm	55 13 012510***	55 13 012530***	55 13 012541***	55 13 012570	55 13 012573	55 13 012575

Colours
 *) blue
 **) red
 ***) yellow

Diameter	Steel liners for welding torches MIG/MAG – teflon liners for aluminium wires					
	MOST M15/M24/M25/M36, MB-15AK, MB-24KD, MB-25AK, MB-36KD, GRIP ALW			MOST M401/M501, MB-240D, MB-401D, MB-501D		
	3,0 m	4,0 m	5,0 m	3,0 m	4,0 m	5,0 m
0,8 mm	55 13 012120*	55 13 012170*	55 13 012175*	55 13 012120*	55 13 012170*	55 13 012175*
1,0 mm	55 13 012205**	55 13 012206**	55 13 012207**	55 13 012205**	55 13 012206**	55 13 012207**
1,2 mm	55 13 012205**	55 13 012206**	55 13 012207**	55 13 012205**	55 13 012206**	55 13 012207**
1,6 mm	55 13 012210***	55 13 012212***	55 13 012214***	55 13 012210***	55 13 012212***	55 13 012214***
1,0 - 1,2 mm carbon-teflon-brass	55 13 013010	55 13 013020	55 13 013030	55 13 013010	55 13 013020	55 13 013030

Colours
 *) blue
 **) red
 ***) yellow