

# ERGOPLUS 240



CODE	↔	
------	---	--

MB7543	3 m	10'	
MB7544	4 m	12'	
MB7545	5 m	16.4'	

### TECHNICAL DATA

	1,3 kg	2.87 lb
<b>V PEAK</b>	113	
	0,8 ÷ 1,2 mm	.030" ÷ .045"
<b>X 100%</b>	300A CO2 - 270A Mix	
	2÷4 bar	
	1,6 l/min	

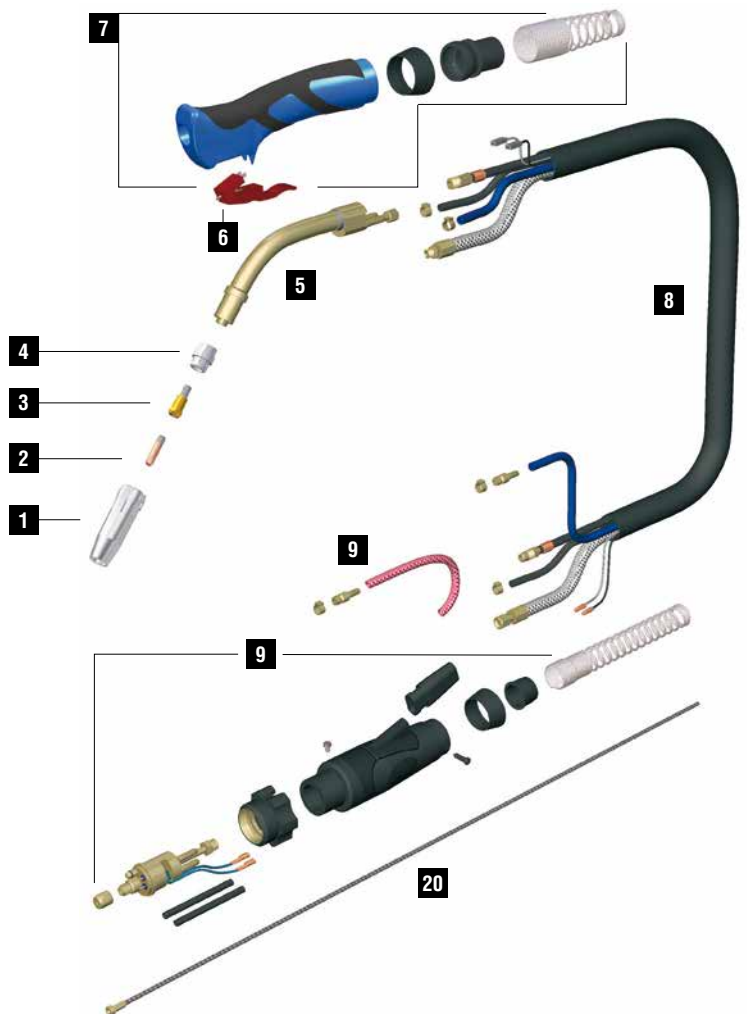

	CODE			Ø		↔	REF		
1	MC0300			17 mm			63,5 mm	145.0062	10
1	MC0301			12,5 mm	1/2"		63,5 mm	145.0080	10
1	MC0302			10 mm			63,5 mm	145.0128	10
1	MC0303			17 mm			68 mm	145.0174	10
2	MD0008-06		M6 - Cu	0,6 mm	.023"		25 mm	140.0008	20
2	MD0008-08		M6 - Cu	0,8 mm	.030"		25 mm	140.0059	20
2	MD0008-09		M6 - Cu	0,9 mm	.035"		25 mm	140.0177	20
2	MD0008-10		M6 - Cu	1,0 mm	.040"		25 mm	140.0253	20
2	MD0008-12		M6 - Cu	1,2 mm	.045"		25 mm	140.0387	20
3	MD0138-00		M6 - brass				26 mm	142.0003	10
4	ME0084		plastic				20 mm	012.0183	10
4	ME0086		silicon				20 mm	-	10
4	ME0484		plastic compound high tech				20 mm	-	10
4	ME0584		ceramic				20 mm	-	10
20	GM0526		uncoated steel liner	1,0 ÷ 1,2 mm	.040" ÷ .045"		3 m	10'	1
20	GM0527		uncoated steel liner	1,0 ÷ 1,2 mm	.040" ÷ .045"		4 m	12'	1
20	GM0528		uncoated steel liner	1,0 ÷ 1,2 mm	.040" ÷ .045"		5 m	16.4'	1

	CODE				CODE	CABLE			CODE	↔		CODE	↔	
5	MG0046		1		8	MN0012	3 m / 10' - 16 mm <sup>2</sup>		8a	BX0156	3 m / 10'	8d	QB0076	3 m / 10'
6	BX0024				8	MN0013	4 m / 12' - 16 mm <sup>2</sup>		8a	BX0157	4 m / 12'	8d	QB0077	4 m / 12'
7	MT0239		1		8	MN0014	5 m / 16.4' - 16 mm <sup>2</sup>		8a	BX0158	5 m / 16.4'	8d	QB0078	5 m / 16.4'
9	AR0052				8a	Control leads			8b	QB0072	3 m / 10'	8e	QA0019	3 m / 10'
9	BW0020				8b	Wire conduit			8b	QB0073	4 m / 12'	8e	QA0020	4 m / 12'
9	FA0026				8c	Gas hose			8b	QB0074	5 m / 16.4'	8e	QA0021	5 m / 16.4'
9	MT0101				8d	Water inlet hose			8c	QB0080	3 m / 10'	8f	MQ0205	3 m / 10'
									8c	QB0081	4 m / 12'	8f	MQ0206	4 m / 12'
									8c	QB0082	5 m / 16.4'	8f	MQ0207	5 m / 16.4'

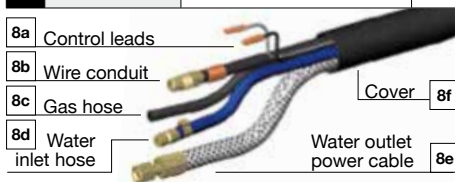

STANDARD

FOR ALL CONSUMABLES SEE PAGE 294