

MIG/MAG Fume Extraction Torch RAB 240 D "VARIO" liquid-cooled



BINZEL. The right welding torch for every job!

BINZEL liquid cooled welding torches have the high quality and technology needed for trouble-free performance whatever the welding job. All BINZEL torches are constructed to the highest standards and offer the greatest working comfort.

BINZEL torches feature:

- Optimum cooling of the torch, extending torch life
- An ergonomic handle, for easy handling in every position
- Light and flexible cable assemblies, designed to reduce fatigue

Technical data (EN 50 078):

Rating: 300 A CO₂
270 A Mixed Gases M 21 (DIN EN 439)
100% Duty Cycle
Wire sizes: 0.8 - 1.2

- Robust construction for durability and a long torch life
- A connecting system adapted to all other brands for easy torch changes

Rated using power source with VDE standard volt/amp characteristic ($U=14+0,05xI$).
When pulse welding, reduce rating by 35%. Recommended cooling capacity of water recirculator ca. 800 W.

| Type | Handle/Version | 3.00 m long | 4.00 m long | 5.00 m long |
|------------------|----------------|-------------|-------------|-------------|
| | | Part no. | Part no. | Part no. |
| RAB 240 D | Blue/VARIO | 623.0043 | 623.0044 | 623.0045 |

NB: Also available as machine version with straight and 45 ° bent torch neck and handle tube

Welding & cutting brought to the point.



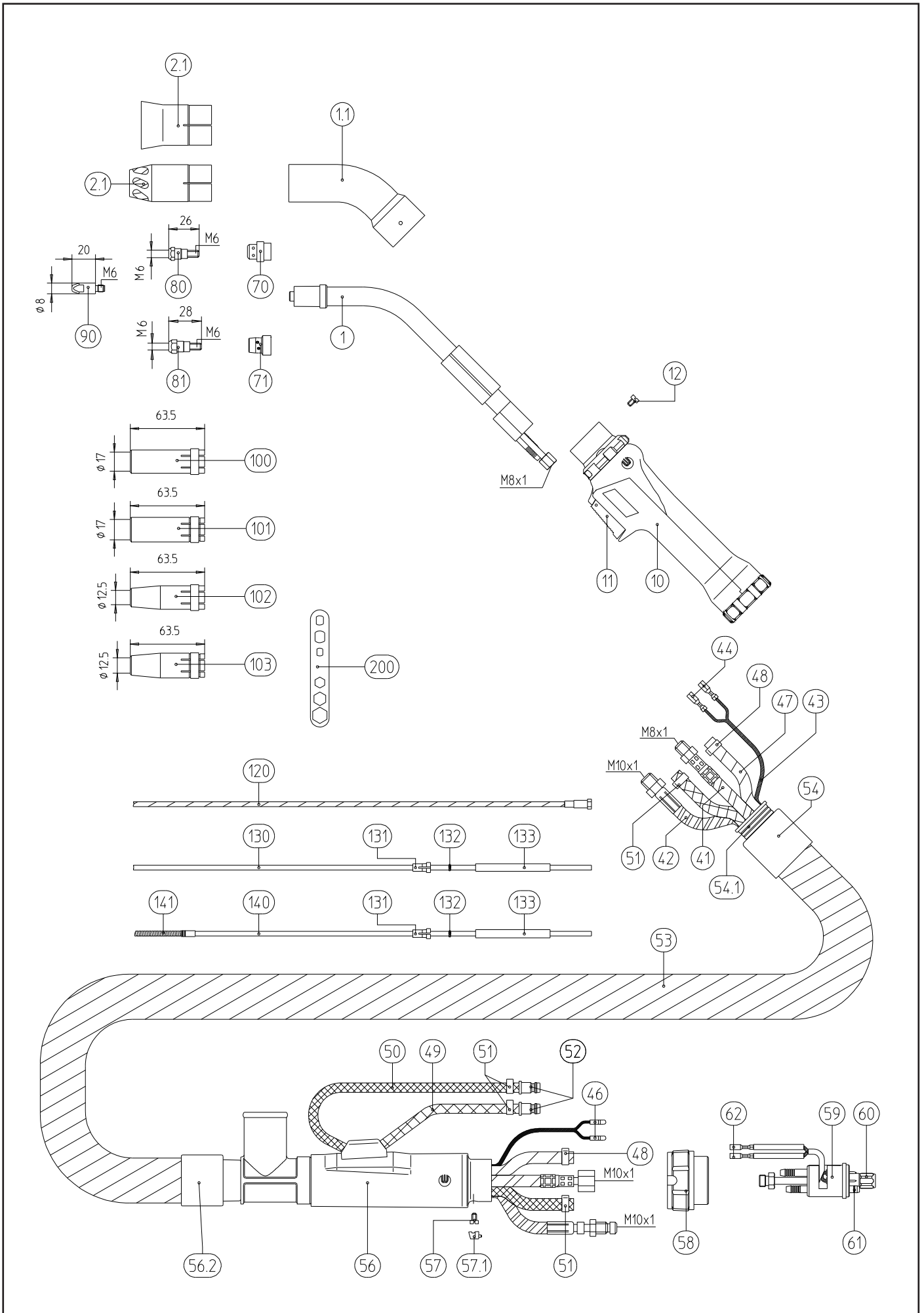

| Build group | Pos. | Description | Specifications | Part no. |
|-----------------------|---|---|-----------------------|-----------------|
| Torch | 1 | Swan neck RAB 240 D, 45° bent | | 623.0031 |
| | 1.1 | Outer neck | | 623.0030 |
| | 2 | Fume shroud for gas nozzle Ø 21.0 | | 612.0009 |
| | | Fume shroud for gas nozzle Ø 20.0 | | 612.0001 |
| | 2.1 | Fume shroud | | 612.0023 |
| Handle | 10 | Fume extraction handle VARIO | | 180.0072 |
| | 11 | Trigger 2-pol. | | 185.0031 |
| | 12 | Screw 3.5x9.5 | 20 pcs. | 079.0034 |
| | w/o. fig. | Bushing socket (protective cover for trigger area) | | 400.0303 |
| Cable assembly | 41 | Power cable | for 3.00 m | 115.0065 |
| | | Power cable | for 4.00 m | 115.0070 |
| | | Power cable | for 5.00 m | 115.0074 |
| | 42 | Wire conduit RAB (up to wire Ø 2.4) | for 3.00 m | 154.0002 |
| | | Wire conduit RAB (up to wire Ø 2.4) | for 4.00 m | 154.0003 |
| | | Wire conduit RAB (up to wire Ø 2.4) | for 5.00 m | 154.0004 |
| | 43 | Control cable 2-pol. | per meter | 100.0019 |
| | 44 | Trigger wire connector, | 20 pcs. | 175.0022 |
| | 46 | Trigger wire connector, male | 20 pcs. | 175.0004 |
| | 47 | Hose 30 black Ø 4.9x1.5 | per meter | 109.0040 |
| | 48 | Hose clamp Ø 8.7 mm | 20 pcs. | 171.0002 |
| | 49 | Hose 47 blue Ø 5.5x1.5 | per meter | 109.0057 |
| | 50 | Hose 46 red Ø 5.5x1.5, cpl., with quick connector, ND 5 | 600 mm | 103.0108 |
| | w/o. fig. | Hose 46 red Ø 5.5x1.5 | per meter | 109.0056 |
| | 51 | Hose clamp Ø 9.0 mm with ring (mark 9.5) | 20 pcs. | 173.0001 |
| | 52 | Quick connector | 20 pcs. | 501.0114 |
| | 53 | Hose 34 black LW 38 R | per meter | 109.0044 |
| | w/o. fig. | Hose 34 black LW 38 R | for 3.00 m | 106.0052 |
| | w/o. fig. | Hose 34 black LW 38 R | for 4.00 m | 106.0053 |
| | w/o. fig. | Hose 34 black LW 38 R | for 5.00 m | 106.0054 |
| | 54 | Collet LW 38 | | 400.0478 |
| | 54.1 | Connector | | 400.0289 |
| | 56 | Fume extraction cable support cpl. LW 38 | | 501.2081 |
| | 56.2 | Screw socket black LW 38 | | 500.0267 |
| | 57 | Screw M4x6 | 20 pcs. | 000.0552 |
| | 57.1 | Covering cap 2 | 20 pcs. | 500.0362 |
| 58 | Adaptor nut | | 501.0014 | |
| 59 | Central adaptor block WZ-2 with control leads | | 501.0015 | |
| 60 | Nut M10x1 | 10 pcs. | 501.0082 | |
| 61 | O-ring 4x1 | 20 pcs. | 165.0002 | |
| 62 | Trigger wire connector, female | 20 pcs. | 175.0003 | |

| Build group | Pos. | Description | Specifications | Part no. |
|-------------|-----------|--|--|----------------------------------|
| Wear parts | 70 | Gas diffuser, white | • 10 pcs. | 012.0183 |
| | 80 | Contact tip holder M6, 26.0 mm | • 10 pcs. | 142.0003 |
| | w/o. fig. | Contact tip holder M6, 28.0 mm | 10 pcs. | 142.0010 |
| | 90 | Contact tip M6 E-Cu, Ø 0.8 ⁴⁾ | 10 pcs. | 140.0051 |
| | | Contact tip M6 E-Cu, Ø 1.0 ⁴⁾ | • 10 pcs. | 140.0242 |
| | | Contact tip M6 E-Cu, Ø 1.2 ⁴⁾ | 10 pcs. | 140.0379 |
| | | Contact tip M6 CuCrZr, Ø 0.8 ⁴⁾ | 10 pcs. | 140.0054 |
| | | Contact tip M6 CuCrZr, Ø 1.0 ⁴⁾ | 10 pcs. | 140.0245 |
| | | Contact tip M6 CuCrZr, Ø 1.2 ⁴⁾ | 10 pcs. | 140.0382 |
| | | Contact tip M6 E-Cu, Ø 0.8 for alu wire ⁴⁾ | 10 pcs. | 141.0001 |
| | | Contact tip M6 E-Cu, Ø 1.0 for alu wire ⁴⁾ | 10 pcs. | 141.0006 |
| | | Contact tip M6 E-Cu, Ø 1.2 for alu wire ⁴⁾ | 10 pcs. | 141.0010 |
| | 100 | Gas nozzle, cylindrical ND Ø 17.0 | 10 pcs. | 145.0047 |
| | 101 | Gas nozzle, cylindrical, heavy duty ND Ø 17.0 | 10 pcs. | 145.0062 |
| | 102 | Gas nozzle, conical ND Ø 12.5 | • 10 pcs. | 145.0080 |
| | 103 | Gas nozzle, conical, heavy duty ND Ø 12.5 | 10 pcs. | 145.0101 |
| | 120 | Guide spiral liner blank 1.5/4.0 with nipple for wire electrode ¹⁾ Ø 0.6-0.9 | for 3.00 m for 4.00 m for 5.00 m | 122.0005 122.0007 122.0009 |
| | | Guide spiral liner blank 2.0/4.5 with nipple for wire electrode ¹⁾ Ø 1.0-1.2 | • for 3.00 m • for 4.00 m • for 5.00 m | 122.0031 122.0036 122.0039 |
| | 130 | Teflon core liner 1.5/4.0 blue with collet and O-ring for wire electrode ²⁾ Ø 0.6-1.0 | for 3.00 m for 4.00 m for 5.00 m | 126.0005 126.0008 126.0011 |
| | | Teflon core liner 2.0/4.0 red with collet and O-ring for wire electrode ²⁾ Ø 1.0-1.2 | for 3.00 m for 4.00 m for 5.00 m | 126.0021 126.0026 126.0028 |
| | | Teflon carbon core liner 1.5/4.0 with collet and O-ring for wire electrode ²⁾ Ø 0.6-1.0 | for 3.00 m for 4.00 m for 5.00 m | 127.0002 127.0003 127.0004 |
| | | Teflon carbon core liner 2.0/4.0 with collet and O-ring for wire electrode ²⁾ Ø 1.0-1.2 | for 3.00 m for 4.00 m for 5.00 m | 127.0005 127.0007 127.0008 |
| | | Polyamid core liner ³⁾ 2.0/4.0 with collet and O-ring for wire electrode ²⁾ Ø 1,0-1,2 | for 3.00 m for 4.00 m for 5.00 m | 128.0012 128.0015 128.0016 |
| | 131 | Collet for core liner at Ø 4.0 | 20 pcs. | 131.0001 |
| | 132 | O-ring 3.5x1.5 | 20 pcs. | 165.0008 |
| | 133 | Guide tube for core liners up to Ø 4.0 | up to 200 mm | 129.0461 |

| Build group | Pos. | Description | Specifications | Part no. |
|-------------|------|--|--|----------------------------------|
| Wear parts | 140 | Combined wire guide cpl. polyamide/brass 2.0/4.0 for wire Ø 1.0-1.2 | for 3.00 m for 4.00 m for 5.00 m | 128.M002 128.M003 128.M004 |
| | 141 | Brass spiral made up with sleeve | 200 mm | 001.0305 |
| | 200 | Spanner | 10 pcs. | 191.0001 |

¹⁾ Applicable for GMA welding of unalloyed and low-alloyed steels (DIN 8555 and 8559).

²⁾ Applicable for GMA welding of aluminium (DIN 1732), copper and copper alloys (DIN 1733) and nickel/nickel alloys (DIN 1736); Also for use with GMA welding of stainless and heat resistant steels (DIN 8556).

³⁾ Applicable up to max. 150° C.

⁴⁾ As an alternative: Packing unit 50 pcs. Specification of order: 140.xxxx.50 or 141.xxxx.50.

- Standard equipment

The positions indicating "per meter" are available in commercial lengths.

Welding & cutting brought to the point.



Alexander Binzel Schweisstechnik GmbH & Co. KG
P.O. Box 10 01 53 · D-35331 Giessen
Tel.: ++49 (0) 64 08 / 59-0
Fax: ++49 (0) 64 08 / 59-194
Internet: www.binzel-abicor.com