

▼ 8. WELDING TORCHES AND ACCESSORIES

▼ 8.1. MIG/MAG torches

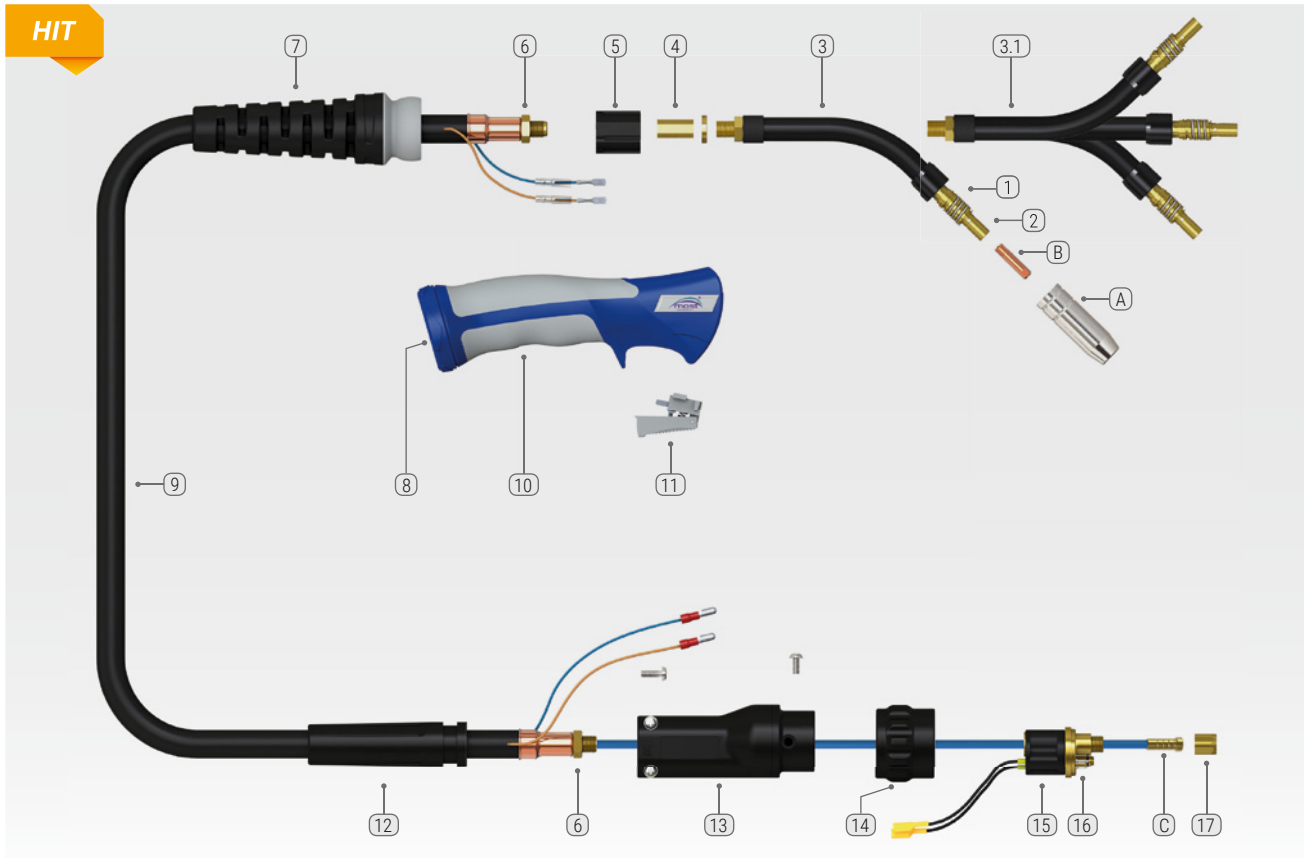

M15 SGRIP



Model	M15 SGRIP
Cooling	Gas
Technical data according to EN 60 974-7:	
▪ Rating 60% duty cycle	180 A - CO ₂ 150 A - mix M21
▪ Wire diameter	0,6-1,0 mm
Length / Catalogue No.	(3,0 m) 55 08 301530 (4,0 m) 55 08 301540 (5,0 m) 55 08 301550

No.	Replaceable elements	Catalogue No.
A	Straight gas nozzle Ø16 Conical gas nozzle Ø12* Conical gas nozzle Ø9,5 Spot welding gas nozzle	55 12 300885 55 12 300890 55 12 300880 55 12 300882
1	Spring*	55 13 008340
2	Contact tip holder with spring	55 13 003751
3	M-15 without nozzle and tip*	55 13 014060
3.1	M-15 flexible swan neck without nozzle and tip	55 13 01406F

No.	Replaceable elements	Catalogue No.
4	Intermediate adapter, brass	55 13 003760
5	Connector body	55 13 013258
6	M10x1 low nut	55 13 004309
7	MOST torch stiffener M15/25 UG8015	55 13 006834
8	MOST torch nut UG8008	55 13 006837
9	Welding cable combined 3 m	55 13 016090
9.1	Welding cable combined 4 m	55 13 016091
9.2	Welding cable combined 5 m	55 13 016092
10	MOST torch grip M GRIP UG2514/K/J/B	55 13 006515
11	MOST trigger M15/501 UG2516	55 13 006517
12	MOST stiffener for euro plug UC2841 M15 / 25	55 13 006835
13	MOST euro plug connector M15/36 UC1518	55 13 006518
14	MOST euro plug nut M15/501 UC1519	55 13 006519
15	Integrated connector UC1528	55 13 006569
16	O-ring 4x1	55 13 013962
17	Special insert nut	55 13 004300
B	M6x25 contact tip	(table p. 54)
C	Liners	(table p. 54)

* standard version



M24 SGRIP

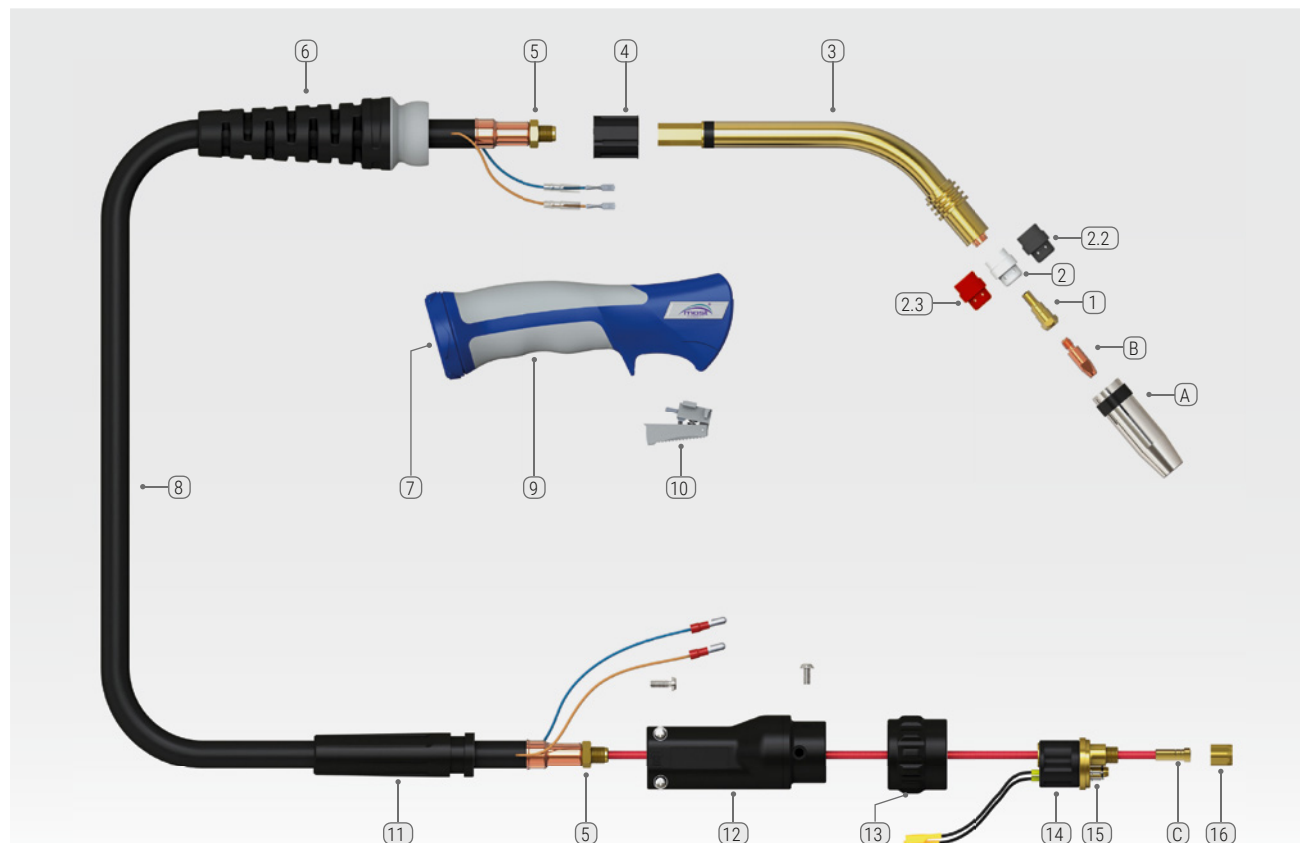

Model	M24 SGRIP
Cooling	Gas
Technical data according to EN 60 974-7:	
▪ Rating 60% duty cycle	250 A - CO ₂ 220 A - mix M21
▪ Wire diameter	0,8-1,2 mm
Length / Catalogue No.	(3,0 m) 55 08 302430 (4,0 m) 55 08 302440 (5,0 m) 55 08 302450

No.	Replaceable elements	Catalogue No.
A	Straight gas nozzle 17x63,5 Conical gas nozzle 12,5x63,5* Conical gas nozzle 10x63,5	55 12 300897 55 12 300895 55 12 300896
1	M6* contact tip holder	55 13 003800
2	M-24 gas diffuser ceramic white*	55 13 009460
2.1	M-24 gas diffuser, white	55 13 009465
2.2	M-24 gas diffuser, black	55 13 009464
2.3	M-24 silicone gas diffuser	55 13 009467

No.	Replaceable elements	Catalogue No.
3	M24 swan neck	55 13 014063
4	Connector body	55 13 013258
5	M10x1 low nut	55 13 004309
6	MOST torch stiffener M24/M36 UG8016	55 13 006832
7	MOST torch nut UG8008	55 13 006837
8	MOST welding cable M24 3 m	55 13 016093
8.1	MOST welding cable M24 4 m	55 13 016094
8.2	MOST welding cable M24 5 m	55 13 016095
9	MOST torch grip M GRIP UG2514/KJ/B	55 13 006515
10	MOST trigger M15/501 UG2516	55 13 006517
11	MOST stiffener for euro plug M15/25 UC2841	55 13 006835
12	MOST euro plug connector M24/36 UC3641	55 13 006833
13	MOST euro plug nut M15/25 UC1519	55 13 006519
14	Integrated connector UC1528	55 13 006569
15	O-ring 4x1	55 13 013962
16	Special insert nut	55 13 004300
B	M6x28 contact tip	(table p. 54)
C	Liners	(table p. 54)

* standard version



M25 SGRIP

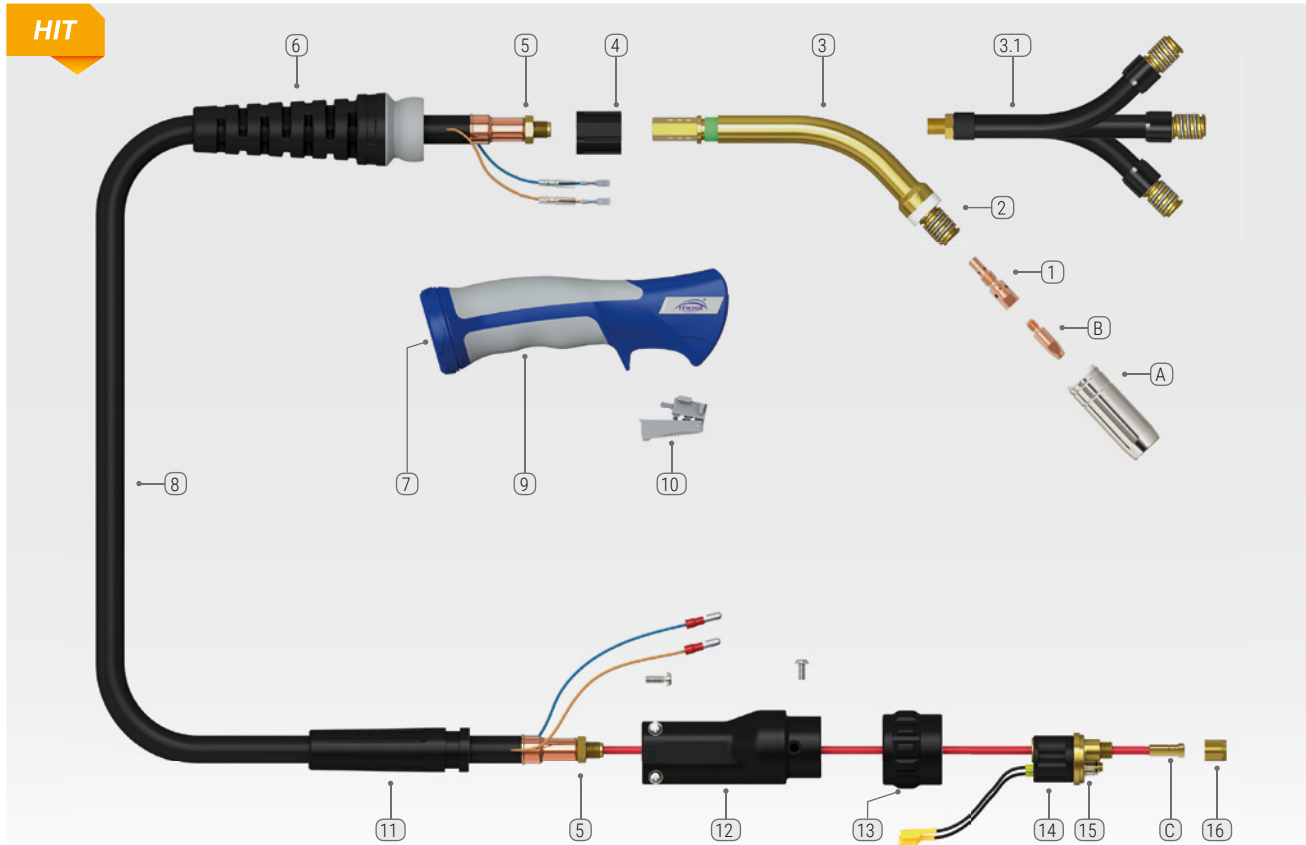

Model	M25 SGRIP
Cooling	Gas
Technical data according to EN 60 974-7:	
▪ Rating 60% duty cycle	230 A - CO ₂ 200 A - mix M21
▪ Wire diameter	0,8-1,2 mm
Length / Catalogue No.	(3,0 m) 55 08 302530 (4,0 m) 55 08 302540 (5,0 m) 55 08 302550

No.	Replaceable elements	Catalogue No.
A	Straight gas nozzle 18x57	55 12 300901
	Conical gas nozzle 15x57*	55 12 300900
	Conical gas nozzle 11,5x57	55 12 300904
	Spot welding gas nozzle	55 12 300903
1	M25* contact tip holder	55 13 003804
2	M25* spring	55 13 008360
3	M-25 without nozzle and tip*	55 13 014072
3.1	M-25 flexible swan neck without nozzle and tip	55 13 01407F

No.	Replaceable elements	Catalogue No.
4	Connector body	55 13 013258
5	M10x1 low nut	55 13 004309
6	MOST torch stiffener M15/25 UG8015	55 13 006834
7	MOST torch nut UG8008	55 13 006837
8	Welding cable M-25 3 m	55 13 016093
8.1	Welding cable M-25 4 m	55 13 016094
8.2	Welding cable M-25 5 m	55 13 016095
9	MOST torch grip MSGRIP UG 2514/KJ/B	55 13 006515
10	MOST trigger M15/501 UG2516	55 13 006517
11	MOST stiffener for euro plug M15/25 UC2841	55 13 006835
12	MOST euro plug connector M15/36 UC1518	55 13 006518
13	MOST euro plug nut M15/501 UC1519	55 13 006519
14	Integrated connector	55 13006569
15	O-ring 4x1	55 13 013962
16	Special insert nut	55 13 004300
B	M6x28 contact tip	(table p. 54)
C	Liners	(table p. 54)

* standard version



M36 SGRIP

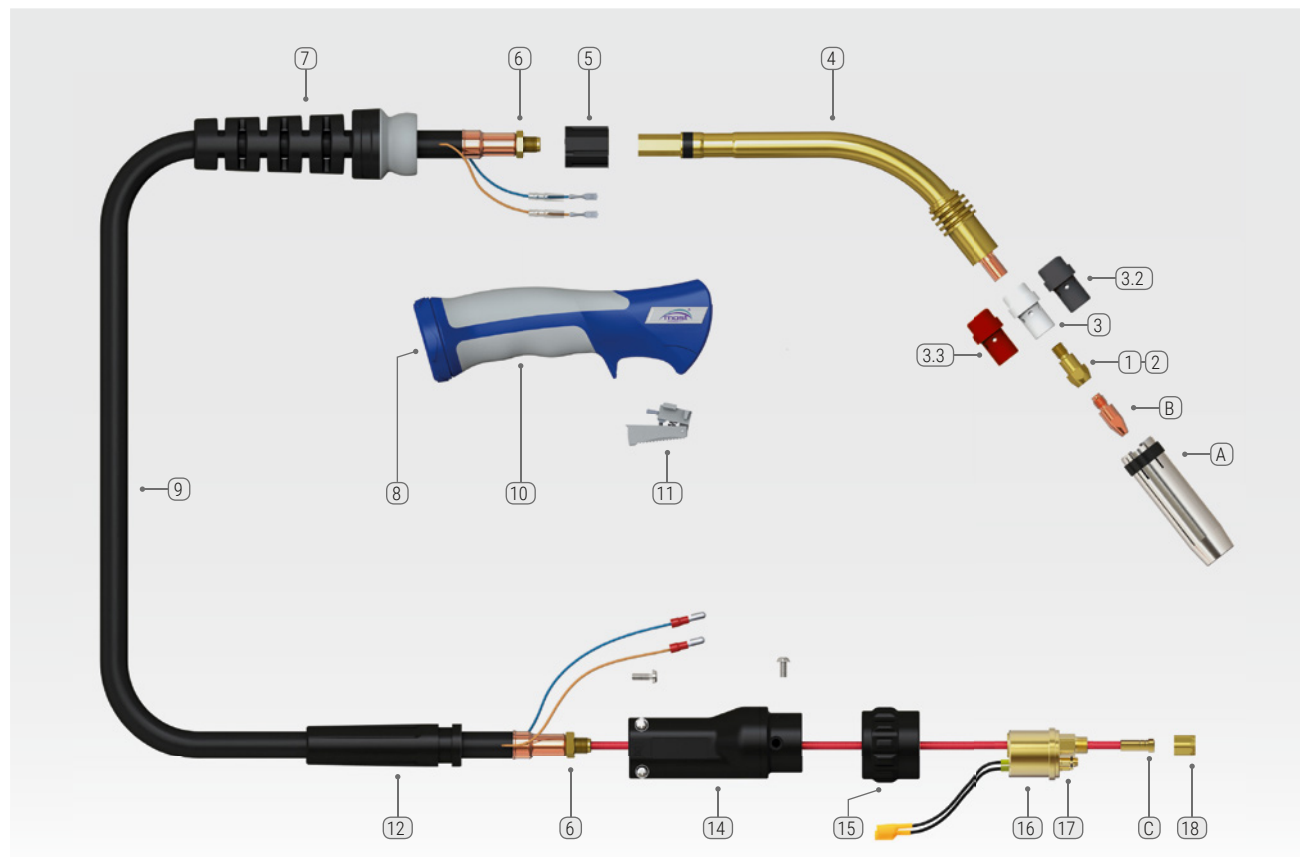

Model	M36 SGRIP
Cooling	Gas
Technical data according to EN 60 974-7:	
▪ Rating 60% duty cycle	320 A - CO ₂ 290 A - mix M21
▪ Wire diameter	0,8-1,2 mm
Length / Catalogue No.	(3,0 m) 55 08 303630 (4,0 m) 55 08 303640 (5,0 m) 55 08 303650

No.	Replaceable elements	Catalogue No.
A	Straight gas nozzle 19x84 Conical gas nozzle 16x84* Conical gas nozzle 12x84 Spot welding gas nozzle	55 12 300915 55 12 300910 55 12 300914 55 12 300917
1	M6x28* contact tip holder	55 13 003806
2	M8x28 contact tip holder	55 13 003816
3	M-36 gas diffuser ceramic white*	55 13 009486
3.1	M-36 gas diffuser, white	55 13 009485
3.2	M-36 gas diffuser, black	55 13 009484
3.3	M-36 silicone gas diffuser	55 13 00948S

No.	Replaceable elements	Catalogue No.
4	M36 swan neck	55 13 014080
5	Connector body	55 13 013258
6	M10x1 low nut	55 13 004309
7	MOST torch stiffener M36 UG8016	55 13 006832
8	MOST torch nut UG8008	55 13 006837
9	Welding cable M36 3 m	55 13 016096
9.1	Welding cable M36 4 m	55 13 016097
9.2	Welding cable M36 5 m	55 13 016098
10	MOST torch grip MSGRIP UG2514/KJ/B	55 13 006515
11	MOST trigger M15/501 UG2516	55 13 006517
12	MOST stiffener for euro plug M36 UC3641	55 13 006833
14	MOST euro plug connector M15/36 UC1518	55 13 006518
15	MOST euro plug nut M15/501 UC1519	55 13 006519
16	Integrated connector	55 13 006569
17	O-ring 4x1	55 13 013962
18	Special insert nut	55 13 004300
B	M6x28 contact tip	(table p. 54)
C	Liners	(table p. 54)

* standard version



M38 SGRIP

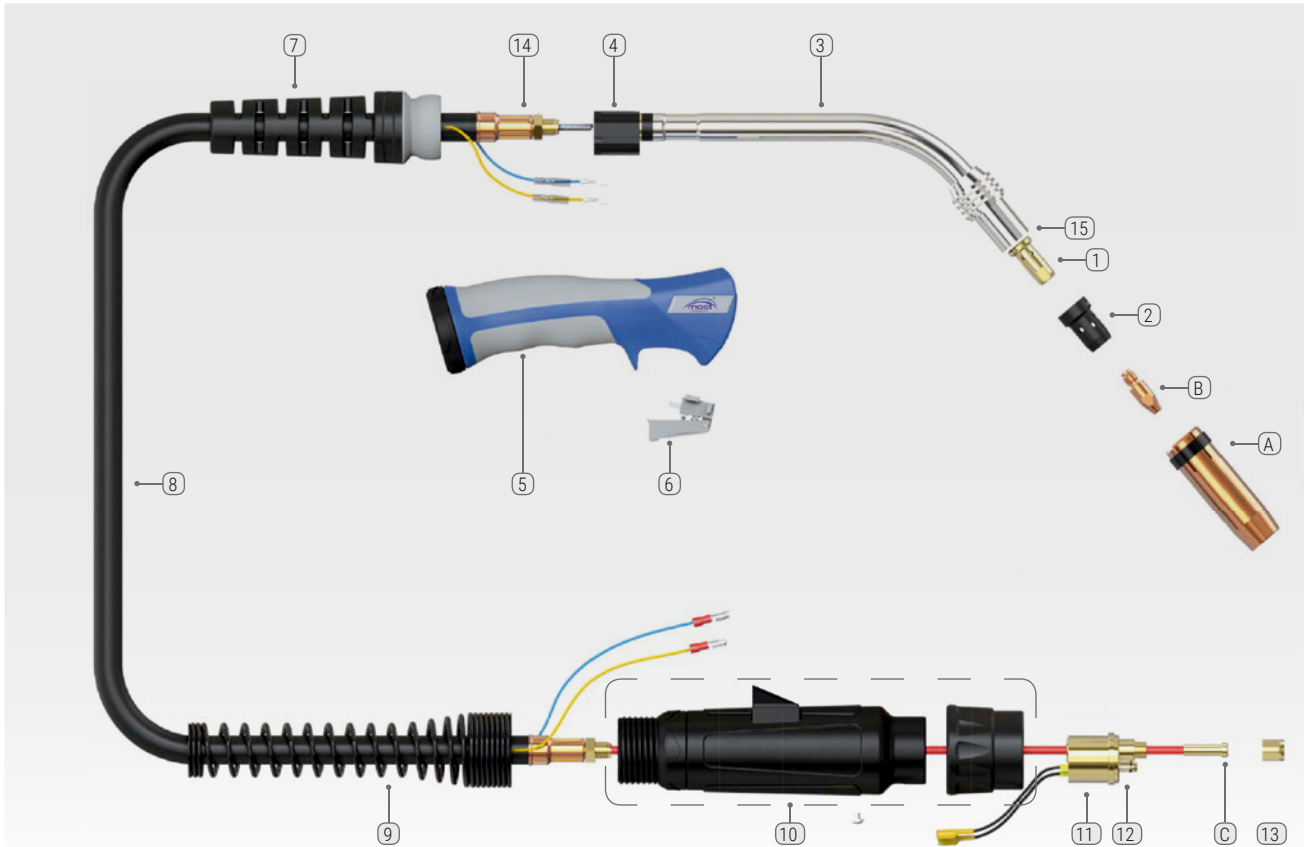

Model	M38 SGRIP
Cooling	Gas
Technical data according to EN 60 974-7:	
▪ Rating 60% duty cycle	350 A - CO ₂ 320 A - mix M21
▪ Wire diameter	1,0-1,6 mm
Length / Catalogue No.	(3,0 m) 55 08 303830 (4,0 m) 55 08 303840 (5,0 m) 55 08 303850

No.	Replaceable elements	Catalogue No.
A	Straight gas nozzle 20x76	55 13 000610
	Conical gas nozzle 16x76* heavy duty	55 13 000617
	Conical gas nozzle 16x76	55 13 000600
	Conical gas nozzle 14x76	55 13 000615
	Spot welding gas nozzle	55 13 000613
1	M8 M38 UB3812* contact tip holder	55 13 003820
2	M38 gas diffuser, black UB5005H*	55 13 009483
2.1	401/501 gas diffuser, white	55 13 009491

No.	Replaceable elements	Catalogue No.
3	M38 UG3801* swan neck	55 13 014079
4	Connector body	55 13 013258
5	MOST torch grip MSGRIP RYG2514	55 13 006515
6	MOST trigger M15/501 UG2516	55 13 006517
7	MOST torch stiffener UG8016	55 13 006832
8	Welding cable M38 3 m	55 13 016099
8.1	Welding cable M38 4 m	55 13 016100
8.2	Welding cable M36 5 m	55 13 016101
9	MOST stiffener for euro plug M38 UC8026	55 13 006841
10	MOST euro plug connector with UPA38030EB nut	55 13 006523
11	Integrated connector	55 13 006569
12	O-ring 4x1	55 13 013962
13	Special insert nut	55 13 004300
14	Low nut M10x1	55 13 004309
15	Insulated washer 401/501	55 13 013966
B	M8x30 contact tip	(table p. 54)
C	Liners coated	(table p. 54)

* standard version



M240 SGRIP

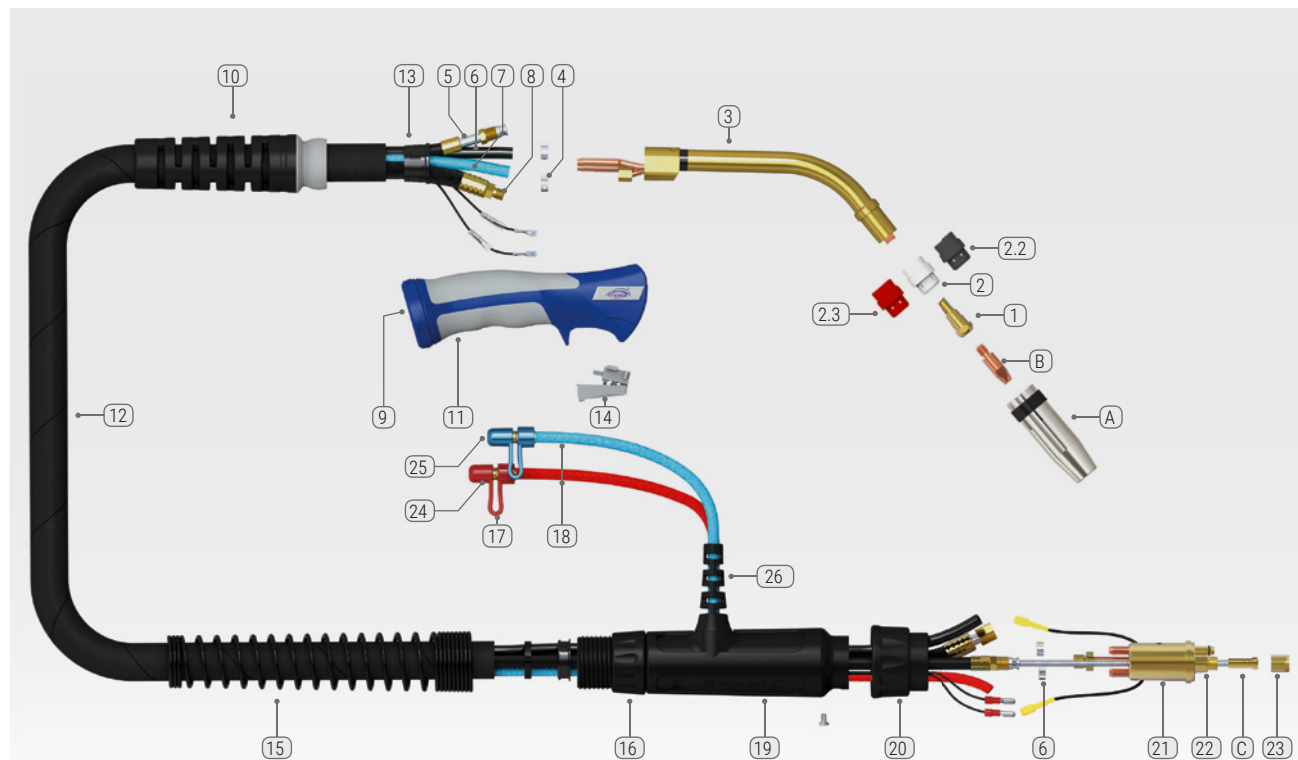

Model	M240 SGRIP
Cooling	Liquid
Technical data according to EN 60 974-7:	
▪ Rating 100% duty cycle	300 A - CO ₂ 270 A - mix M21
▪ Wire diameter	0,8-1,2 mm
Length / Catalogue No.	(3,0 m) 55 08 304243 (4,0 m) 55 08 304244 (5,0 m) 55 08 304245

No.	Replaceable elements	Catalogue No.
A	Straight gas nozzle 17x63,5 Conical gas nozzle 12,5x63,5* Conical gas nozzle 10x63,5	(3 m) 55 12 300897 (4 m) 55 12 300895 (5 m) 55 12 300896
1	M6* contact tip holder	55 13 003800
2	M-24 gas diffuser ceramic white*	55 13 009460
2.1	M-24 gas diffuser, white	55 13 009465
2.2	M-24 gas diffuser, black	55 13 009464
2.3	M-24 silicone gas diffuser	55 13 009467
3	M240 swan neck	55 13 014082
4	GER 9,5 clamp	50 15 000095
5	Insert-on cable	(3 m) 55 13 006503 (4 m) 55 13 006504 (5 m) 55 13 006505
6	Black gas pipe	55 13 015370 (m)
7	Blue hose 5x1,5	51 13 007120 (m)

No.	Replaceable elements	Catalogue No.
8	Power-water cable	(3 m) 55 13 015968 (4 m) 55 13 015969 (5 m) 55 13 015970
9	MOST torch nut UG8008	55 13 006837
10	MOST torch stiffener 401/501 UG 3208	55 13 006831
11	MOST torch grip MSGRIP UG2514/KJ/B	55 13 006515
12	External cable cover set	(3 m) 55 13 015530 (4 m) 55 13 015531 (5 m) 55 13 015532
12.1	External cable cover	51 13 007201 (m)
13	MOST rim 401/501 UG 8010	55 13 006839
14	MOST trigger M15/501 UG2516	55 13 006517
15	MOST M401/501 euro plug spring	55 13 006827
16	MOST euro plug spring nut M36/501	55 13 006828
17	Quick coupling plug ø6	50 14 182003
18	Red hose 5x15	51 13 007115
18.1	Blue hose 5x1,5	51 13 007120
19	MOST euro plug cover M401/501	55 13 006522
20	MOST euro plug nut M15/501 B1519	55 13 006519
21	Integrated water connector UB5098	55 13 006570
22	O-ring 4x1	55 13 013962
23	Special insert nut	55 13 004300
24	UBD 80310 red plug	55 13 006838
25	UBD 80320 blue plug	55 13 006840
26	Cable stiffener	55 13 006524
B	Contact tip M6x28	(table p. 54)
C	Liners	(table p. 54)

We recommend using special coolants as on page 16.

* standard version



M401 SGRIP / M501 SGRIP

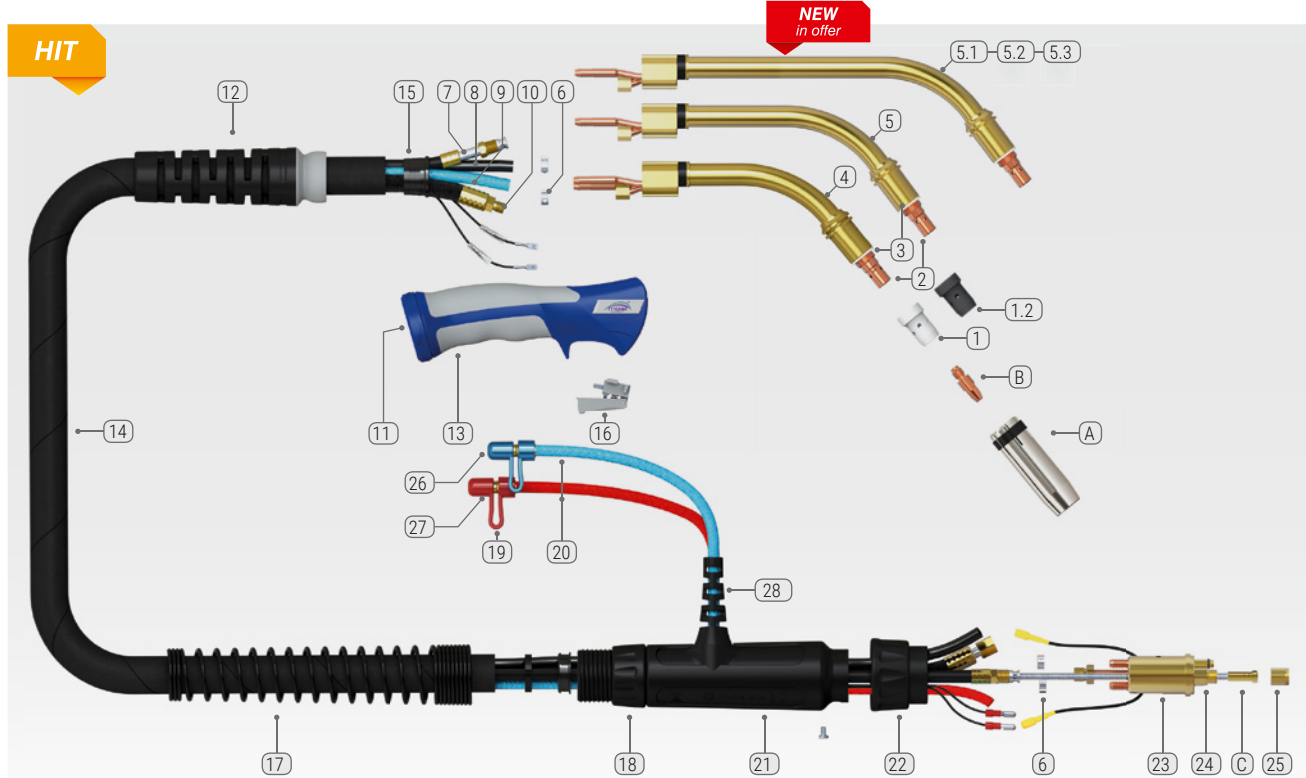

Model	M401 SGRIP	M 501 SGRIP
Cooling	Liquid	Liquid
Technical data according to EN 60 974-7:		
▪ Rating 100% duty cycle	400 A - CO ₂ 350 A - mix M21	500 A - CO ₂ 450 A - mix M21
▪ Wire diameter	0,8-1,6 mm	0,8-1,6 mm
Length / Catalogue No.	3,0 m/55 08 304013 4,0 m/55 08 304014 5,0 m/55 08 304015	3,0 m/55 08 305013 4,0 m/55 08 305014 5,0 m/55 08 305015

No.	Replaceable elements	Catalogue No.
7	Insert-on cable	(3 m) 55 13 006503 (4 m) 55 13 006504 (5 m) 55 13 006505
8	Black gas pipe	55 13 015370 (m)
9	Blue hose 5x1,5	51 13 007120 (m)
10	Power water cable	(3 m) 55 13 015968 (4 m) 55 13 015969 (5 m) 55 13 015970
11	MOST torch nut UG8008	55 13 006837
12	MOST torch stiffener 401/501 UG 3208	55 13 006831
13	MOST torch grip MSGRIP UG2514/KJ/B	55 13 006515
14	External cable cover set	(3 m) 55 13 015530 (4 m) 55 13 015531 (5 m) 55 13 015532
14.1	External cable cover	51 13 007201 (m)
15	MOST Rim 401/501 UG 8010	55 13 006830
16	MOST trigger M15/501 UG2516	55 13 006517
17	MOST euro plug spring M401/501	55 13 006827
18	MOST euro plug spring nut M36/501	55 13 006828
19	Quick coupling plug for hose Ø6	50 14 182003
20	Red hose 5x15	51 13 007115
20.1	Blue hose 5x1,5	51 13 007120
21	MOST euro plug connector M401/501	55 13 006522
22	MOST euro plug nut M15/501 B1519	55 13 006519
23	Integrated water connector UB5098	55 13 006570
24	O-ring 4x1	55 13 013962
25	Special insert nut	55 13 004300
26	UBD 80310 red plug	55 13 006838
27	UBD 80320 blue plug	55 13 006840
28	Cable stiffener	55 13 006524
B	M8x30 contact tip	(table p. 54)
C	Liners	(table p. 54)

No.	Replaceable elements	Catalogue No.
A	Straight gas nozzle 20x76 Conical gas nozzle 16x76* Conical gas nozzle 14x76 Reinforced conical gas nozzle 16x76 HD	55 13 000610 55 13 000600 55 13 000615 55 13 000617
1	401/501 gas diffuser ceramic white*	55 13 009493
1.1	401/501 gas diffuser white	55 13 009491
1.2	401/501 gas diffuser black	55 13 009498
2	M401/501 M6x25 contact tip holder	55 13 003991
2.1	M401/501 M6x29 contact tip holder	55 13 003993
2.2	M401/501 M8x25* contact tip holder	55 13 003990
2.3	M401/501 M8x29 contact tip holder	55 13 003992
3	Insulating washer M401/501	55 13 013966
4	M401 SGRIP* swan neck	55 13 014086
5	M501 SGRIP* swan neck	55 13 014096
5.1	M501L swan neck L=300 mm	55 13 01409A
5.2	M501XL swan neck L=400 mm	55 13 01409B
5.3	M501XXL swan neck L=500 mm	55 13 01409C
6	GER 9,5 clamp	50 15 000095

We recommend using special coolants as on page 16.

* standard version



AT501

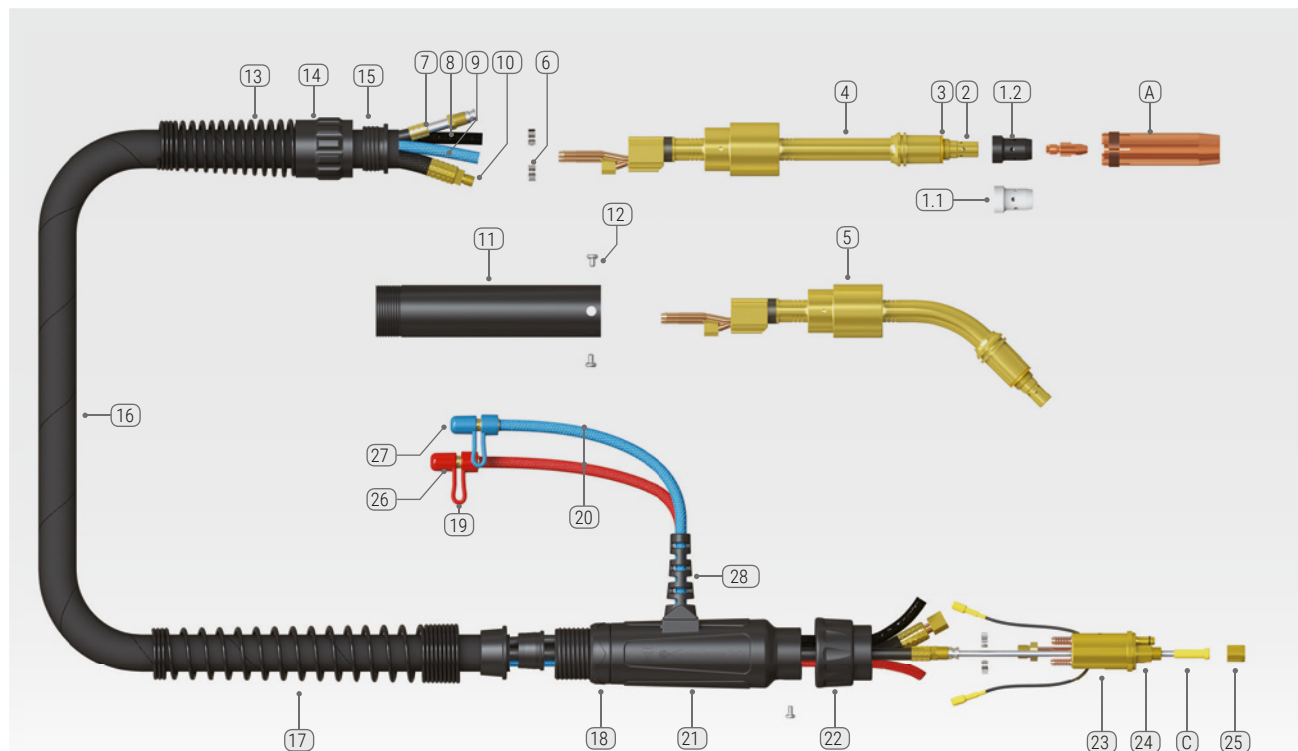

Model	AT501
Cooling	Liquid
Technical data according to EN 60 974-7:	
▪ Rating 100% duty cycle	500 A - CO ₂ 450 A - mix M21
▪ Wire diameter	0,8-1,6 mm
Length / Catalogue No.	straight - (3,0 m) 55 08 305030 45° - (3,0 m) 55 08 305035 straight - (4,0 m) 55 08 305040 45° - (4,0 m) 55 08 305045 straight - (5,0 m) 55 08 305050 45° - (4,0 m) 55 08 305055

No.	Replaceable elements	Catalogue No.
A	Straight gas nozzle 20x76 Conical gas nozzle 16x76* Conical gas nozzle 14x76 Reinforced conical gas nozzle 16x76 HD	55 13 000610 55 13 000600 55 13 000615 55 13 000617
1	401/501 gas diffuser ceramic white*	55 13 009493
1.1	401/501 gas diffuser white	55 13 009491
1.2	401/501 gas diffuser black	55 13 009498
2	M401/501 M6x25 contact tip holder	55 13 003991
2.2	M401/501 M8x25* contact tip holder	55 13 003990
3	Insulating washer M401/501	55 13 013966
4	Swan neck AT501 straight	55 13 006854
5	Swan neck AT501 45°	55 13 006855
6	GER 9,5 clamp	50 15 000095
7	Insert-on cable	(3 m) 55 13 006503 (4 m) 55 13 006504 (5 m) 55 13 006505
8	Black gas pipe	55 13 015370 (m)

No.	Replaceable elements	Catalogue No.
9	Blue hose 5x1,5	51 13 007120 (m)
10	Power-water cable	(3 m) 55 13 015968 (4 m) 55 13 015969 (5 m) 55 13 015970
11	AT501 UB3630 handle grip	55 13 006850
12	AT501 UB3629 handle screw	55 13 006851
13	AT501 UB8017A handle spring	55 13 006853
14	AT501 UB8030A power nut spring	55 13 006852
15	AT501 PB8110A spring nut	55 13 006849
16	External cable cover set	(3 m) 55 13 015530 (4 m) 55 13 015531 (5 m) 55 13 015532
16.1	External cable cover	55 13 007201 (m)
17	MOST M401/501 euro plug spring	55 13 006827
18	MOST euro plug spring nut M36/501	55 13 006828
19	Quick coupling plug Ø6	50 14 182003
20	Red hose 5x1,5	51 13 007115
20.1	Blue hose 5x1,5	51 13 007120
21	MOST euro plug connector M401/501	55 13 006522
22	MOST euro plug nut M15/501 B1519	55 13 006519
23	Integrated water connector UB5098	55 13 006570
24	O-ring 4x1	55 13 013962
25	Special insert nut	55 13 004300
26	UBD 80310 red plug	55 13 006838
27	UBD 80320 blue plug	55 13 006840
28	Cable stiffener	55 13 006524
B	Contact tip M8x30	(table p. 54)
C	Liners	(table p. 54)

We recommend using special coolants as on page 16.

* standard version



M1 MOST MIG/MAG

Modern, lightweight

NEW
in offer

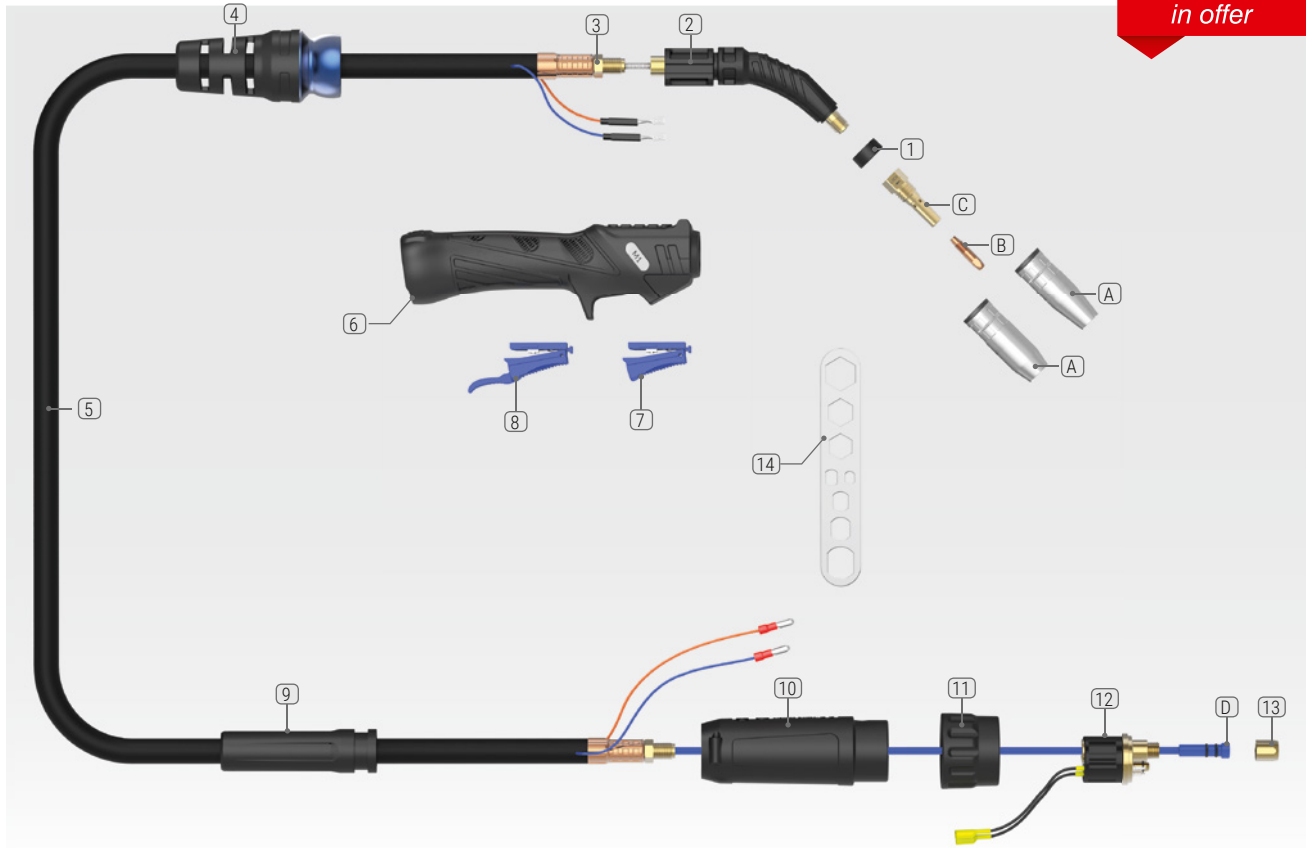

Model	M1
Cooling	Gas
Technical data according to EN 60 974-7:	
▪ Rating 60% duty cycle	180 A - CO ₂ 150 A - mix M21
▪ Wire diameter	0,6-1,0 mm
Length / Catalogue No.	(3,0 m) 55 08 305080 (4,0 m) 55 08 305081 (5,0 m) 55 08 305082

Contact tips M1 M6	
Wire diameter	Catalogue No.
M1 M6 0,6 mm	55 13 003280
M1 M6 0,8 mm	55 13 003281
M1 M6 1,0 mm	55 13 003282
M1 M6 1,2 mm	55 13 003283
M1 M6 1,0 mm AL	55 13 003285
M1 M6 1,2 mm AL	55 13 003286
Applicable of the torch type	M1

No.	Replaceable elements	Catalogue No.
A	Conical nozzle M1 Ø12 Conical nozzle M1 Ø10,5	55 13 000730 55 13 000731
B	Contact tip M1 M6	see table 1
C	Contact tip holder M1	55 13 003873
D	Wire liner	see table 2
1	Insulator M1	55 13 003870
2	Swanneck M1	55 13 014570
3	Lock nut	55 13 004309
4	Cable support	55 13 006872
5	Outer liner assembly M1 3 m Outer liner assembly M1 4 m Outer liner assembly M1 5 m	55 13 016102 55 13 016103 55 13 016104
6	Handle	55 13 006661
7	Microswitch standard trigger assembly	55 13 006675
8	Microswitch extended trigger assembly	55 13 006676
9	Cable support	55 13 006835
10	Housing assembly	55 13 006689
11	Gun plug nut	55 13 006519
12	Euro plug 2	55 13 006696
13	Liner retaining nut	55 13 006695
14	Wear parts spanner	55 13 006685

Table 1. Contact tip for M1 MOST torch

Wire liners	Catalogue No.
Steel liner 0,6-0,9 mm M1/M22 blue 3 m AM1535-30	55 13 012770
Steel liner 0,6-0,9 mm M1/M22 blue 4 m AM1535-40	55 13 012771
Steel liner 0,6-0,9 mm M1/M22 blue 5 m AM1535-50	55 13 012772
Steel liner 1,0-1,2 mm M1/M22 red 3 m AM2524-30	55 13 012783
Steel liner 1,0-1,2 mm M1/M22 red 4 m AM2524-40	55 13 012784
Steel liner 1,0-1,2 mm M1/M22 red 5 m AM2524-50	55 13 012785
Graphite 1,0-1,2 mm M1/M22 3 m AM1564-30	55 13 012786
Graphite 1,0-1,2 mm M1/M22 4 m AM1564-40	55 13 012787
Graphite 1,0-1,2 mm M1/M22 5 m AM1564-50	55 13 012788

Table 2. Wire liners for M1, M22 and M22M MOST torch



M22 MOST MIG/MAG

Modern, lightweight

NEW
in offer

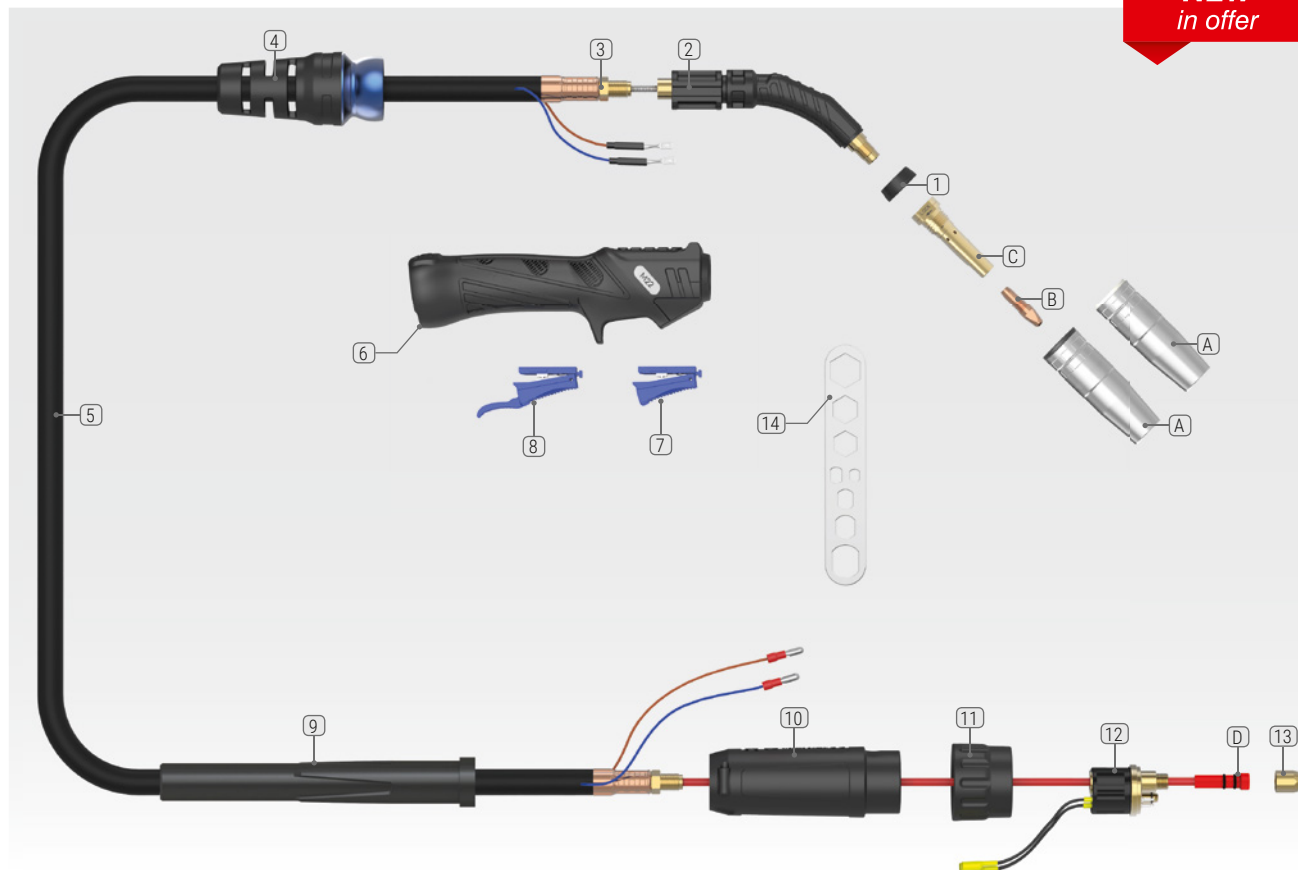

Model	M22
Cooling	Gas
Technical data according to EN 60 974-7:	
▪ Rating 60% duty cycle	250 A - CO ₂ 220 A - mix M21
▪ Wire diameter	0,8-1,2 mm
Length / Catalogue No.	(3 m) 55 08 305090 (4 m) 55 08 305091 (5 m) 55 08 305092

Contact tips M2 M8	
Wire diameter	Catalogue No.
M2 M8 0,8 mm	55 13 003288
M2 M8 1,0 mm	55 13 003289
M2 M8 1,2 mm	55 13 003290
M2 M8 1,0 mm AL	55 13 003291
M2 M8 1,2 mm AL	55 13 003292
Applicable of the torch type	M22 M22M

Table 1. Contact tip for M22 and M22M MOST torch

Wire liners	Catalogue No.
Steel liner 0,6-0,9 mm M1/M22 blue 3 m AM1535-30	55 13 012770
Steel liner 0,6-0,9 mm M1/M22 blue 4 m AM1535-40	55 13 012771
Steel liner 0,6-0,9 mm M1/M22 blue 5 m AM1535-50	55 13 012772
Steel liner 1,0-1,2 mm M1/M22 red 3 m AM2524-30	55 13 012783
Steel liner 1,0-1,2 mm M1/M22 red 4 m AM2524-40	55 13 012784
Steel liner 1,0-1,2 mm M1/M22 red 5 m AM2524-50	55 13 012785
Graphite 1,0-1,2 mm M1/M22 3 m AM1564-30	55 13 012786
Graphite 1,0-1,2 mm M1/M22 4 m AM1564-40	55 13 012787
Graphite 1,0-1,2 mm M1/M22 5 m AM1564-50	55 13 012788

Table 2. Wire liners for M1, M22 and M22M MOST torch

No.	Replaceable elements	Catalogue No.
A	Conical nozzle M22 Ø16 Conical nozzle M22 Ø14	55 13 000734 55 13 000735
B	Contact tip	see table 1
C	Contact tip holder M22	55 13 003875
D	Wire liner	see table 2
1	Insulator M22	55 13 003871
2	Swanneck M2	55 13 014572
3	Lock nut	55 13 004309
4	Cable support	55 13 006872
5	Power cable assembly M22 3 m Power cable assembly M22 4 m Power cable assembly M22 5 m	55 13 016108 55 13 016109 55 13 016110
6	Handle M1/M22	55 13 006661
7	Microswitch standard trigger assembly	55 13 006675
8	Microswitch extended trigger assembly	55 13 006676
9	Cable support	55 13 006836
10	Housing assembly	55 13 006689
11	Gun plug nut	55 13 006519
12	Euro plug	55 13 006696
13	Liner retaining nut	55 13 006695
14	Wear parts spanner	55 13 006685



M22M MOST MIG/MAG

Modern, lightweight, rotary swan neck

NEW
in offer

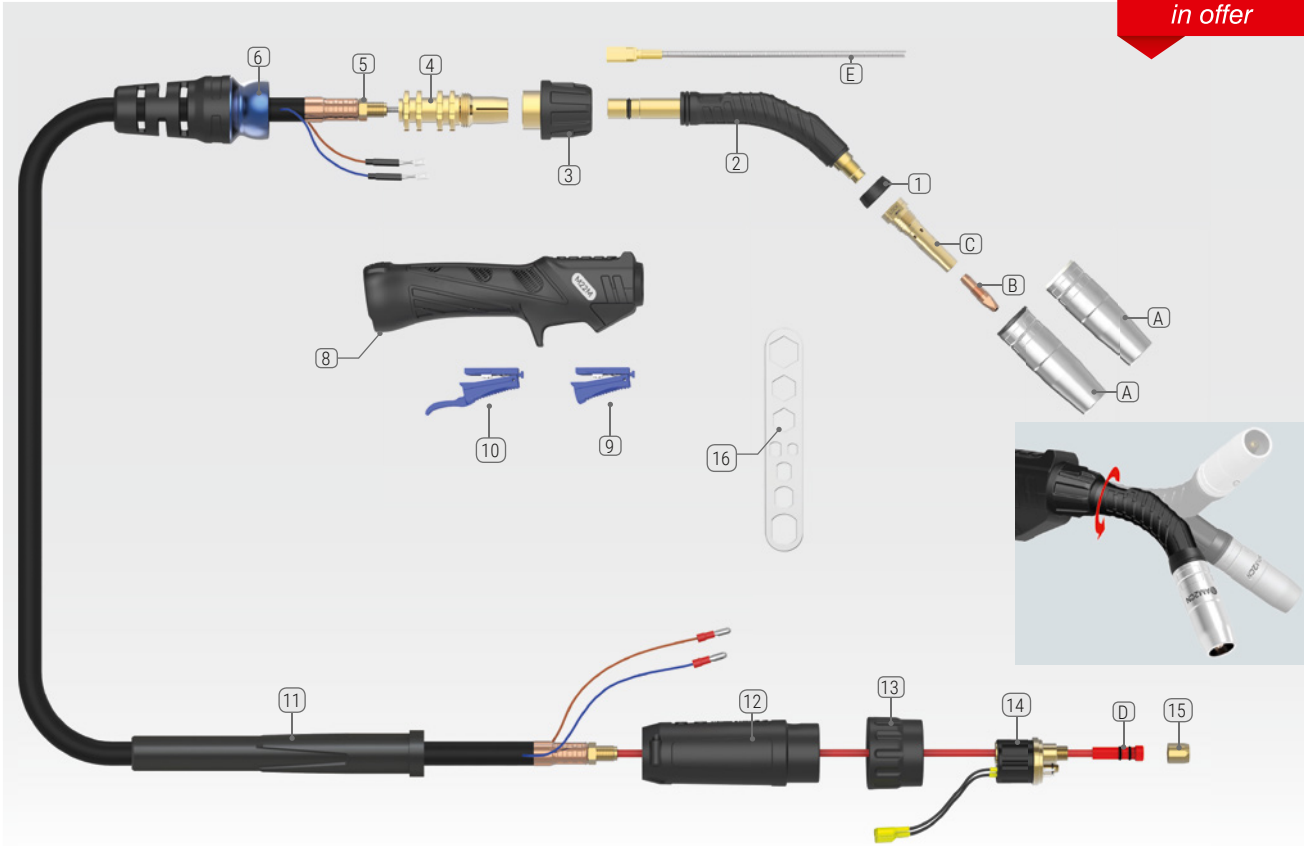

Model	M22M
Cooling	Gas
Technical data according to EN 60 974-7:	
▪ Rating 60% duty cycle	250 A - CO ₂ 220 A - mix M21
▪ Wire diameter	0,8-1,2 mm
Length / Catalogue No.	(3 m) 55 08 305095 (4 m) 55 08 305096 (5 m) 55 08 305097

Neck jump liner	Catalogue No.
M22M 0,8-1,2 Neck jump liner standard AM22MJL	55 13 012789
M22M 0,8-1,2 Neck jump liner brass AM22MJL-B	55 13 012790

Table 3. Neck jump liner for M22M MOST

Contact tips M2 M8	
Wire diameter	Catalogue No.
M2 M8 0,8 mm	55 13 003288
M2 M8 1,0 mm	55 13 003289
M2 M8 1,2 mm	55 13 003290
M2 M8 1,0 mm AL	55 13 003291
M2 M8 1,2 mm AL	55 13 003292
Applicable of the torch type	M22 M22M

Table 1. Contact tip for M22 and M22M MOST torch

No.	Replaceable elements	Catalogue No.
A	Conical nozzle M22 Ø16 Conical nozzle M22 Ø14	55 13 000734 55 13 000735
B	Contact tip	see table 1
C	Contact tip holder M22	55 13 003875
D	Wire liner	see table 2
E	Liner	see table 3
1	Insulator M22	55 13 003871
2	Swanneck M22M	55 13 014573
3	Neck nut M22M	55 13 014574
4	Socket connection part M22M	55 13 014575
5	Lock nut	55 13 004309
6	Cable support	55 13 006872
7	Power cable assembly M22 3 m Power cable assembly M22 4 m Power cable assembly M22 5 m	55 13 016108 55 13 016109 55 13 016110
8	Handle	55 13 006661
9	Microswitch standard trigger assembly	55 13 006675
10	Microswitch extended trigger assembly	55 13 006676
11	Cable support	55 13 006836
12	Housing assembly	55 13 006689
13	Gun plug nut	55 13 006519
14	Euro plug 2	55 13 006696
15	Liner retaining nut	55 13 006695
16	Wear parts spanner	55 13 006685

Wire liners	Catalogue No.
Steel liner 0,6-0,9 mm M1/M22 blue 3 m AM1535-30	55 13 012770
Steel liner 0,6-0,9 mm M1/M22 blue 4 m AM1535-40	55 13 012771
Steel liner 0,6-0,9 mm M1/M22 blue 5 m AM1535-50	55 13 012772
Steel liner 1,0-1,2 mm M1/M22 red 3 m AM2524-30	55 13 012783
Steel liner 1,0-1,2 mm M1/M22 red 4 m AM2524-40	55 13 012784
Steel liner 1,0-1,2 mm M1/M22 red 5 m AM2524-50	55 13 012785
Graphite 1,0-1,2 mm M1/M22 3 m AM1564-30	55 13 012786
Graphite 1,0-1,2 mm M1/M22 4 m AM1564-40	55 13 012787
Graphite 1,0-1,2 mm M1/M22 5 m AM1564-50	55 13 012788

Table 2. Wire liners for M1, M22 and M22M MOST torch



Scan the link or go to
<https://www.rywa.eu/f01-15>

M6W

Modern MIG/MAG welding torch for high-performance welding, especially using with pulse current

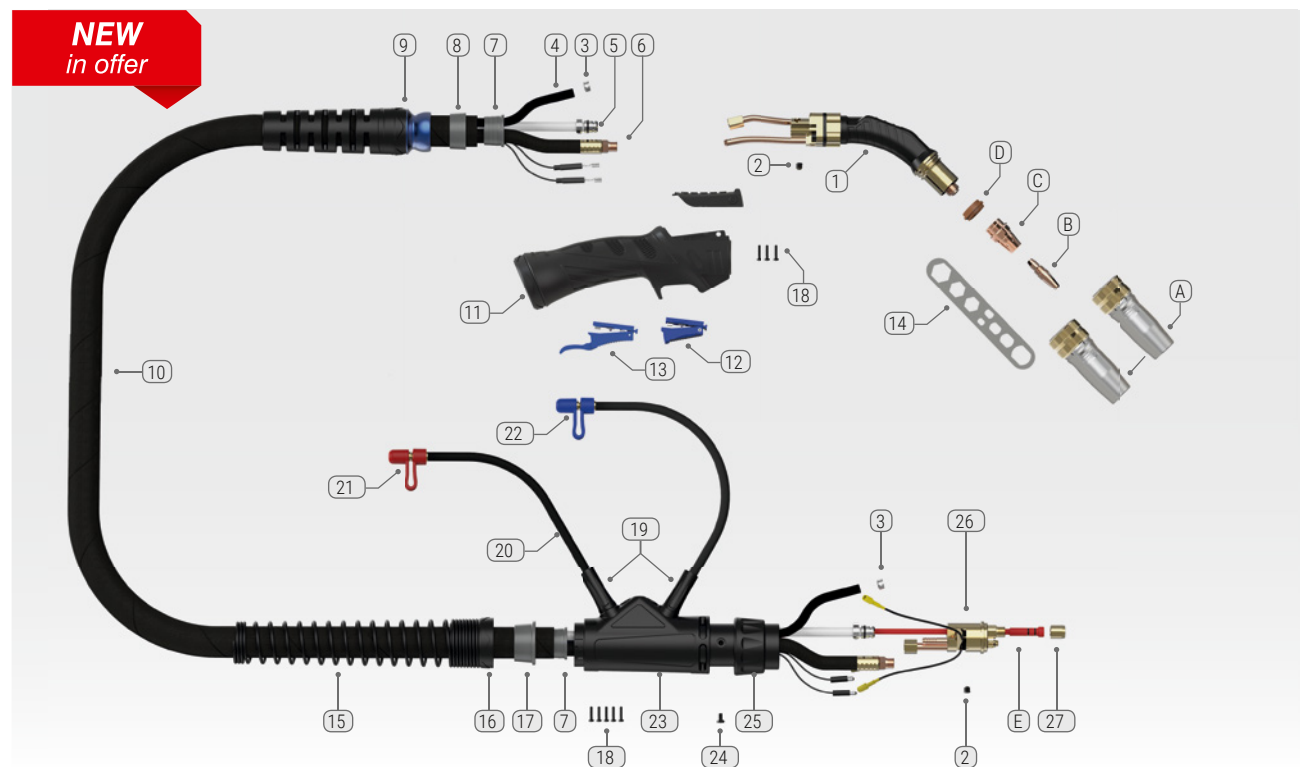

M60SW

Modern MIG/MAG welding torch for aluminium and CuSi wires

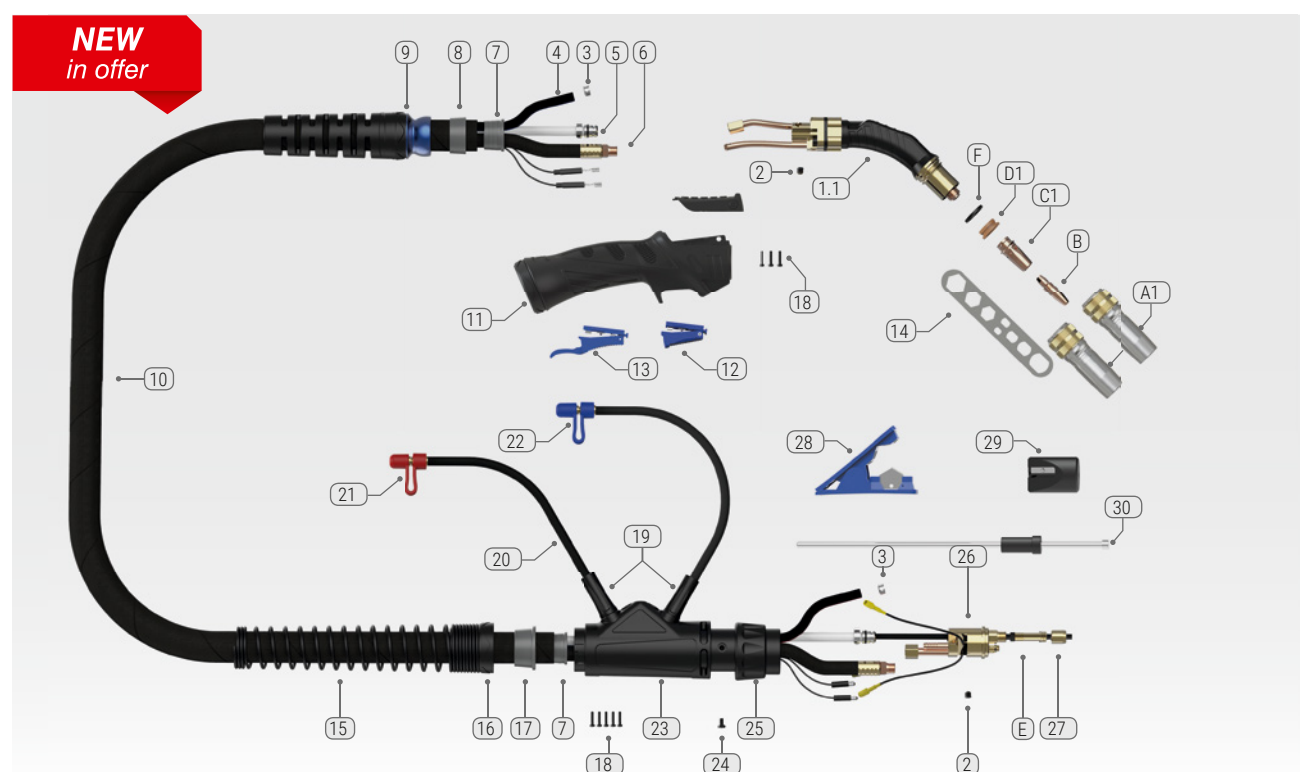

M6W / M6OSW

Model		M6W		M6OSW	
Cooling		Liquid		Liquid	
Rating		Max. A	Pulse	Max. A	Pulse
CO ₂	at 1.6 kW cooler	580 A	380 A	580 A	380 A
	at 1.2 kW cooler	530 A	350 A	530 A	350 A
MIX	at 1.6 kW cooler	530 A	380 A	530 A	380 A
	at 1.2 kW cooler	480 A	350 A	480 A	350 A
Min. coolant inlet pressure		3,0 bar		3,0 bar	
Minimum liquid flow		1,5 l/min		1,5 l/min	
Duty cycle		100%		100%	
Wire diameter		0,8-2,0 mm		0,8-2,0 mm	
Gas flow		8-20 l/min		8-20 l/min	
Length / Catalogue No.		(3 m) 55 08 305113 (4 m) 55 08 305114 (5 m) 55 08 305115		(3 m) 55 08 305123 (4 m) 55 08 305124	

No.	Replaceable elements	Catalogue No.
A	M6W conical gas nozzle Ø16*	55 13 000740
	M6W conical gas nozzle Ø14	55 13 000741
A1	M6OSW conical gas nozzle Ø15*	55 13 000750
	M6OSW conical gas nozzle Ø13	55 13 000751
B	M10x35,5 contact tip	(see the table below)
C	M6W 28,5 mm* contact tip holder	55 13 003984
C1	M6OSW 32,5 mm contact tip holder	55 13 003987
D	M6W insulator	55 13 003980
D1	M6OSW insulator	55 13 003981
E	Liner	(see the table below)
F	O-ring	55 13 003982
1	M6W 45° swan neck	55 13 014550
1.1	M6OSW 45° swan neck	55 13 014560
2	M6x6 screw set	55 13 006884
3	GER 8,7 clamp	50 15 000087
4	Blue hose 5x1,5	51 13 007120
5	Cable for M6W insert 3 m	55 13 006403
	Cable for M6W insert 4 m	55 13 006404
	Cable for M6W insert 5 m	55 13 006405
6	Power-water cable M6W 3 m	55 13 006413
	Power-water cable M6W 4 m	55 13 006414
	Power-water cable M6W 5 m	55 13 006415
7	Hoop	55 13 006830
8	Sheath block	55 13 006848
9	M6W torch stiffener	55 13 006831

No.	Replaceable elements	Catalogue No.
10	M6W cable cover set 3 m	55 13 006423
	M6W cable cover set 4 m	55 13 006424
	M6W cable cover set 5 m	55 13 006425
	External cable cover (m)	55 13 007201
11	M6W handle	55 13 006660
12	M6W standard trigger	55 13 006675
13	M6W long trigger	55 13 006676
14	M6W key	55 13 006685
15	M6W euro plug spring	55 13 006827
16	Euro plug spring nut	55 13 006680
17	Euro plug inner ring	55 13 006681
18	Screw set	55 13 006684
19	Exit to a hose	55 13 006686
20	Red hose 5x1,5	51 13 007115
21	Red hose plug	55 13 006838
22	Blue hose plug	55 13 006840
23	M6W euro plug housing	55 13 006688
24	M4x0,7 screw	55 13 006683
25	M6W euro plug nut	55 13 006519
26	Euro plug	55 13 006687
27	Special insert nut	55 13 006695
28	Insert cutter	55 13 006690
29	Cartridge sharpener	55 13 006691
30	Cartridge positioner	55 13 006692

M10x35,5 contact tip		
Wire diameter		Catalogue No.
0,8 mm M10x35,5 CuCrZr		55 13 003260
1,0 mm M10x35,5 CuCrZr		55 13 003262
1,2 mm M10x35,5 CuCrZr		55 13 003263
1,4 mm M10x35,5 CuCrZr		55 13 003264
1,6 mm M10x35,5 CuCrZr		55 13 003265
0,8 mm Al M10x35,5 CuCrZr		55 13 003270
1,0 mm Al M10x35,5 CuCrZr		55 13 003271
1,2 mm Al M10x35,5 CuCrZr		55 13 003272
1,6 mm Al M10x35,5 CuCrZr		55 13 003274
Applicable to welding torch	■ M6W ■ M6OSW	

Wire guides (Liners)	Catalogue No.
Steel 1,0-1,2 red / 3 m	55 13 012800
Steel 1,0-1,2 red / 4 m	55 13 012801
Steel 1,0-1,2 red / 5 m	55 13 012802
Steel 1,6 yellow / 3 m	55 13 012810
Steel 1,6 yellow / 4 m	55 13 012811
Steel 1,6 yellow / 5 m	55 13 012812
Graphite 1,0-1,2 / 3 m	55 13 012820
Graphite 1,0-1,2 / 4 m	55 13 012821
Graphite 1,0-1,2 / 5 m	55 13 012822
For aluminium wire 1,0-1,2 / 3 m	55 13 012823
For aluminium wire 1,0-1,2 / 4 m	55 13 012824
For aluminium wire 1,6 / 3 m	55 13 012825
For aluminium wire 1,6 / 4 m	55 13 012826



▼ 8.2. Contact tips for MIG/MAG welding torches

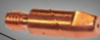

Tip size  Wire diameter	M6x25 (M6 narrow)	M6x28 (M6 thick)	M8x30	M6x25 (M6 narrow)	M6x28 (M6 thick)	M8x30
	Catalogue No.			Catalogue No. Abicor Binzel		
0,6 mm	55 13 002150	-	-	140.0008	140.0005	-
0,8 mm	55 13 002170	55 13 002180	55 13 002250	140.0059	140.0051	140.0114
1,0 mm	55 13 002320	55 13 002330	55 13 002340	140.0253	140.0242	140.0313
1,2 mm	55 13 002470	55 13 002480	55 13 002490	140.0387	140.0379	140.0442
1,4 mm	-	55 13 002610	55 13 002600	-	140.0516	140.0533
1,6 mm	55 13 002720	55 13 002730	55 13 002800	-	140.0555	140.0587
0,6 mm CuCrZr	-	-	-	140.0855	140.0998	-
0,8 mm CuCrZr	55 13 002171	55 13 002190	55 13 002251	140.0062	140.0054	140.0117
1,0 mm CuCrZr	55 13 002321	55 13 002331	55 13 002341	140.0256	140.0245	140.0316
1,2 mm CuCrZr	55 13 002473	55 13 002482	55 13 002491	140.0390	140.0382	140.0445
1,4 mm CuCrZr	-	-	55 13 002602	-	140.0519	140.0536
1,6 mm CuCrZr	-	55 13 002731	55 13 002801	-	140.0558	140.0590
0,8 mm Al	55 13 002172	55 13 002210	55 13 002253	141.0002	141.0001	141.0003
1,0 mm Al	55 13 002324	55 13 002335	55 13 002365	141.0007	141.0006	141.0008
1,2 mm Al	55 13 002475	55 13 002484	55 13 002493	141.0011	141.0010	141.0015
1,6 mm Al	55 13 002726	55 13 002732	55 13 002808	-	141.0020	141.0022
Applicable to welding torch	<ul style="list-style-type: none"> ▪ MOST M15 ▪ MB-15 ▪ Abimig 155 	<ul style="list-style-type: none"> ▪ MOST M24/M25 ▪ MOST M36/M240 ▪ MB-24/MB-25 ▪ MB-36/MB-240D ▪ Abimig 255 	<ul style="list-style-type: none"> ▪ MOST M401/M501 ▪ MOST M38 ▪ MB-401D/MB-501D ▪ Abimig 305/355/405 	<ul style="list-style-type: none"> ▪ Abimig 155 ▪ MB 15 	<ul style="list-style-type: none"> ▪ Abimig 255 ▪ MB-24/MB-25 ▪ MB-36/MB-240D 	<ul style="list-style-type: none"> ▪ Abimig 305/355/405 ▪ MB-401D ▪ MB-501D

▼ 8.3. Liners for MIG/MAG welding torches

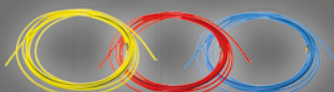

Insert Size	3,0 m	4,0 m	5,0 m	3,0 m	4,0 m	5,0 m
Spiral for steel wires	coated			uncoated		
0,8 mm	55 13 012390*	55 13 012400*	55 13 012402*	55 13 012390	55 13 012400	55 13 012402
1,0 mm	55 13 012440**	55 13 012470**	55 13 012480**	55 13 012490	55 13 012500	55 13 012505
1,2 mm	55 13 012440**	55 13 012470**	55 13 012480**	55 13 012490	55 13 012500	55 13 012505
1,6 mm	55 13 012510***	55 13 012530***	55 13 012541***	55 13 012570	55 13 012573	55 13 012575
Teflon for aluminium wires or stainless steel						
0,8 mm	55 13 012120*	55 13 012170*	55 13 012175*	55 13 012120*	55 13 012170*	55 13 012175*
1,0 mm	55 13 012205**	55 13 012206**	55 13 012207**	55 13 012205**	55 13 012206**	55 13 012207**
1,2 mm	55 13 012205**	55 13 012206**	55 13 012207**	55 13 012205**	55 13 012206**	55 13 012207**
1,6 mm	55 13 012210***	55 13 012212***	55 13 012214***	55 13 012210***	55 13 012212***	55 13 012214***
1,0-1,2 mm graphite-teflon with brass spiral	55 13 013010	55 13 013020	55 13 013030	55 13 013010	55 13 013020	55 13 013030
Applicable torch type	<ul style="list-style-type: none"> ▪ MOST M15/M24/M25/M36/M38 ▪ MB-15AK/MB-24KD/MB-25AK/MB-36KD/GRIP ALW 			<ul style="list-style-type: none"> ▪ MOST M401/M501 ▪ MB-240D/MB-401D/MB-501D 		

* blue / ** red / *** yellow

▼ 8.4. Replacement parts for MIG/MAG KEMPPI torches

Parts compatible with KEMPPI welding torches:

PMT/MMT 25; KMG 17/20/25; MT 18/25; MMG 18/20/22; FE 20/25

No.	Replaceable elements	Cat. no.	Ref. no.
1	45° swan neck	55 42 000700	4153040
2	Nozzle spring	55 42 000599	4275240
3	Insulating ring	55 42 000561	9591079
4	M6 contact tip holder	55 42 000500	9580173
5	Insulating sleeve	55 42 000560	9591010
6	M8x28 contact tip	table below	
7	Gas nozzle Ø14 L=60,5 mm	55 42 000400	9580101
8	Gas nozzle Ø14 L=60,5 mm thickened wall	55 42 000401	9580101E

Parts compatible with KEMPPI welding torches:

PMT 27/32; MMT 27/32; FE 27/32; PMT 30W; MMT 30W; WS 30W

No.	Replaceable elements	Cat. no.	Ref. no.
1	50° swan neck 27/32	55 42 000704	3146780
2	Gas diffuser 27/32/30W	55 42 000570	4294880
3	Ceramic gas diffuser 27/32/30W	55 42 000571	4294880CER
4	M6 27/32/30W contact tip holder	55 42 000505	4294890
5	M8 27/32/30W contact tip holder	55 42 000510	4295740
6	Contact tip M6x28 27/32/30W	table below	
7	Contact tip M8x35 27/32/30W	table below	
8	Gas nozzle Ø14 L=70 mm M6 27/32/30W	55 42 000413	4294970
9	Gas nozzle Ø14 L=76 mm 27/32/30W	55 42 000410	4295760
10	Gas nozzle Ø12 L=76 mm conical 27/32/30W	55 42 000412	4295760C
11	Gas nozzle Ø14 L=79 mm 27/32/30W	55 42 000411	4295760L

Liners	3 m		4,5 m	
	Cat. no.	Ref. no.	Cat. no.	Ref. no.
Spiral white Ø0,6-0,8 mm	55 42 000606	4188571	55 42 000607	4188572
Spiral red Ø0,9-1,2 mm	55 42 000600	4188581	55 42 000601	4188582
Spiral yellow Ø1,6 mm	55 42 000604	4188591	55 42 000605	4188592
Teflon blue	55 42 000608		55 42 000609	
Teflon red Ø0,9-1,2 mm	55 42 000610		55 42 000611	

Wire diameter	M6x28		M8x35	
	Cat. no.	Ref. no.	Cat. no.	Ref. no.
0,8 mm	55 13 002180	9876635	55 42 000100	9580122
1,0 mm	55 13 002330	9876636	55 42 000101	9580123
1,2 mm	55 13 002480	9876637	55 42 000102	9580124
1,6 mm	55 13 002730	9876639	55 42 000104	9580126
0,8 mm CuCrZr	55 13 002710		55 42 000300	9580122ZR
1,0 mm CuCrZr	55 13 002331		55 42 000301	9580123ZR
1,2 mm CuCrZr	55 13 002482		55 42 000302	9580124ZR
1,6 mm CuCrZr	55 13 002731		55 42 000304	9580126ZR
0,8 mm Al			55 42 000200	9580122A
1,0 mm Al			55 42 000201	9580123A
1,2 mm Al			55 42 000202	9580124A
1,6 mm Al			55 42 000204	9580126A

The pictures above show replacement products manufactured for RYWAL-RHC. Presented alternatives to parts of KEMPPI torches are not the original parts. Names and reference numbers of KEMPPI torches and spare parts were provided to inform about the intended application of the offered replacement parts.

Parts compatible with KEMPPi welding torches: PMT 35; MMT 35; PMT 42W; MMT 42W

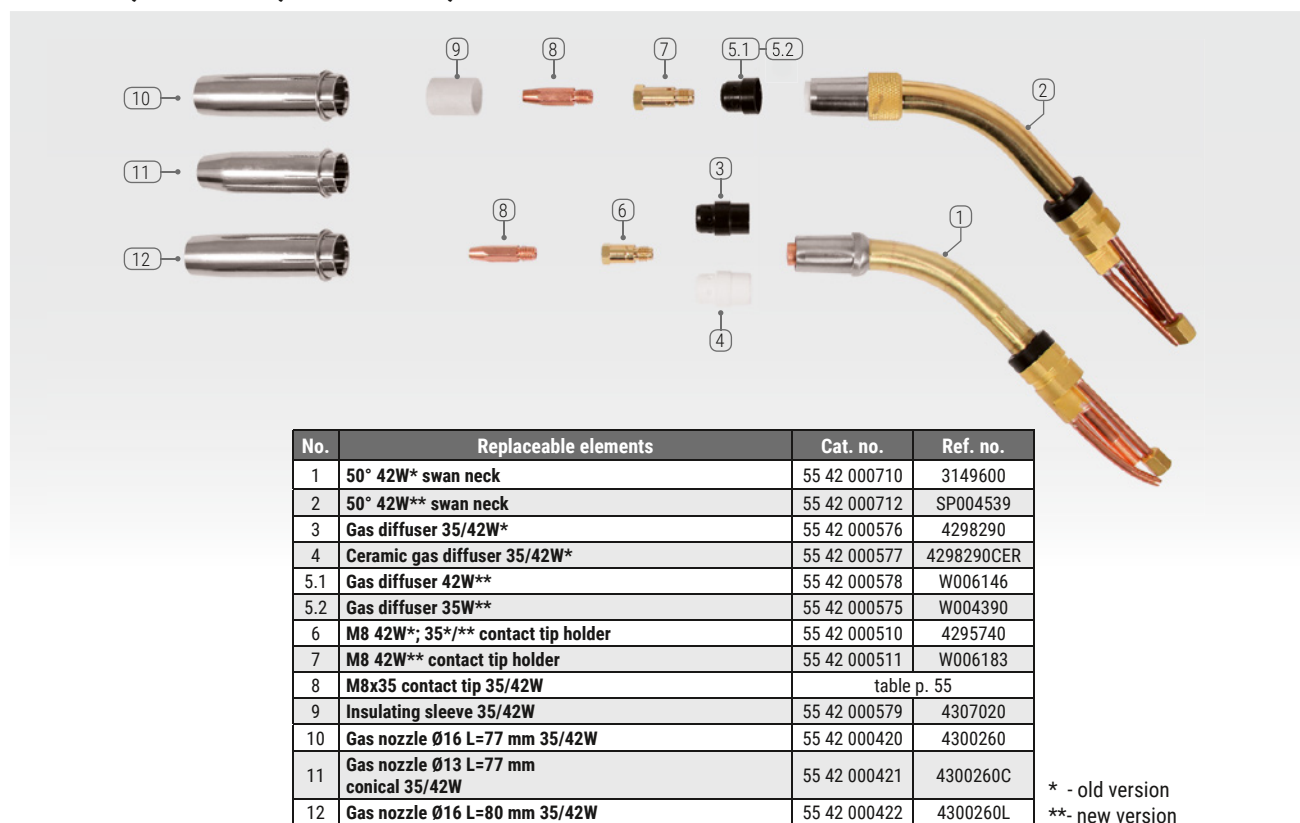

Parts compatible with KEMPPi welding torches: PMT 42, MMT 42, PMT 52W, MMT 52W

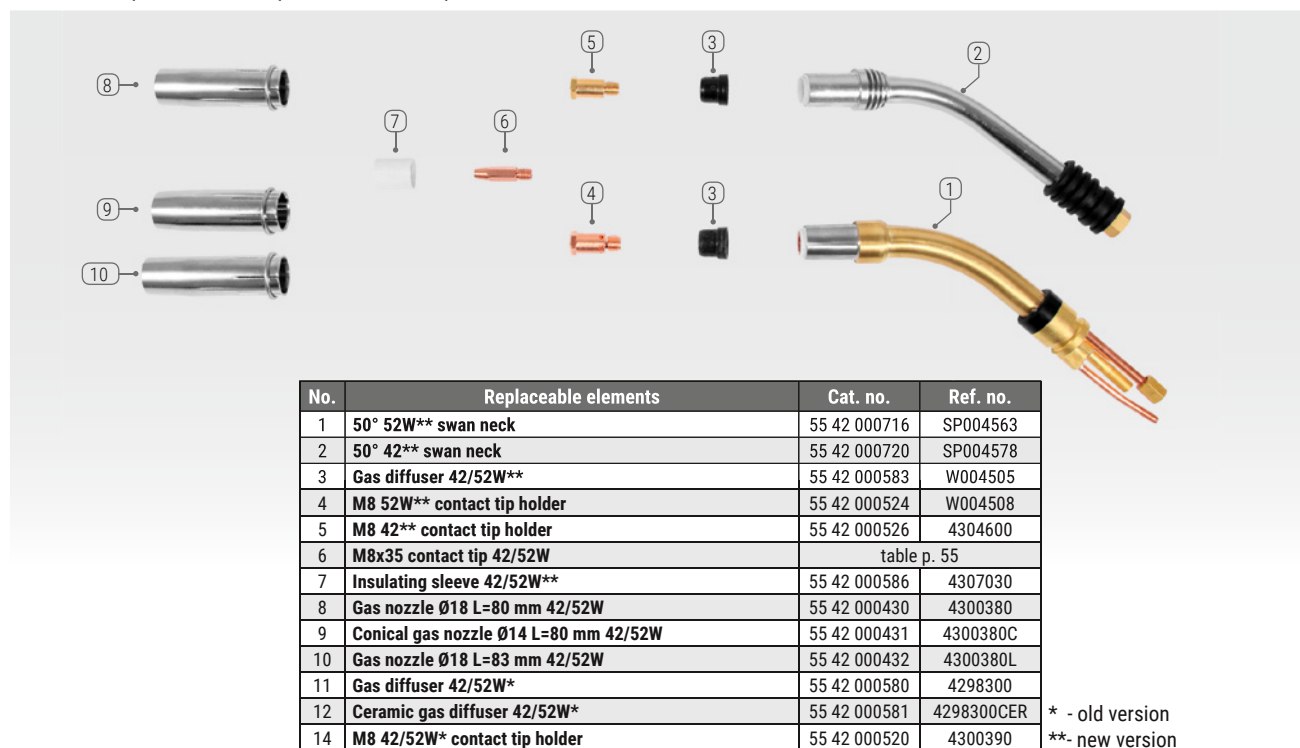

The pictures above show replacement products manufactured for RYWAL-RHC. Presented alternatives to parts of KEMPPi torches are not the original parts. Names and reference numbers of KEMPPi torches and spare parts were provided to inform about the intended application of the offered replacement parts.

Parts compatible with KEMPPI welding torches:

GX203G35, GX203G5, GX303W35, GX303W5, GX205G35, GX205G5, GX305W35, GX305W5, GX305WS6

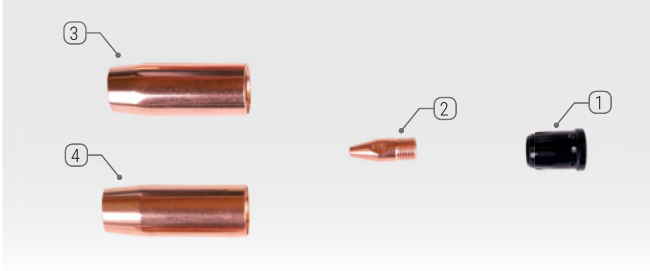

No.	Replaceable elements	Cat. no.	Ref. no.
1	Contact tip adapter M10 insulated	55 42 000890	W013203
2	Contact tip M10	table below 1	
3	Gas nozzle Ø 14 L=57/22	55 42 000850	W014452
4	Gas nozzle Ø 15 L=60/22	55 42 000851	W015858

Parts compatible with KEMPPI welding torches:

GX303G35, GX303G5, GX403W35, GX428W5, GX403W5, GX305G35, GX305G5, GX305GS6, GX305GS8, GX405W35, GX405W5, GX405WS6, GX405WS8, GX305GMN35, GX305GMN5, GX208GMN35, GX208GMN5, GX308GMN35, GX308GMN5, GX428W35

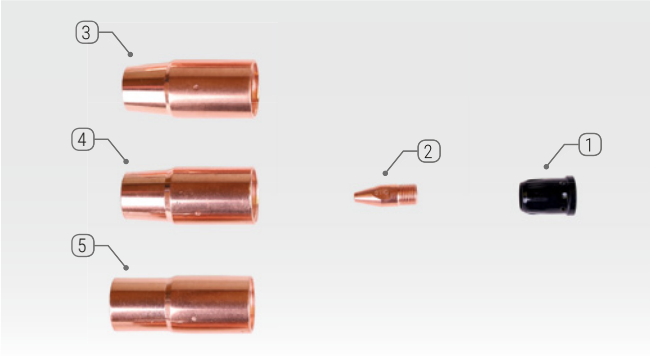

No.	Replaceable elements	Cat. no.	Ref. no.
1	Contact tip adapter M10 insulated	55 42 000890	W013203
2	Contact tip M10	table below 1	
3	Gas nozzle Ø 15 L=57/25	55 42 000860	W011478
4	Gas nozzle Ø 16 L=61/25	55 42 000861	W013930
5	Gas nozzle Ø 19 L=61/25	55 42 000862	W012143

Parts compatible with KEMPPI welding torches:

GX403G35, GX403G5, GX503W35, GX503W5, GX405G35, GX405G5, GX505W35, GX505W5, GX408GMN35, GX408GMN5, GX528W35, GX528W5

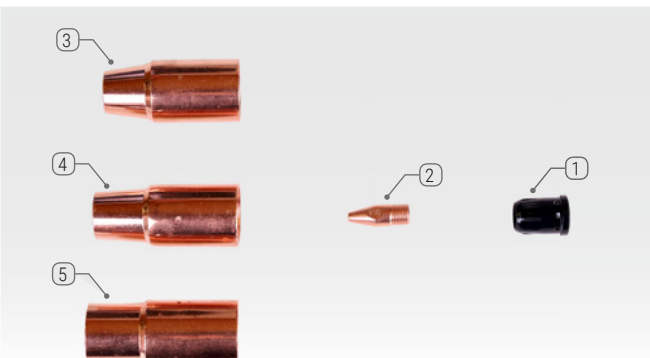

No.	Replaceable elements	Cat. no.	Ref. no.
1	Contact tip adapter M10 insulated	55 42 000890	W013203
2	Contact tip M10	table below 1	
3	Gas nozzle Ø 15 L=60/28	55 42 000870	W011472
4	Gas nozzle Ø 17 L=64/28	55 42 000871	W013931
5	Gas nozzle Ø 21 L=64/28	55 42 000872	W012146

Contact tip Wire diameter	M10x28		M10x28 CuCrZr	
	Cat. no.	Ref. no.	Cat. no.	Ref. no.
0,8 mm	55 42 000800	CT08C1SD001	55 42 000820	CT08C1CZ001
1,0 mm	55 42 000801	CT10C1SD001	55 42 000821	CT10C1CZ001
1,2 mm	55 42 000802	CT12C1SD001	55 42 000822	CT12C1CZ001
1,4 mm	55 42 000803	CT14C1SD001	55 42 000823	CT14C1CZ001
1,6 mm	55 42 000804	CT14C1SD001	55 42 000824	CT14C1CZ001

Table 1: Contact tip

The pictures above show replacement products manufactured for RYWAL-RHC. Presented alternatives to parts of KEMPPI torches are not the original parts. Names and reference numbers of KEMPPI torches and spare parts were provided to inform about the intended application of the offered replacement parts.

▼ 8.5. Replacement parts for MIG/MAG FRONIUS torches

Parts compatible with FRONIUS welding torches: AL 2300 / AW 2500

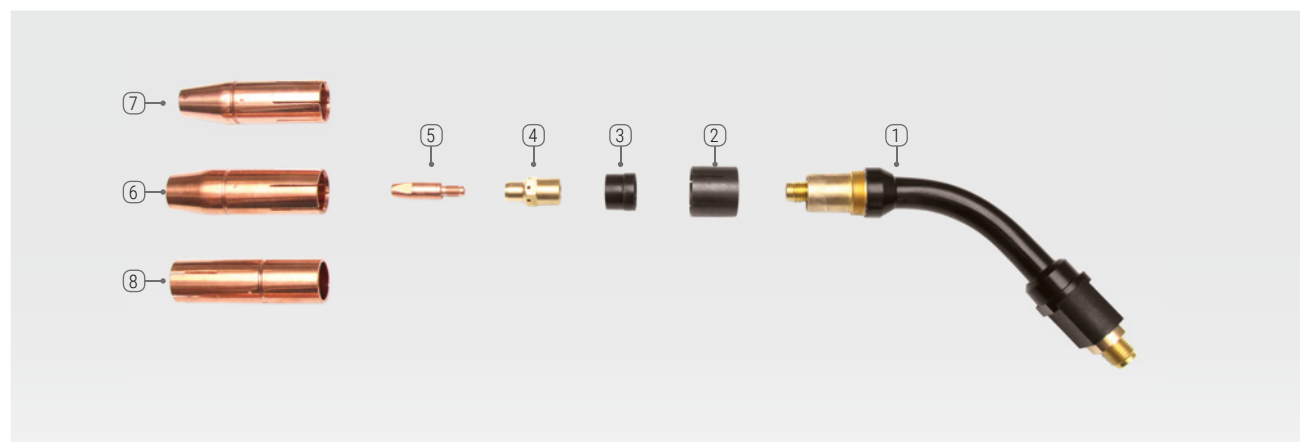

No.	Replaceable elements	Cat. no.	Ref. no.
1	45° 2300 swan neck	55 33 000380	34.0350.1875
2	2300/2500 Locking nut	55 33 000235	42.0001.5171
3	2300/2500 insulator	55 33 000220	42.0100.0225
4	M6 2300/2500 contact tip holder	55 33 000185	42.0001.1718
5	Contact tip M6x33 2300/2500	table p. 59	
6	Gas nozzle Ø12 L=66 mm 2300/2500	55 33 000100	42.0001.5173
7	Gas nozzle Ø10 L=66 mm 2300/2500	55 33 000101	42.0001.5174
8	Gas nozzle Ø17 L=66 mm 2300/2500	55 33 000102	42.0001.5172

Parts compatible with FRONIUS welding torches: AL 3000 / AW 4000

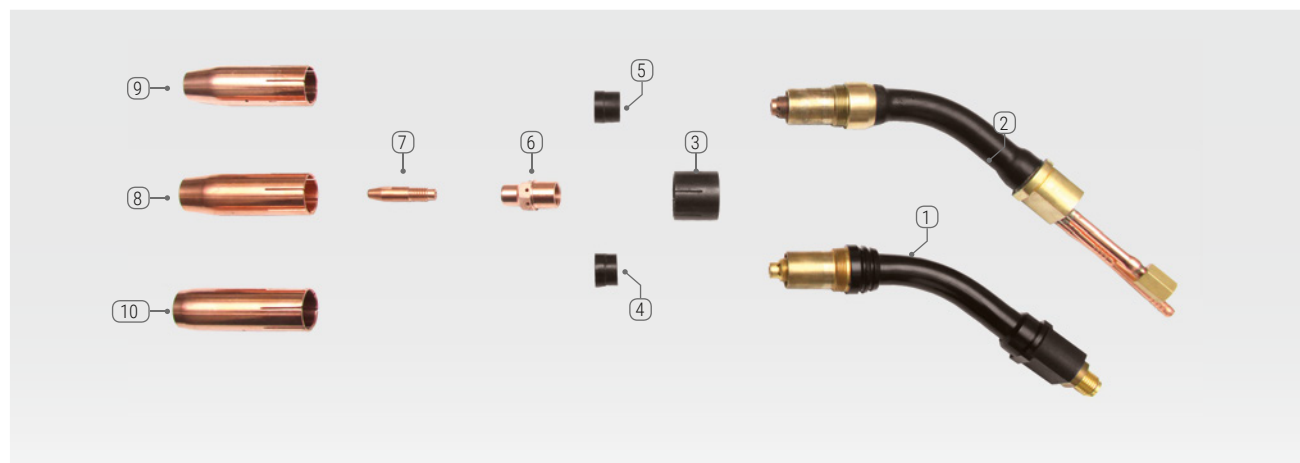

No.	Replaceable elements	Cat. no.	Ref. no.
1	45° 3000 swan neck	55 33 000385	34.0350.1771
2	45° 4000 swan neck	55 33 000388	34.0350.1812
3	Locking nut 3000/4000	55 33 000236	42.0001.2930
4	Isolator 3000	55 33 000225	42.0100.1014
5	Isolator 4000	55 33 000223	42.0100.1010
6	M8 3000/4000 contact tip holder	55 33 000190	42.0001.5084
7	M8x35 3000/4000 contact tip	table p. 59	
8	Gas nozzle Ø13 L=67 mm 3000/4000	55 33 000120	42.0001.5096
9	Gas nozzle Ø11 L=67 mm 3000/4000	55 33 000121	42.0001.5151
10	Gas nozzle Ø15 L=67 mm 3000/4000	55 33 000122	42.0001.5269

The pictures above show replacement products manufactured for RYWAL-RHC. Presented alternatives to parts of FRONIUS torches are not the original parts. Names and reference numbers of FRONIUS torches and spare parts were provided to inform about the intended application of the offered replacement parts.

**Parts compatible with FRONIUS welding torches:
AL 4000 / AW 5000**

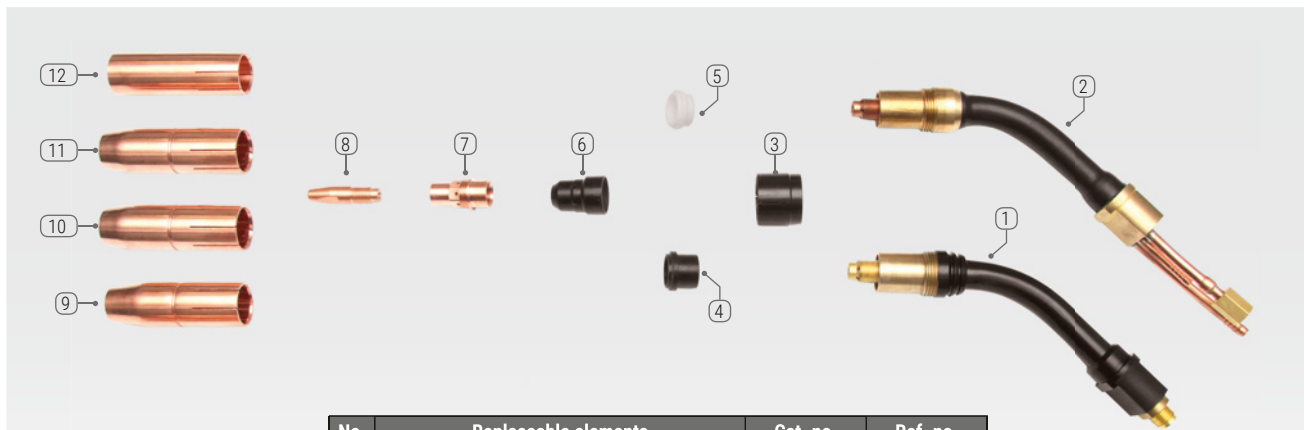

No.	Replaceable elements	Cat. no.	Ref. no.
1	45° 4000 swan neck	55 33 000391	34.0350.1822
2	45° 5000 swan neck	55 33 000394	34.0350.1820
3	Locking nut 4000/5000	55 33 000237	42.0001.2970
4	Isolator 4000	55 33 000227	42.0100.1018
5	Isolator 5000	55 33 000229	42.0100.1016
6	4000/5000 gas diffuser	55 33 000240	42.0100.1007
7	M10 4000/5000 contact tip holder	55 33 000195	42.0001.5122
8	M10x40 4000/5000 contact tip	table below	
9	Gas nozzle Ø17 L=79 mm 4000/5000	55 33 000130	42.0001.5128
10	Gas nozzle Ø15 L=79 mm 4000/5000	55 33 000131	42.0001.5129
11	Gas nozzle Ø20 L=79 mm 4000/5000	55 33 000132	42.0001.5127
12	Gas nozzle Ø17 L=79 mm thick 4000/5000	55 33 000133	42.0001.5130

Contact tip Wire diameter	M6x33		M8x35		M10x40	
	Cat. no.	Ref. no.	Cat. no.	Ref. no.	Cat. no.	Ref. no.
0,8 mm	55 33 000020	42.0001.3283				
1,0 mm	55 33 000022	42.0001.3282				
1,2 mm	55 33 000023	42.0001.3281				
0,8 mm CuCrZr	55 33 000040	42.0001.0053	55 33 000070	42.0001.2911	55 33 000080	42.0001.1576
1,0 mm CuCrZr	55 33 000042	42.0001.0054	55 33 000072	42.0001.2912	55 33 000082	42.0001.1577
1,2 mm CuCrZr	55 33 000043	42.0001.0055	55 33 000073	42.0001.2913	55 33 000083	42.0001.1578
1,6 mm CuCrZr	55 33 000045	42.0001.0056			55 33 000085	42.0001.1579
0,8 mm Al			55 33 000060	42.0001.5082		
1,0 mm Al			55 33 000061	42.0001.5051		
1,2 mm Al			55 33 000062	42.0001.5052		

Parts compatible with welding torches MTW 400i/500i



No.	Replaceable elements	Ref. no.	Cat. no.
1	Gas nozzle Ø15 L=63 400i/500i	42.0001.4051.5	55 33 000489
	Gas nozzle Ø17 L=63 400i/500i	42.0001.4050.5	55 33 000490
2	Contact tip M8x1,5x32 0,8 CuCrZr	42.0001.6464.10	55 33 000418
	Contact tip M8x1,5x32 1,0 CuCrZr	42.0001.6466.10	55 33 000419
	Contact tip M8x1,5x32 1,2 CuCrZr	42.0001.6467.10	55 33 000420
3	Gas diffuser 20,8x24 mm 400i/500i	42.0405.0854.5	55 33 000600
4	Contact tip adapter M8x1,5 400i/500i	42.0001.4037.5	55 33 000640
5	Insulator 20,8x14x7,3 mm 400i/500i	42.0100.1329.5	55 33 000610

The pictures above show replacement products manufactured for RYWAL-RHC. Presented alternatives to parts of FRONIUS torches are not the original parts. Names and reference numbers of FRONIUS torches and spare parts are advised only to inform about the application of offered replacement parts.

▼ 8.6. Special accessories for MIG/MAG torches



Special swan necks M501

- Longer versions of the M501 MOST torch.
- It allows you to adapt the welding torch to work in hard to reach spaces.

Model	Length	Catalogue No.
M501L MOST swan neck	L=300 mm	55 13 01409A
M501XL MOST swan neck	L=400 mm	55 13 01409B
M501XXL MOST swan neck	L=500 mm	55 13 01409C

Swan neck is supplied without nozzle.

For special torches, the longer liner must be replaced. Leading input, set $\varnothing 2,0 / 6$ m, catalogue no.: 55 13 012506.



Narrow gap welding nozzle for M401 / M501 torches

Model	Catalogue No.
Gas nozzle M401/501 long 13x124 mm	55 13 000618
1,0 M8x80 mm CuCrZr long contact tip	55 13 002642
1,2 M8x80 mm CuCrZr long contact tip	55 13 002643

* Other parts, i.e. gas diffuser and standard contact tip holder 401 / 501 - page 47.

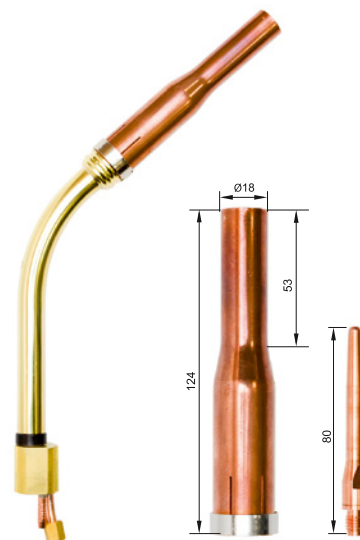

▼ 8.7. TIG welding torches



T9 SGRIP

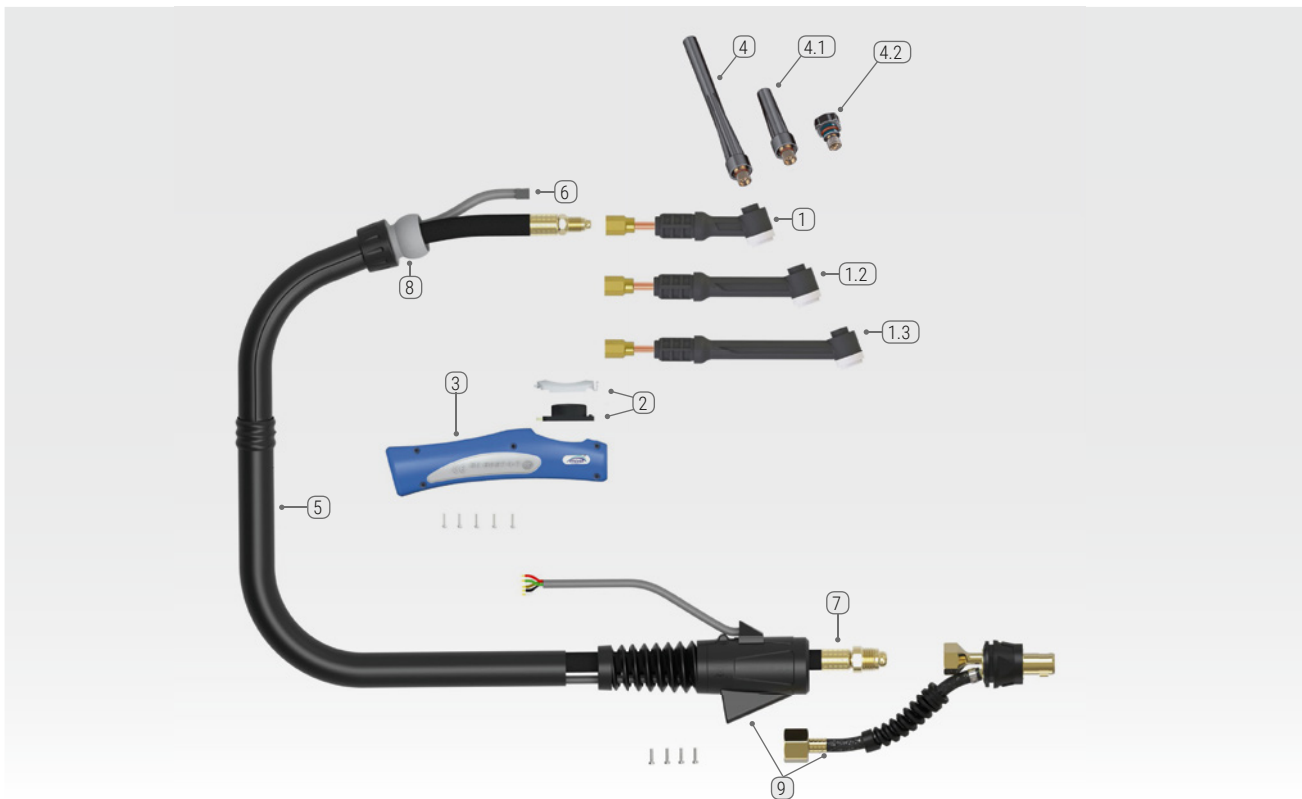

Model	T9 SGRIP
Cooling	Gas
Technical data according to EN 60 974-7:	
▪ Rating 35% duty cycle	90 A AC / 125 A DC
▪ Tungsten electrode diameter	1,0-1,6 mm
▪ Gas flow	5-12 l/min
▪ Weight	0,75 kg
Length / Catalogue No.	(4,0 m) 56 01 060904 (8,0 m) 56 01 060908

T9F SGRIP version with flexible torch, technical data as for T9 SGRIP.

Torches supplied without control plugs.

V - torch with gas valve, without button.

F - flexible torch.

DC - direct current.

AC - alternating current.

No.	Replaceable elements	Catalogue No.	Alternative designation
1	T9 MOST* torch body	56 13 003350	-
1.1	T9F MOST torch body	56 13 003351	-
1.2	T9FXL torch body L=75 mm MOST	56 13 00335L	-
1.3	T9FXL torch body L=100 mm MOST	56 13 00335X	-
2	Set button ON/OFF	56 13 200100	UER1MS
3	Small handle TSGRIP	56 13 200221	RY-ERH100
4	Long back cup T-9/20	56 13 003170	41V24
4.1	Medium back cup T-9/20	56 13 003250	42V35
4.2	Short back cup T-9/20	56 13 003280	41V33
5	Cable cover (m)	51 13 015288	-
5.1	Cable cover 4 m	56 13 200197	USLERC0100-40
5.2	Cable cover 8 m	56 13 200198	USLERC0100-80
6	4 m control cable	56 13 200217	UERSWL4
6.1	8 m control cable	56 13 200218	UERSWL8
7	T9 power gas cable 4 m	56 13 200200	USLHD57Y01AOB
7.1	T9 power gas cable 8 m	56 13 200201	USLHD57Y03AOB
8	TIG joint	56 13 200266	UERKJ100
9	T9 plug assembly	56 13 200274	UNSL3550-917-G-S5

* standard version

- Parts for TIG torches - pages 73-81.
- We provide custom made TIG welding torches adapted to all common welding equipment - send email to export@rywal.com.pl
- TIG welding rods - chapter 10.
- Tungsten electrodes and tungsten electrode sharpeners - pages 82-83.



T17V SGRIP

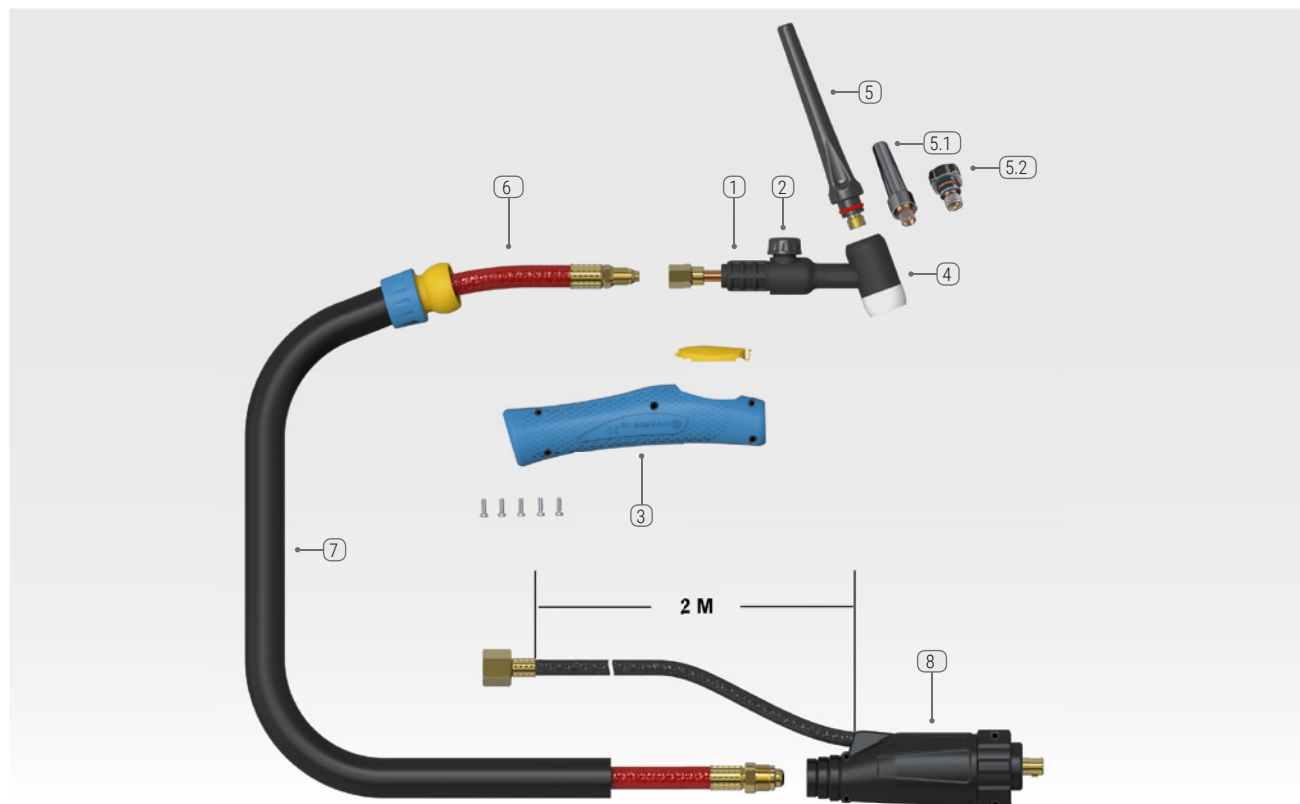

Model	T17V SGRIP
Cooling	Gas
Technical data according to EN 60 974-7:	
▪ Rating 35% duty cycle	95 A AC / 135 A DC
▪ Tungsten electrode diameter	1,0- 2,4 mm
▪ Gas flow	5-12 l/min
▪ Weight	0,75 kg
Length / Catalogue No.	(4,0 m) 56 01 061704

V - torch with gas valve, without button.

F - flexible torch.

DC - direct current.

AC - alternating current.

No.	Replaceable elements	Catalogue No.	Alternative designation
1	T-17V MOST torch body	56 13 003417	UWP17V
2	T-17V valve	56 13 003135	-
3	TIG17V handle	56 13 007512	UCH100
4	T-17/18/26 insulator	56 13 014810	18CG
5	Long back cup T-17/18/26	56 13 003181	57Y02
5.1	Medium back cup T-17/18/26	56 13 003251	-
5.2	Short back cup T-17/18/26	56 13 003270	57Y04
6	Power gas cable TIG17V 4 m	56 13 016160	USL57Y01A
7	Cable cover (m)	51 13 015288	-
8	TIG17V 10/25 plug assembly	56 13 016412	UML1025-916-M-G5

- Parts for TIG torches - pages 73-81.
- We provide custom made TIG welding torches adapted to all common welding equipment - send email to export@rywal.com.pl
- TIG welding rods - chapter 10.
- Tungsten electrodes and tungsten electrode sharpeners - pages 82-83.



T17 SGRIP

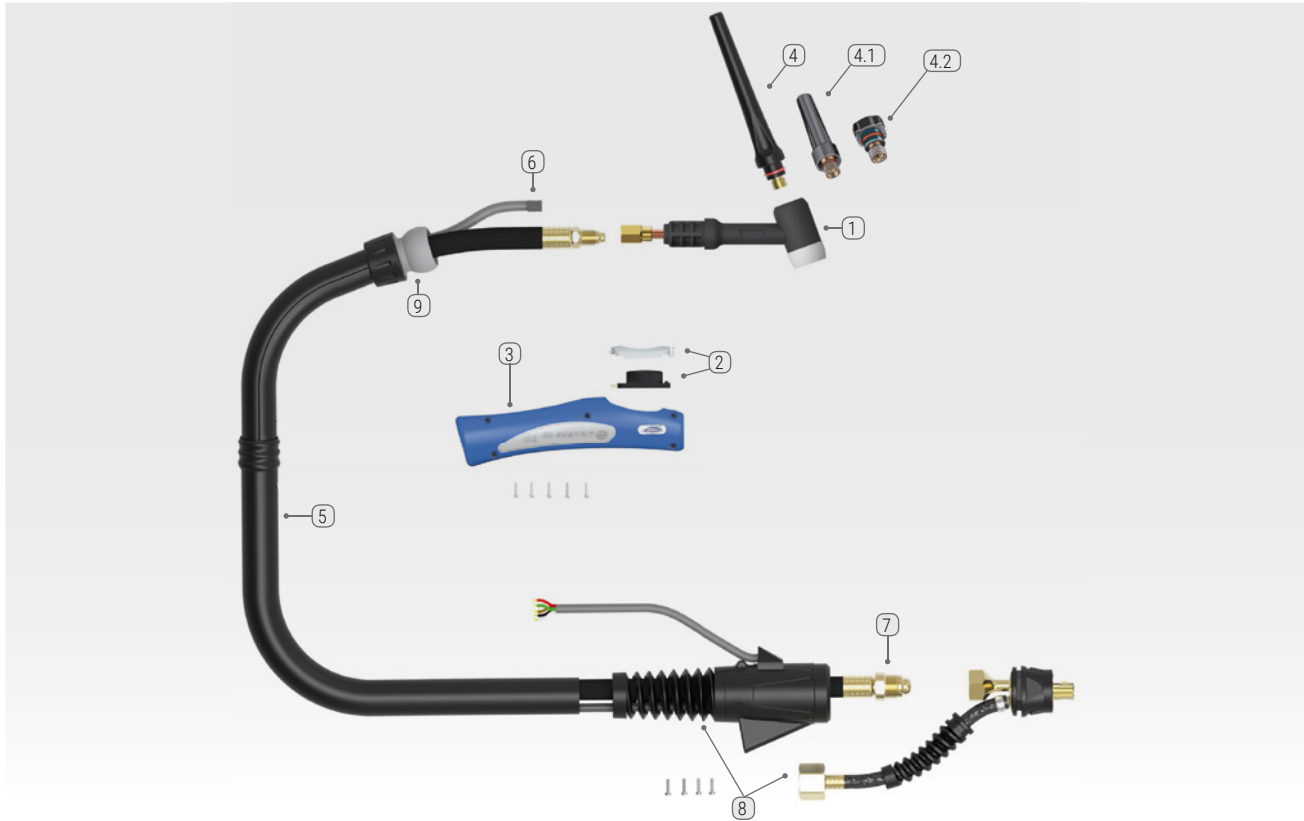

Model	T17 SGRIP
Cooling	Gas
Technical data according to EN 60 974-7:	
▪ Rating 35% duty cycle	105 A AC / 150 A DC
▪ Tungsten electrode diameter	1,0-2,4 mm
▪ Gas flow	5-12 l/min
▪ Weight	0,75 kg
Length / Catalogue No.	(4,0 m) 56 01 061716 (8,0 m) 56 01 061717

T17F SGRIP version with flexible torch, technical data as for T17 SGRIP.

Torches are supplied without control plugs.

V - torch with gas valve, without button.

F - flexible torch.

DC - direct current.

AC - alternating current.

No.	Replaceable elements	Catalogue No.	Alternative designation
1	T-17 MOST* torch body	56 13 003367	-
1.1	T17F MOST torch body	56 13 003382	-
2	Set button ON/OFF	56 13 200100	UER1MS
3	Small handle TSGRIP	56 13 200221	RY-ERH100-A
4	Long back cup T-17/18/26	56 13 003181	57Y02
4.1	Medium back cup T-17/18/26	56 13 003251	-
4.2	Short back cup T-17/18/26	56 13 003270	57Y04
5	Cable cover (m)	51 13 015288	-
5.1	Cable cover 4 m	56 13 200200	USLHD57Y01A0B
5.2	Cable cover 8 m	56 13 200201	USLHD57Y03A0B
6	Control cable 4 m	56 13 200217	UERSWL4
6.1	Control cable 8 m	56 13 200218	UERSWL8
7	TIG17 power gas cable 4 m	56 13 200217	UERSWL4
7.1	TIG17 power gas cable 8 m	56 13 200218	UERSWL8
8	T17 plug assembly	56 13 200275	UNSL1625-917-GS5
9	TIG joint	56 13 200266	UERKJ100

* standard version

- Parts for TIG torches - pages 73-81.
- We provide custom made TIG welding torches adapted to all common welding equipment - send email to export@rywal.com.pl
- TIG welding rods - chapter 10.
- Tungsten electrodes and tungsten electrode sharpeners - pages 82-83.



T26 SGRIP

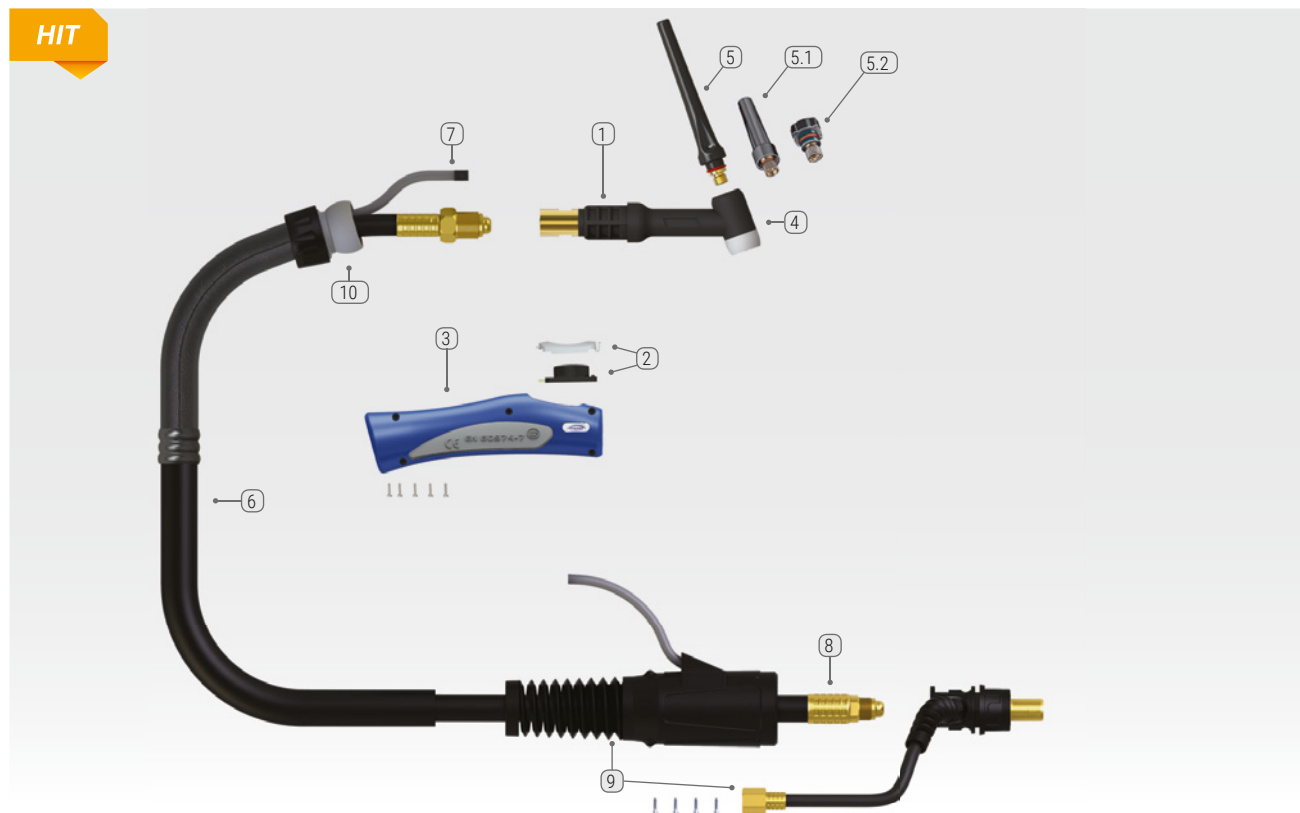

Model	T26 SGRIP
Cooling	Gas
Technical data according to EN 60 974-7:	
▪ Rating 35% duty cycle	125 A AC / 180 A DC
▪ Tungsten electrode diameter	1,0-3,2 mm
▪ Gas flow	5-12 l/min
Length / Catalogue No.	(4,0 m) 56 01 062604 (8,0 m) 56 01 062608 (12,0 m) 56 01 062612

T26F SGRIP version with a flexible torch, technical data as for T26 SGRIP.

Torches are supplied without control plugs.

V - torch with gas valve, without button.

F - flexible torch.

DC - direct current.

AC - alternating current.

No.	Replaceable elements	Catalogue No.	Alternative designation
1	T-26 MOST* torch body	56 13 003398	-
1.1	T-26F MOST torch body	56 13 003397	-
2	Set button ON/OFF	56 13 200100	UERBS
3	TIG SGRIP large handle	56 13 200220	RY-ERH200
4	T-17/18/26 insulator	56 13 014810	18CG
5	Long back cup T-17/18/26	56 13 003181	57Y02
5.1	Medium back cup T-17/18/26	56 13 003251	-
5.2	Short back cup T-17/18/26	56 13 003270	57Y04
6	Cable cover (m)	51 13 015289	-
6.1	Cable cover 4 m	56 13 200250	USLERC200-40
6.2	Cable cover 8 m	56 13 200251	USLERC200-80
6.3	Cable cover 12 m	56 13 200252	USLERC200-120
7	Control cable with 4 m plug Control cable with 8 m plug Control cable with 12 m plug	56 13 200217 56 13 200218 56 13 200219	UERSWL4 UERSWL8 UERSWL12
8	Power gas cable T-26 MOST 4 m Power gas cable T-26 MOST 8 m Power gas cable T-26 MOST 12 m	56 13 200212 56 13 200213 56 13 200214	USL46V28A0B USL46V30A0B USL46V37A0B
9	TIG26 plug assembly	56 13 200272	UNSL 35-50-26-GS5
10	TIG joint	56 13 200264	UERKJ200

* standard version

- Parts for TIG torches - pages 73-81.
- We provide custom made TIG welding torches adapted to all common welding equipment - send email to export@rywal.com.pl
- TIG welding rods - chapter 10.
- Tungsten electrodes and tungsten electrode sharpeners - pages 82-83.



T26V SGRIP

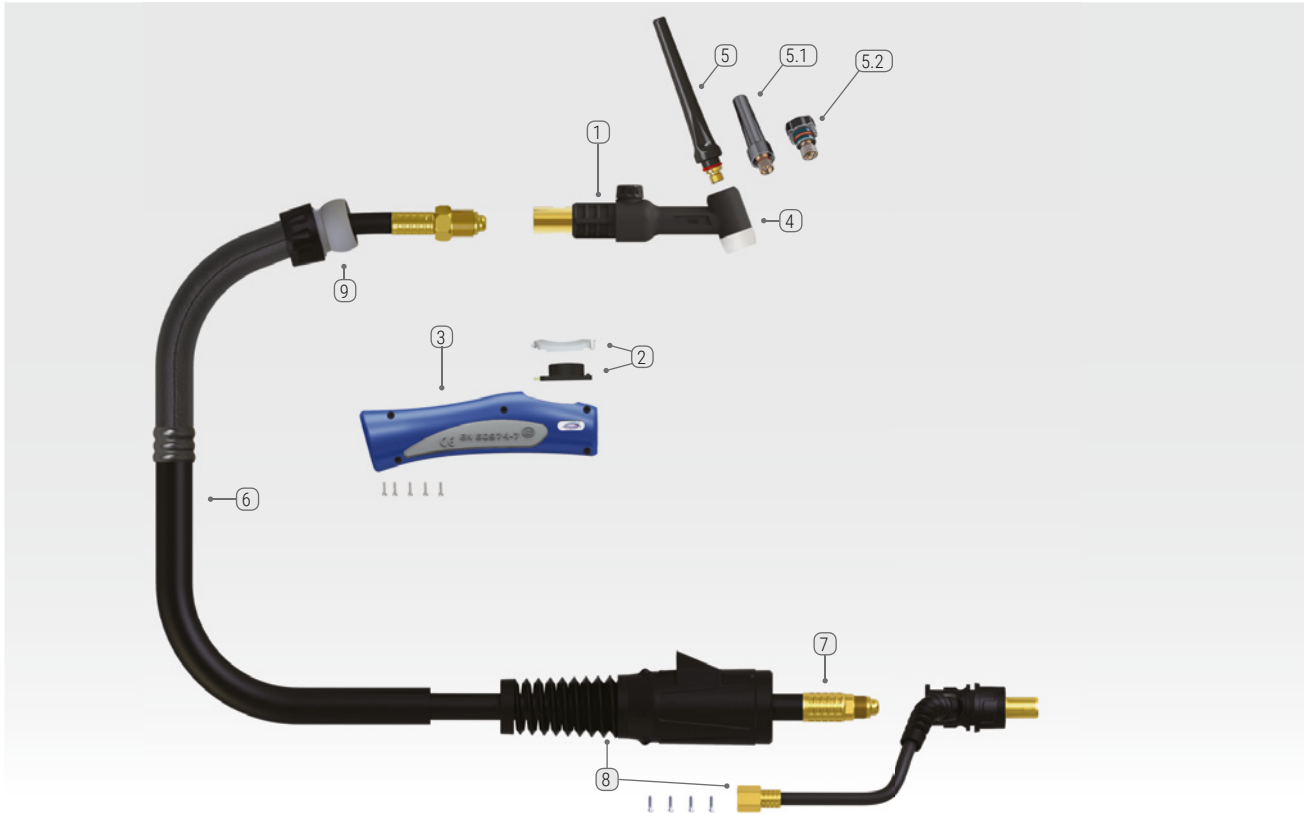

Model	T26V SGRIP
Cooling	Gas
Technical data according to EN 60 974-7:	
▪ Rating 35% duty cycle	125 A AC / 180 A DC
▪ Tungsten electrode diameter	1,0-3,2 mm
▪ Gas flow	5-12 l/min
Length / Catalogue No.	(4,0 m) 56 01 062634 (8,0 m) 56 01 062638

No.	Replaceable elements	Catalogue No.	Alternative designation
1	T-26V MOST* torch body	56 13 003363	UWP26V
1.1	T-26VF MOST torch body	56 13 003370	UWP26VFX
2	TIG button cover	56 13 200105	UERBS
3	TIG SGRIP large torch	56 13 200220	RY-ERH200
4	T-17/18/26 insulator	56 13 014810	18CG
5	Long back cup T-17/18/26	56 13 003181	57Y02
5.1	Medium back cup T-17/18/26	56 13 003251	-
5.2	Short back cup T-17/18/26	56 13 003270	57Y04
6	Cable cover (m)	51 13 015289	-
6.1	Cable cover 4 m	56 13 200250	USLERC200-40
6.2	Cable cover 8 m	56 13 200251	USLERC200-80
7	Power gas cable T-26 MOST 4 m Power gas cable T-26 MOST 8 m	56 13 200212 56 13 200213	USL46V28AOB USL46V30AOB
8	TIG26 plug assembly	56 13 200272	UNSL 35-50-26-GS5
9	TIG joint	56 13 200264	UERKJ200

T26VF SGRIP version with a flexible torch, technical data as for T26 SGRIP.

Torches are supplied with a gas cap.

V - torch with gas valve, without button.

F - flexible torch.

DC - direct current.

AC - alternating current.

* standard version

- Parts for TIG torches - pages 73-81.
- We provide custom made TIG welding torches adapted to all common welding equipment - send email to export@rywal.com.pl
- TIG welding rods - chapter 10.
- Tungsten electrodes and tungsten electrode sharpeners - pages 82-83.



T125 SGRIP

Welding torch with rotating body and torch head

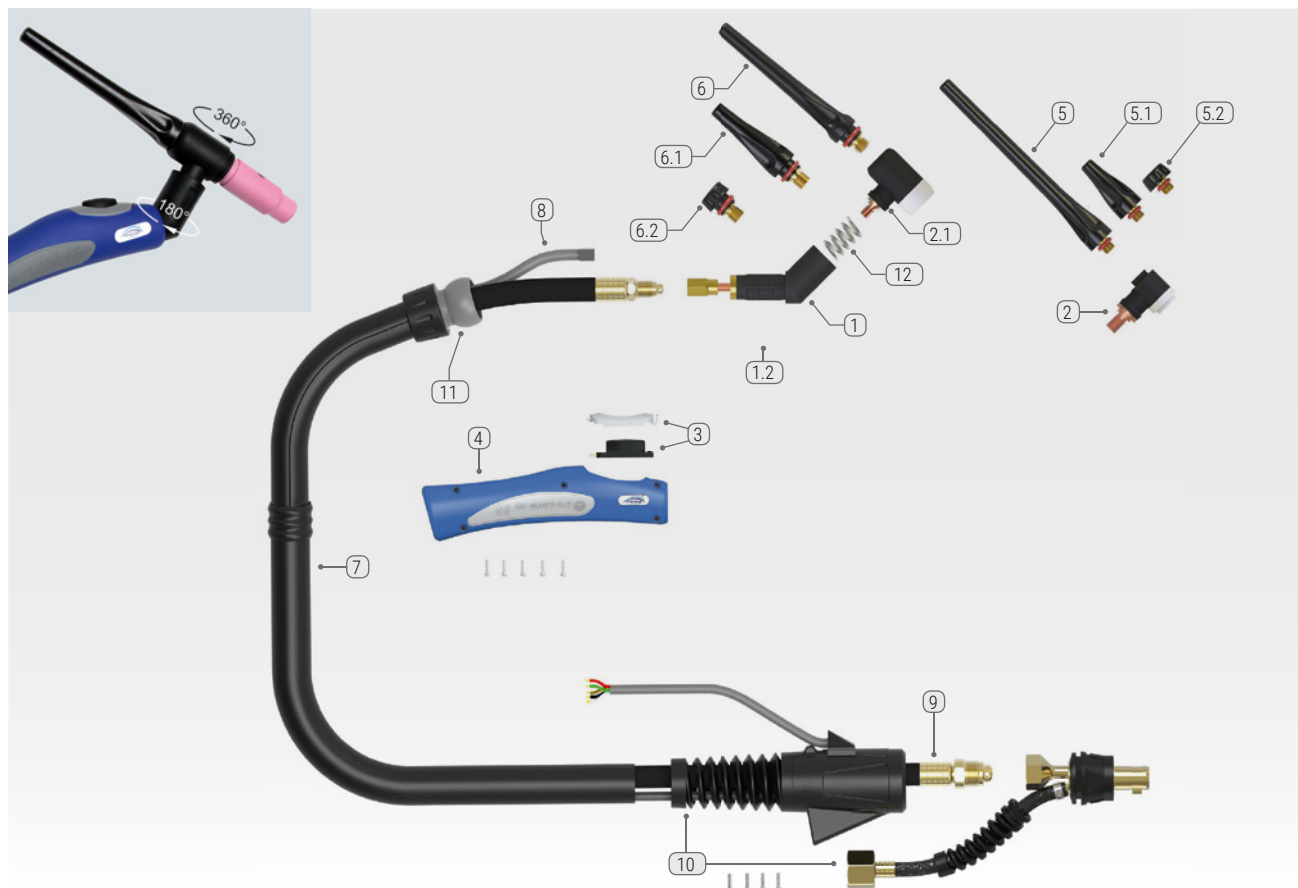

Model	T125 SGRIP	
Cooling	Gas	
Technical data according to EN 60 974-7:		
▪ Rating 35% duty cycle	For the UM9-90 head	For the UM17-90* head
▪ Tungsten electrode diameter	65 A AC / 95 A DC 1,0-1,6 mm	105 A AC / 150 A DC 1,0-3,2 mm
▪ Gas flow	5-12 l/min	5-12 l/min
Length / Catalogue No.	(4,0 m) 56 01 061254 (8,0 m) 56 01 061258	

The possibility of using spare parts of the 9/20 and 18/26 standard thanks to the exchangeable burner head.

Torches are supplied without control plugs.

V - torch with gas valve, without button.

F - flexible torch.

DC - direct current.

AC - alternating current.

* standard version

No.	Replaceable elements	Catalogue No.	Alternative designation
1	Torch body T125 MOST	56 13 003510	U125M
2	Torch head T125/250 small	56 13 003525	UM9-90
2.1	Torch head T125/250 large	56 13 003526	UM17-90
3	Set button ON/OFF	56 13 200100	UER1MS
4	Small handle TIG SGRIP	56 13 200221	RY-ERH100
5	Long back cup T-9/20	56 13 003170	41V24
5.1	Medium back cup T-9/20	56 13 003250	41V35
5.2	Short back cup T-9/20	56 13 003280	41V33
6	Long back cup T-17/18/26	56 13 003181	57Y02
6.1	Medium back cup T-17/18/26	56 13 003251	-
6.2	Short back cup T-17/18/26	56 13 003270	57Y04
7	Cable cover (m)	51 13 015288	-
7.1	Cable cover 4 m	56 13 200197	USLRCO100-40
7.2	Cable cover 8 m	56 13 200198	USLRCO100-80
8	Control cable T-9/18/26	56 13 200217	UERSWL4
8.1	Control cable T-9/18/26	56 13 200218	UERSWL8
9	Power gas cable T125 4 m	56 13 200200	USLHD57Y01A0B
9.1	Power gas cable T125 8 m	56 13 200201	USLHD57Y03A0B
10	T125 plug assembly	56 13 200274	UNSL3550-917-GS5
11	TIG joint	56 13 200266	UERKJ100
12	Spring T125/250	56 13 003517	4276270

▪ Parts for TIG torches - pages 73-81.

▪ We provide custom made TIG welding torches adapted to all common welding equipment - send email to export@rywal.com.pl

▪ TIG welding rods - chapter 10.

▪ Tungsten electrodes and tungsten electrode sharpeners - pages 82-83.



T20 SGRIP

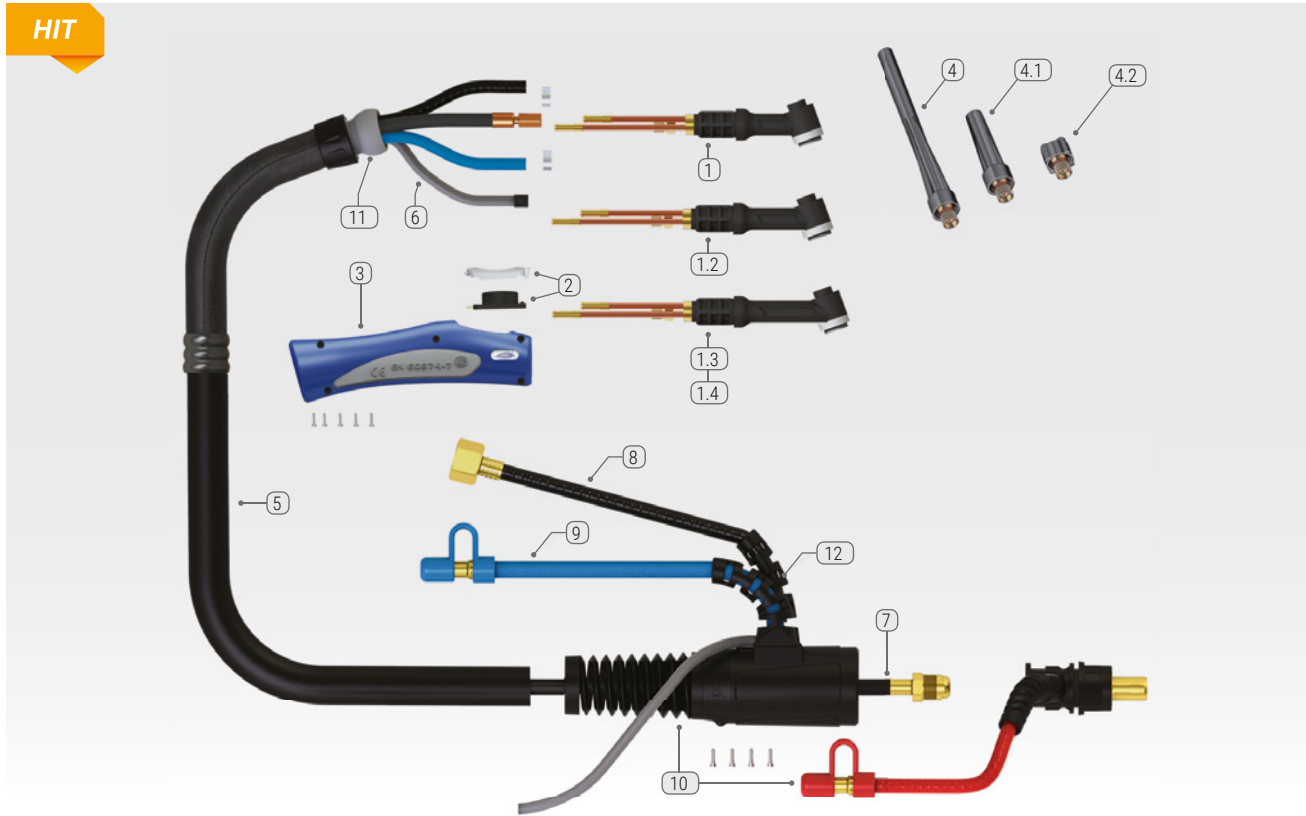

Model	T20 SGRIP
Cooling	Liquid
Technical data according to EN 60 974-7:	
▪ Rating 100% duty cycle	160 A AC / 225 A DC
▪ Tungsten electrode diameter	1,0-3,2 mm
▪ Gas flow	5-12 l/min
Length / Catalogue No.	(4,0 m) 56 01 062004 (8,0 m) 56 01 062008 (12,0 m) 56 01 062012

T20F SGRIP version with a flexible torch, technical data as for T26 SGRIP.
Torches are supplied without control plugs.

V - torch with gas valve, without button.
F - flexible torch.
DC - direct current.
AC - alternating current.

No.	Replaceable elements	Catalogue No.	Alternative designation
3	Small handle TSGRIP	56 13 200221	RY-ERH100
4	Long back cup T-9/20	56 13 003170	41V24
4.1	Medium back cup T-9/20	56 13 003250	41V35
4.2	Short back cup T-9/20	56 13 003280	41V33
5	Cable cover (m)	51 12 015289	-
5.1	Cable cover 4 m	56 13 200197	USLERCO100-40
5.2	Cable cover 8 m	56 13 200198	USLERCO100-80
5.3	Cable cover 12 m	56 13 200199	USLERCO100-120
6	Control cable 4 m Control cable 8 m Control cable 12 m	56 13 200217 56 13 200218 56 13 200219	UERSWL4 UERSWL8 UERSWL12
7	20W SGRIP 4 m power water cable 20W SGRIP 8 m power water cable 20W SGRIP 12 m power water cable	56 13 200208 56 13 200209 56 13 200210	USL45V03A0B USL45V04A0B USL45V37A0B
8	Gas line, set 4 m Gas line, set 8 m Gas line, set 12 m	56 13 200187 56 13 200188 56 13 200189	U45V09-GS5 U45V10-GS5 U45V09-37-GS5
9	Blue water hose 4 m Blue water hose 8 m Blue water hose 12 m	56 13 200190 56 13 200191 56 13 200192	UN45V070B-WF1 UN45V080B-WF1 UN45V07-370B-WF1
10	TIG 18/20 plug assembly	56 13 200273	UNSL 35-50-1820-WR1
11	TIG joint	56 13 200266	UERKJ100
12	Cable stiffener	56 13 200265	USLH-1820S

* standard version

No.	Replaceable elements	Catalogue No.	Alternative designation
1	SR-20W MOST* torch body	56 13 003375	-
1.1	SR-20F MOST torch body	56 13 200008	-
1.2	T-20F torch body L=75 mm	56 13 003466	-
1.3	T-20F torch body L=100 mm	56 13 003467	-
1.4	T-20F torch body L=125 mm	56 13 003468	-
2	Set button ON/OFF	56 13 200100	UER1MS

- Parts for TIG torches - pages 73-81.
- We recommend using special coolants as on page 16.
- TIG welding rods - chapter 10.
- Tungsten electrodes and electrode sharpeners - pages 82-83.



T20S SGRIP

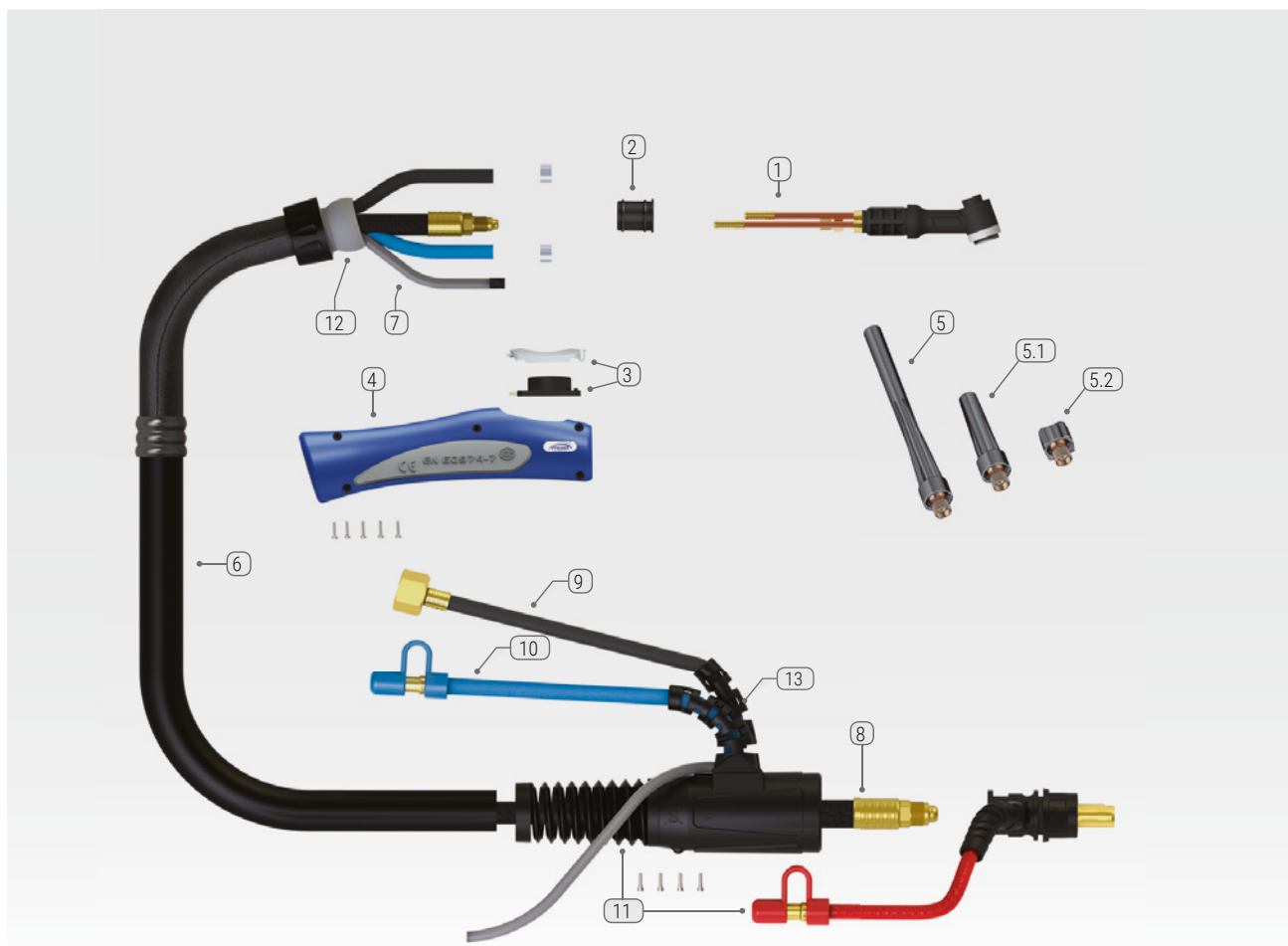

Model	T20S SGRIP
Cooling	Liquid
Technical data according to EN 60 974-7:	
▪ Rating 100% duty cycle	240 A AC / 340 A DC
▪ Tungsten electrode diameter	1,0-3,2 mm
▪ Gas flow	5-12 l/min
Length / Catalogue No.	(4,0 m) 56 01 062016 (8,0 m) 56 01 062018

No.	Replaceable elements	Catalogue No.	Alternative designation
1	T20S Torch body MOST	56 13 200007	
2	Adapter T20 torch head/large handle	56 13 200290	
3	Set button ON/OFF	56 13 200100	UER1MS
4	TIG SGRIP large handle	56 13 200220	RY-ERH200
5	Long back cup T-9/20	56 13 003170	41V24
5.1	Medium back cup T-9/20	56 13 003250	42V35
5.2	Short back cup T-9/20	56 13 003280	41V33
6	Cable cover	51 13 015289	
6.1	Cable cover 4 m	56 13 200250	USLERCO200-40
6.2	Cable cover 8 m	56 13 200251	USLERCO200-80
7	Control cable 4 m	56 13 200217	UERSWL4
	Control cable 8 m	56 13 200218	UERSWL8
8	18W SGRIP 4 m power water cable	56 13 200204	USL40V64A0B
	18W SGRIP 8 m power water cable	56 13 200205	USL41V29A0B
9	Gas line, set 4 m	56 13 200184	U45V090B-GS5
	Gas line, set 8 m	56 13 200185	U45V100B-GS5
10	Blue water hose 4 m	56 13 200190	U45V070B-WF1
	Blue water hose 8 m	56 13 200191	U45V080B-WF1
11	TIG18/20 plug assembly	56 13 200273	UNSL 35-50-1820-WR1
12	TIG joint	56 13 200264	UERKJ200
13	Cable stiffener	56 13 200265	USLH-1820S

- Parts for TIG torches - pages 73-81.
- We recommend using special coolants as on page 16.
- TIG welding rods - chapter 10.
- Tungsten electrodes and electrode sharpeners - pages 82-83.



T18 SGRIP / T18SC SGRIP

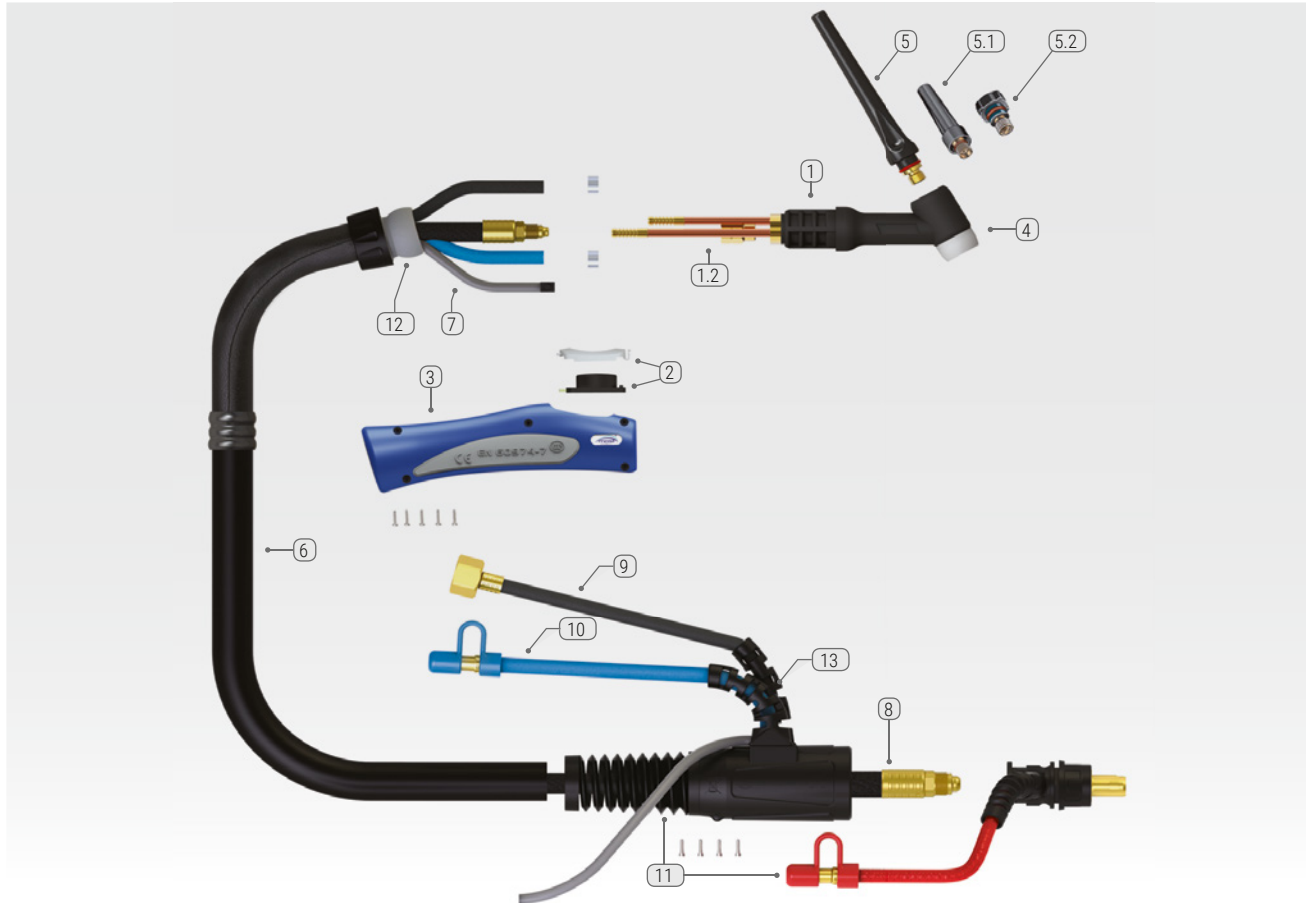

Model	T18 SGRIP	T18SC SGRIP
Cooling	Liquid	Liquid
Technical data according to EN 60 974-7:		
▪ Rating 35% duty cycle	270 A AC / 380 A DC	290 A AC / 410 A DC
▪ Tungsten electrode diameter	1,0-4,0 mm	1,0-4,0 mm
▪ Gas flow	5-12 l/min	5-12 l/min
Length / Catalogue No.	(4,0 m) 56 01 061804 (8,0 m) 56 01 061808 (12,0 m) 56 01 061812	(4,0 m) 56 01 061814 (8,0 m) 56 01 061818 (12,0 m) 56 01 061822

T18F SGRIP version with a flexible torch, technical data as for T18 SGRIP. Torches are supplied without control plugs.

V - torch with gas valve, without button.

F - flexible torch.

DC - direct current.

AC - alternating current.

No.	Replaceable elements	Catalogue No.	Alternative designation
5.1	Medium back cup T-17/18/26	56 13 003251	-
5.2	Short back cup T-17/18/26	56 13 003270	57Y04
6	Cable cover (m)	51 13 015289	-
6.1	Cable cover 4 m	56 13 200250	USLERCO200-40
6.2	Cable cover 8 m	56 13 200251	USLERCO200-80
6.3	Cable cover 12 m	56 13 200252	USLERCO200-120
7	Control cable 4 m Control cable 8 m Control cable 12 m	56 13 200217 56 13 200218 56 13 200219	UERSWL4 UERSWL8 UERSWL12
8	18W SGRIP 4 m power water cable 18W SGRIP 8 m power water cable 18W SGRIP 12 m power water cable	56 13 200204 56 13 200205 56 13 200206	USL40V64A0B USL41V29A0B USL41V37A0B
9	Gas line, set 4 m Gas line, set 8 m Gas line, set 12 m	56 13 200184 56 13 200185 56 13 200186	U45V090B-GS5 U45V100B-GS5 U45V09-370-GS5
10	Blue water hose 4 m Blue water hose 8 m Blue water hose 12 m	56 13 200190 56 13 200191 56 13 200193	U45V070B-WF1 U45V080B-WF1 U4507-370B-WF1
11	TIG18/20 plug assembly	56 13 200273	UNSL 35-50-1820-WR1
12	TIG joint	56 13 200264	UERKJ200
13	Cable stiffener	56 13 200265	USLH-1820S

* standard version

No.	Replaceable elements	Catalogue No.	Alternative designation
1	T-18W MOST* torch body	56 13 003372	-
1.1	T-18F MOST torch body (flexible)	56 13 200010	UWP18FX
1.2	T-18SC MOST torch body (reinforced)	56 13 200012	UWP18SC
2	Set button ON/OFF	56 13 200100	UER1MS
3	TIG SGRIP large handle	56 13 200220	RY-ERH200
4	T-17/18/26 insulator	56 13 014810	18CG
5	Long back cup T-17/18/26	56 13 003181	57Y02

- Parts for TIG torches - pages 73-81.
- We recommend using special coolants as on page 16.
- TIG welding rods - chapter 10.
- Tungsten electrodes and electrode sharpeners - pages 82-83.



T250 SGRIP

Welding torch with rotating body and torch head

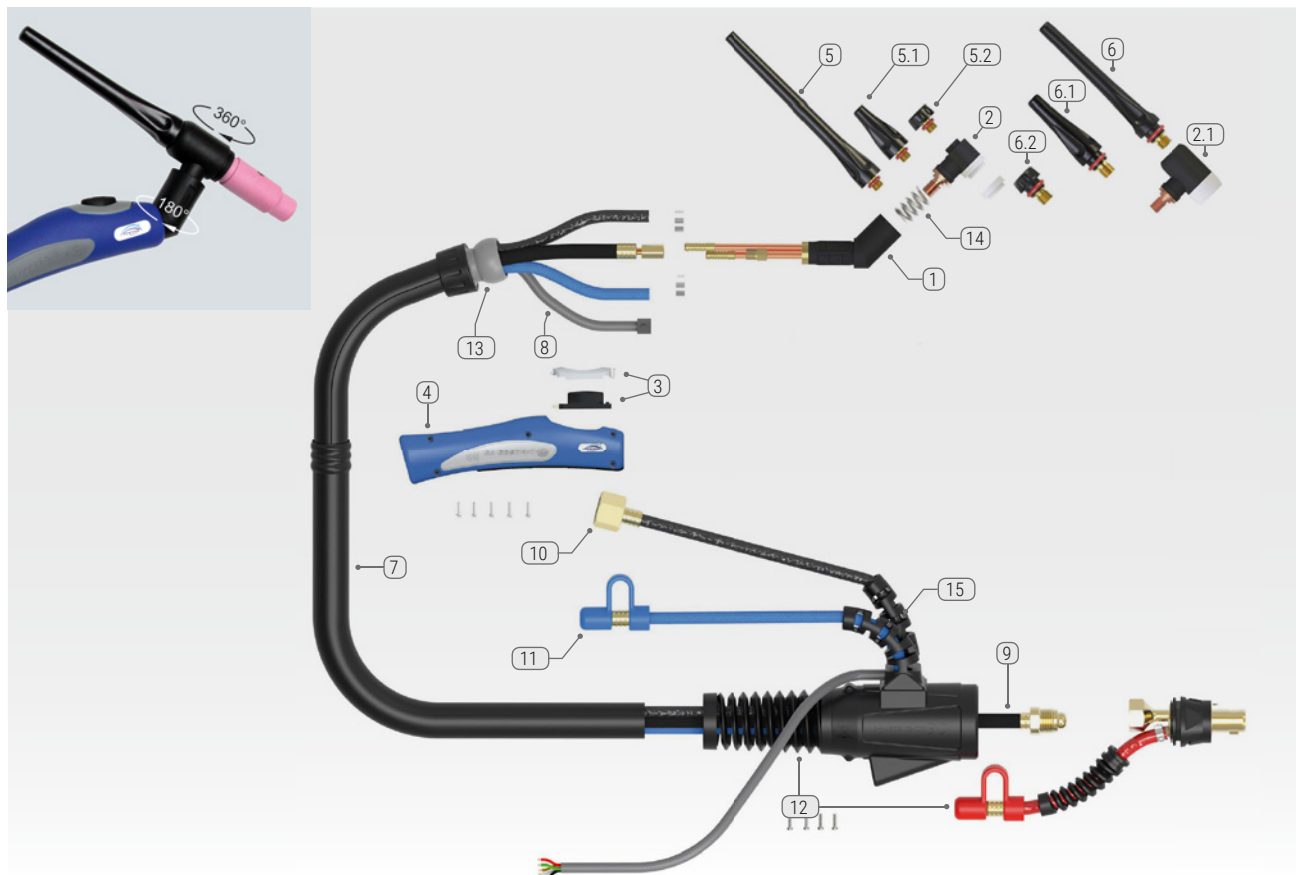

Model	T250 SGRIP	
Cooling	Liquid	
Technical data according to EN 60 974-7:	For the UM9-90* head	For the UM17-90 head
▪ Rating 100% duty cycle	160 A AC / 225 A DC	175 A AC / 250 A DC
▪ Tungsten electrode diameter	1,0-3,2 mm	1,0-4,0 mm
▪ Gas flow	5-12 l/min	5-12 l/min
Length / Catalogue No.	(4,0 m) 56 01 061284 (8,0 m) 56 01 061288	

Torches are supplied without control plugs.

V - torch with gas valve, without button.

F - flexible torch.

DC - direct current.

AC - alternating current.

* standard version

No.	Replaceable elements	Catalogue No.	Alternative designation
1	Torch body T250 MOST	56 13 003515	U250M
2	Torch head T125/250 small	56 13 003525	UM9-90
2.1	Torch head T125/250 large	56 13 003526	UM17-90
3	Set button ON/OFF	56 13 200100	UER1MS
4	Small handle TSGRIP	56 13 200221	RY-ERH100
5	Long back cup SR-9/20	56 13 003170	41V24
5.1	Medium back cup SR-9/20	56 13 003250	41V35
5.2	Short back cup SR-9/20	56 13 003280	41V33
6	Long back cup T-17/18/26	56 13 003181	57Y02
6.1	Medium back cup T-17/18/26	56 13 003251	-
6.2	Short back cup T-17/18/26	56 13 003270	57Y04
7	Cable cover (m)	51 13 015289	-
7.1	Cable cover 4 m	56 13 200197	USLERC0100-40
7.2	Cable cover 8 m	56 13 200198	USLERC0100-80
8	Control cable T-9/18/26 4 m	56 13 200217	UERSWL4
8.1	Control cable T-9/18/26 8 m	56 13 200218	UERSWL8
9	T250 4 m power-water cable	56 13 200208	USL45V03AOB
9.1	T250 8 m power-water cable	56 13 200209	USL45V04AOB
10	Gas line, set 4 m	56 13 200187	U45V09-GS5
	Gas line, set 8 m	56 13 200188	U45V10-GS5
	Gas line, set 12 m	56 13 200189	U45V09-37-GS5
11	Blue water hose 4 m	56 13 200190	UN45V070B-WF1
	Blue water hose 8 m	56 13 200191	UN45V080B-WF1
	Blue water hose 12 m	56 13 200192	UN45V07-370B-WF1
12	T250 plug assembly	56 13 200273	UNSL3550-1820-WR1
13	TIG joint	56 13 200266	UERKJ100
14	Spring T125/250	56 13 003517	4276270
15	Cable stiffener	56 13 200265	USLH-1820S

- Parts for TIG torches - pages 73-81.
- We recommend using special coolants as on page 16.
- TIG welding rods - chapter 10.
- Tungsten electrodes and electrode sharpeners - pages 82-83.



T225F SGRIP

Torch with flexible torch body and interchangeable torch heads

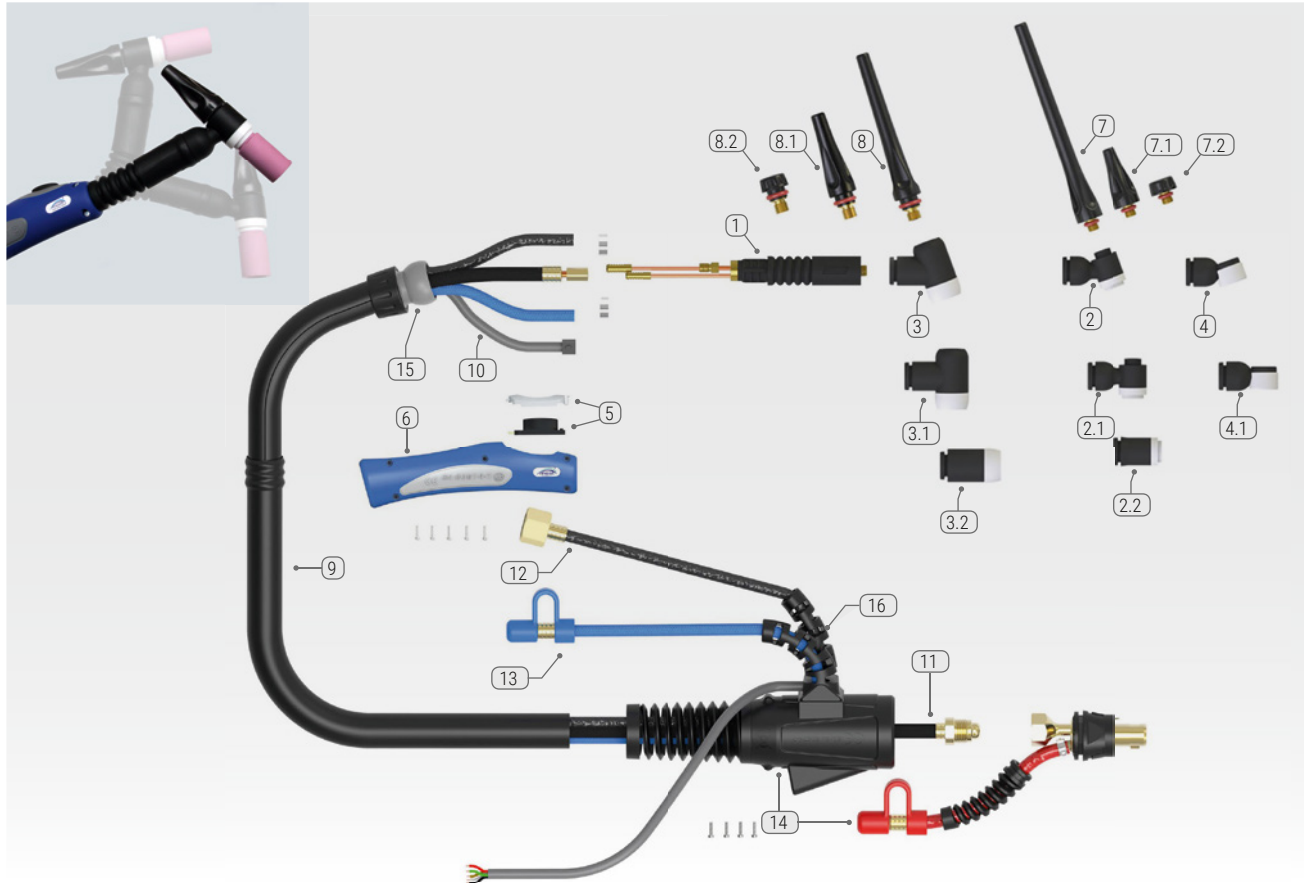

Model	T225F SGRIP	
Cooling	Liquid	
Technical data according to EN 60 974-7:	For the UM9-20* head 140 A AC / 200 A DC 1,0-2,4 mm 5-12 l/min	For the UM18-26 head 160 A AC / 225 A DC 1,0-3,2 mm 5-12 l/min
<ul style="list-style-type: none"> ▪ Rating 100% duty cycle ▪ Tungsten electrode diameter ▪ Gas flow 		
Length / Catalogue No.	(4,0 m) 56 01 061304 (8,0 m) 56 01 061308	

Torches are supplied without control plugs.

F- flexible torch.
* standard version

No.	Replaceable elements	Catalogue No.	Alternative designation
1	T225F MOST torch body	56 13 003520	U225F
2	T225F 9/20 70° UM20-70 MOST* torch head	56 13 003530	UM20-70
2.1	T225F 9/20 90° UM20-90 MOST torch head	56 13 003531	UM20-90
2.2	T225F 9/20 180° UM20-180 MOST torch head	56 13 003532	UM20-180
3	T225F 18/26 70° UM18-70 MOST torch head	56 13 003540	UM18-70
3.1	T225F 18/26 90° UM18-90 MOST torch head	56 13 003541	UM18-90
3.2	T225F 18/26 180° UM18-180 MOST torch head	56 13 003542	UM18-180

- Parts for TIG torches - see pages 73-81.
- We recommend using special coolants as on page 16.

No.	Replaceable elements	Catalogue No.	Alternative designation
4	T225F 24 70° UM24-70 MOST torch head	56 13 003550	UM24-70
4.1	T225F 24 90° UM24-90 MOST torch head	56 13 003551	UM24-90
5	Set button ON/OFF	56 13 200100	UERBS
6	Small handle TIG SGRIP	56 13 200221	RY-ERH100
7	Long back cup T-9/20	56 13 003170	41V24
7.1	Medium back cup T-9/20	56 13 003250	41V35
7.2	Short back cup T-9/20	56 13 003280	41V33
8	Long back cup T-17/18/26	56 13 003181	57Y02
8.1	Medium back cup T-17/18/26	56 13 003251	-
8.2	Short back cup T-17/18/26	56 13 003270	57Y04
9	Cable cover (m)	51 13 015289	-
9.1	Cable cover 4 m	56 13 200197	USLERCO100-40
9.2	Cable cover 8 m	56 13 200198	USLERCO100-80
10	Control cable T-9/18/26 4 m	56 13 200217	UERSWL4
10.1	Control cable T-9/18/26 8 m	56 13 200218	UERSWL8
11	T225F 4 m water cable	56 13 200208	USL45V03AOB
11.1	T225F 8 m water cable	56 13 200209	USL45V04AOB
12	Gas line, set 4 m	56 13 200187	U45V09-GS5
12.1	Gas line, set 8 m	56 13 200188	U45V10-GS5
13	Blue water hose 4 m	56 13 200190	UN45V070B-WF1
13.1	Blue water hose 8 m	56 13 200191	UN45V080B-WF1
14	T225F plug assembly	56 13 200273	UNSL3550-1820-WR1
15	TIG joint	56 13 200266	UERKJ100
16	Cable stiffener	56 13 200265	USLH-1820S

TIG torch bodies and heads

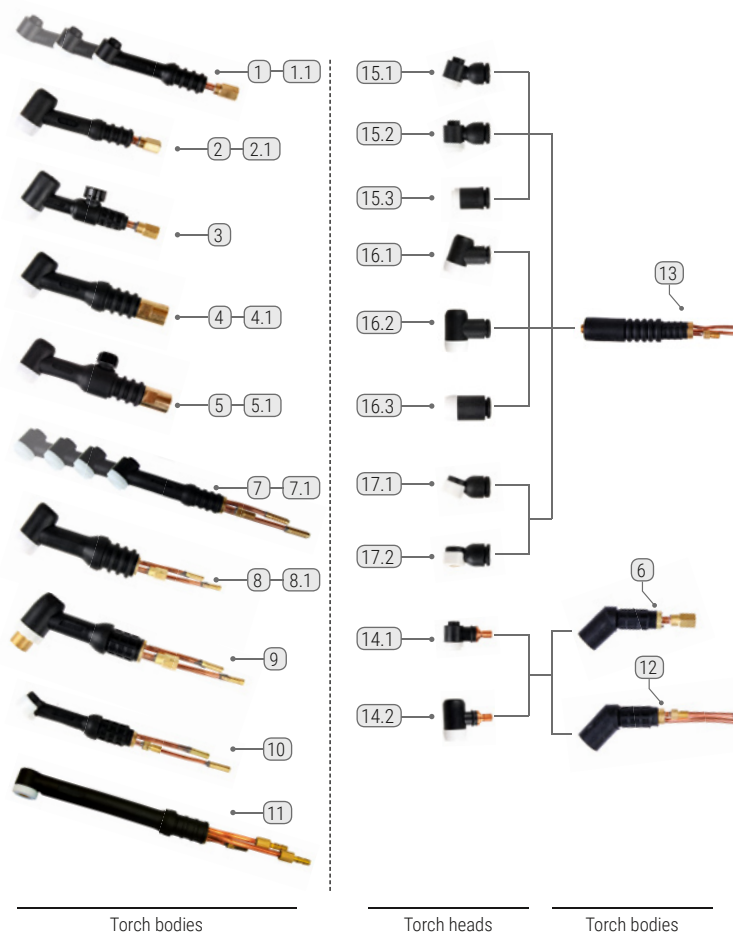

No.	Replaceable elements	Catalogue No.
gas cooled	1 Torch body T9 MOST	56 13 003350
	1.1 Torch body T9F (flexible) MOST	56 13 003351
	Torch body T9FXL L=75 mm (flexible) MOST	56 13 00335L
	Torch body T9FXL L=100 mm (flexible) MOST	56 13 00335X
	2 Torch body T17 MOST	56 13 003367
	2.1 Torch body T17F (flexible) MOST	56 13 003382
	3 Torch body T17V MOST	56 13 003417
	4 Torch body T26 MOST	56 13 003398
	4.1 Torch body T26F (flexible) MOST	56 13 003397
	5 Torch body T26V MOST	56 13 003369
	5.1 Torch body T26VF (flexible) MOST	56 13 003370
	6 Torch body T125 MOST (rotating*)	56 13 003510
	liquide cooled	7 Torch body T20 MOST
7.1 Torch body T20F (flexible) MOST		56 13 200008
Torch body T20FXL L=75 mm (flexible) MOST		56 13 003466
Torch body T20FXL L=100 mm (flexible) MOST		56 13 003467
Torch body T20FXL L=125 mm (flexible) MOST		56 13 003468
8 Torch body T18 MOST		56 13 003372
8.1 Torch body T18F (flexible) MOST		56 13 200010
9 Torch body T18SC MOST		56 13 200012
10 Torch body T24W MOST		56 13 200014
11 Torch body T24W FXL L=120 mm (flexible) MOST		56 13 200016
12 Torch body T250 MOST (rotating*)		56 13 003515
13 Torch body T225F (flexible) MOST		56 13 003520
torch heads		14.1 Torch head T125/250 mała 9/20 MOST
	14.2 Torch head T125/250 duża 17/18/26 MOST	56 13 003526
	15.1 Torch head T225F 9/20 70° MOST	56 13 003530
	15.2 Torch head T225F 9/20 90° MOST	56 13 003531
	15.3 Torch head T225F 9/20 180° MOST	56 13 003532
	16.1 Torch head T225F 17/18/26 70° MOST	56 13 003540
	16.2 Torch head T225F 17/18/26 90° MOST	56 13 003541
	16.3 Torch head T225F 17/18/26 180° MOST	56 13 003542
	17.1 Torch head T225F 24W 70° MOST	56 13 003550
	17.2 Torch head T225F 24W 90° MOST	56 13 003551

F - flexible V - with gas valve XL/XXL - extended

TIG SGRIP switches MOST

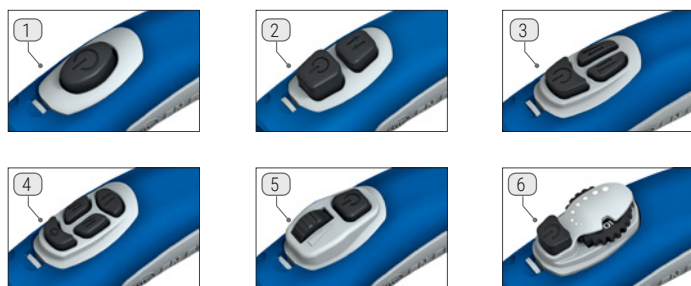

No.	Replaceable elements	Catalogue No.
1	ON/OFF momentary kit	56 13 200100
2	Button momentary kit	56 13 200107
3	Button momentary kit	56 13 200108
4	Button momentary kit	56 13 200104
5	Button maintained kit+10K vertical potentiometer	56 13 200112
6	Button maintained kit+10K horizontal potentiometer	56 13 200116

"Plug & Play" Switches can be replaced in 5 seconds without the use of tools



▼ 8.8. Spare parts for TIG welding torches



Parts compatible with 9, 20 and T20S TIG welding torches
 T125/T250 for the UM9-90 torch head
 T225F for UM20-70, UM20-90, UM20-180 torch heads

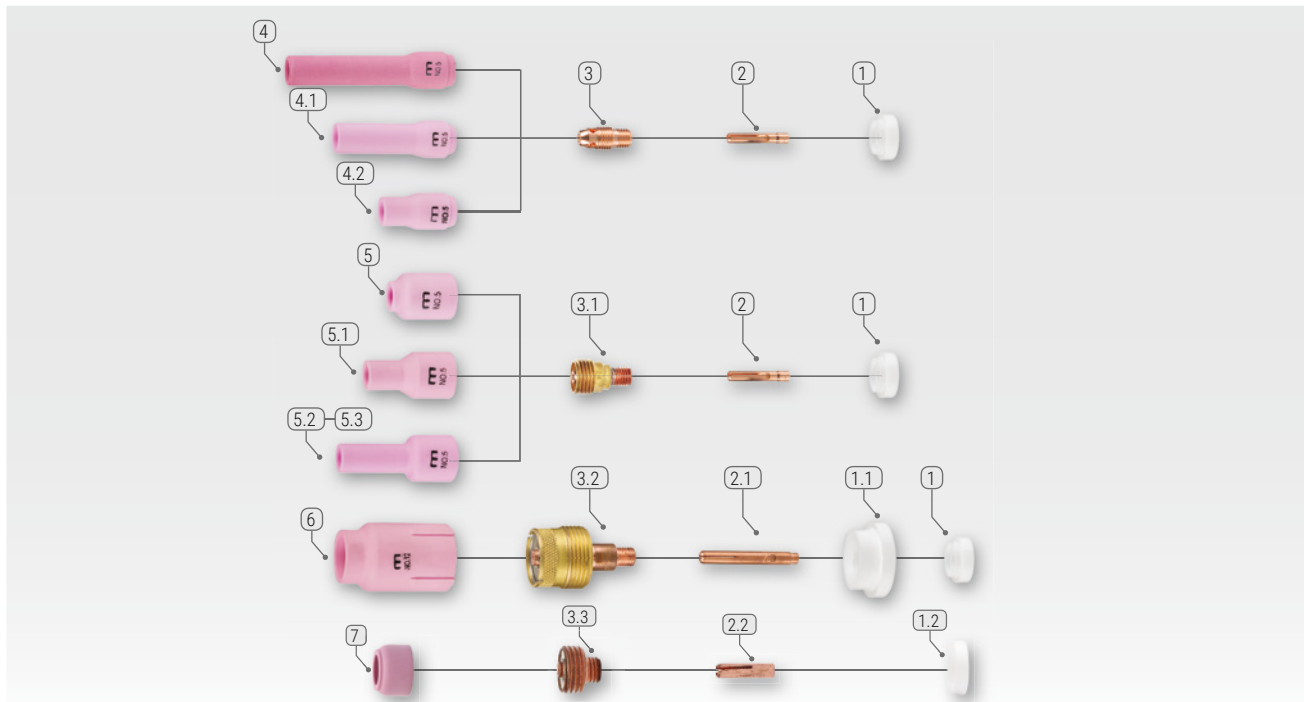

No.	Replaceable elements	Catalogue No.	Altern. ident.
1	9/20 insulator	56 13 014806	598882
1.1	Jumbo 9/20 lens isolator	56 13 014813	56N63-20
1.2	Nozzle insulator 14x32,5 9/20	56 13 013125	
2	Collet 1,0 9/20	56 13 009920	13N21
	Collet 1,6 9/20	56 13 009922	13N22
	Collet 2,0 9/20	56 13 009923	
	Collet 2,4 9/20	56 13 009924	13N23
	Collet 3,2 9/20	56 13 009927	13N24
2.1	Collet sleeve for Jumbo 1,6 9/20 lens	56 13 009983	13N22L
	Collet sleeve for Jumbo lens 2,4 9/20	56 13 009984	13N23L
	Collet sleeve for Jumbo 3,2 9/20 lens	56 13 009985	13N24L
2.2	Collet XS 4x20 2,4 9/20	56 13 010008	
3	TIG collet body 1,0 9/20	56 13 003840	13N26
	TIG collet body 1,6 9/20	56 13 003881	13N27
	TIG collet body 2,0 9/20	56 13 003912	
	TIG collet body 2,4 9/20	56 13 003920	13N28
	TIG collet body 3,2 9/20	56 13 003950	13N29
3.1	Gas lens 1,0 9/20/24	56 13 008230	45V42
	Gas lens 1,6 9/20/24	56 13 008250	45V43
	Gas lens 2,4 9/20/24	56 13 008271	45V44
	Gas lens 3,2 9/20/24	56 13 008300	45V45
3.2	Jumbo gas lens 1,6 9/20	56 13 008313	45V116S
	Jumbo gas lens 2,4 9/20	56 13 008314	45V64S
	Jumbo gas lens 3,2 9/20	56 13 008315	995795S
3.3	Gas lens XS 2,4	56 13 008353	

No.	Replaceable elements	Catalogue No.	Altern. ident.
4	Ceramic nozzle 6,5x63 #4	56 13 000914	796F75
	Ceramic nozzle 8,0x63 #5	56 13 000915	796F76
4.1	Ceramic nozzle 6,5x48 #4	56 13 000947	796F71
	Ceramic nozzle 8,0x48 #5	56 13 000946	796F72
	Ceramic nozzle 9,5x48 #6	56 13 000945	796F73
4.2	Ceramic nozzle 6,5x30 #4	56 13 000384	13N08
	Ceramic nozzle 8,0x30 #5	56 13 000386	13N09
	Ceramic nozzle 9,5x30 #6	56 13 000390	13N10
	Ceramic nozzle 11,0x30 #7	56 13 000394	13N11
	Ceramic nozzle 12,5x30 #8	56 13 000396	13N12
5	Ceramic nozzle 16,0x30 #9	56 13 000398	13N13
	Ceramic nozzle for lens 6,5x25,5 #4	56 13 000908	53N58
	Ceramic nozzle for lens 8,0x25,5 #5	56 13 000910	53N59
	Ceramic nozzle for lens 9,5x25,5 #6	56 13 000911	53N60
5.1	Ceramic nozzle for lens 11,0x25,5 #7	56 13 000912	53N61
	Ceramic nozzle for lens 6,5x35 #4	56 13 000426	53N58L
	Ceramic nozzle for lens 8,0x35 #5	56 13 000427	53N59L
5.2	Ceramic nozzle for lens 9,5x35 #6	56 13 000428	53N60L
	Ceramic nozzle for lens 6,5x48 #4	56 13 000430	53N58XL
	Ceramic nozzle for lens 8,0x48 #5	56 13 000431	53N59XL
5.3	Ceramic nozzle for lens 9,5x48 #6	56 13 000432	53N60XL
	Ceramic nozzle for lens 6,5x63 #4	56 13 000444	53N58XXL
	Ceramic nozzle for lens 8,0x63 #5	56 13 000445	53N59XXL
6	Ceramic nozzle for lens 9,5x63 #6	56 13 000446	53N60XXL
	Ceramic nozzle for lens Jumbo 9,5x48 #8	56 13 001115	57N75
	Ceramic nozzle for lens Jumbo 12,5x48 #8	56 13 001120	57N74
	Ceramic nozzle for lens Jumbo 16,0x48 #10	56 13 001136	53N88
7	Ceramic nozzle for lens Jumbo 19,5x48 #12	56 13 001119	53N87
	Nozzle XS 11x12	56 13 000521	

System for a 14x32,5 transparent nozzle

Improves weld pool visibility.

NEW
in offer

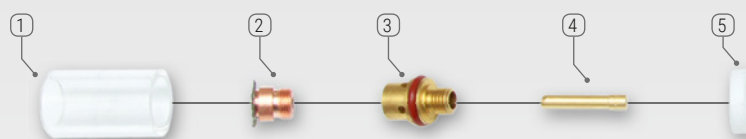

No.	Replaceable elements	Catalogue No.
1	14x32,5 transparent nozzle	56 13 013015
2	Gas lens 1,6 small 14 mm	56 13 013041
	Gas lens 2,4 small 14 mm	56 13 013043
	Gas lens 3,2 small 14 mm	56 13 013044
3	Adapter for 14x32,5 9/20 system	56 13 013141
4	Collet 1,0 25,5 mm	56 13 013080
	Collet 1,6 25,5 mm	56 13 013081
	Collet 2,4 25,5 mm	56 13 013083
	Collet 3,2 25,5 mm	56 13 013084
5	Nozzle insulator 14x32,5 9/20	56 13 013125

System for 29x32 transparent nozzle

Improves weld pool visibility.

Very good laminar gas shield.

NEW
in offer

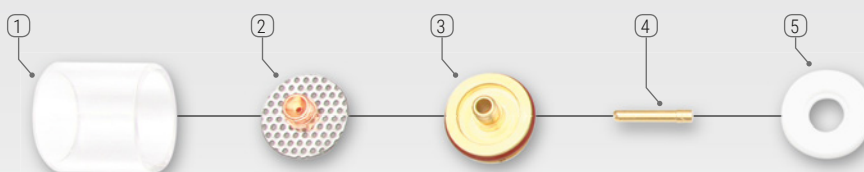

No.	Replaceable elements	Catalogue No.
1	Transparent nozzle 29x32	56 13 013005
2	Gas lens 1,0 large 29 mm	56 13 013030
	Gas lens 1,6 large 29 mm	56 13 013031
	Gas lens 2,4 large 29 mm	56 13 013033
	Gas lens 3,2 large 29 mm	56 13 013034
3	Adapter for 29x32 system	56 13 013136
4	Collet 1,6 25,5 mm	56 13 013081
	Collet 2,4 25,5 mm	56 13 013083
	Collet 3,2 25,5 mm	56 13 013084
5	Nozzle insulator 29x32	56 13 013121

System for a transparent nozzle with a gas lens

NEW
in offer

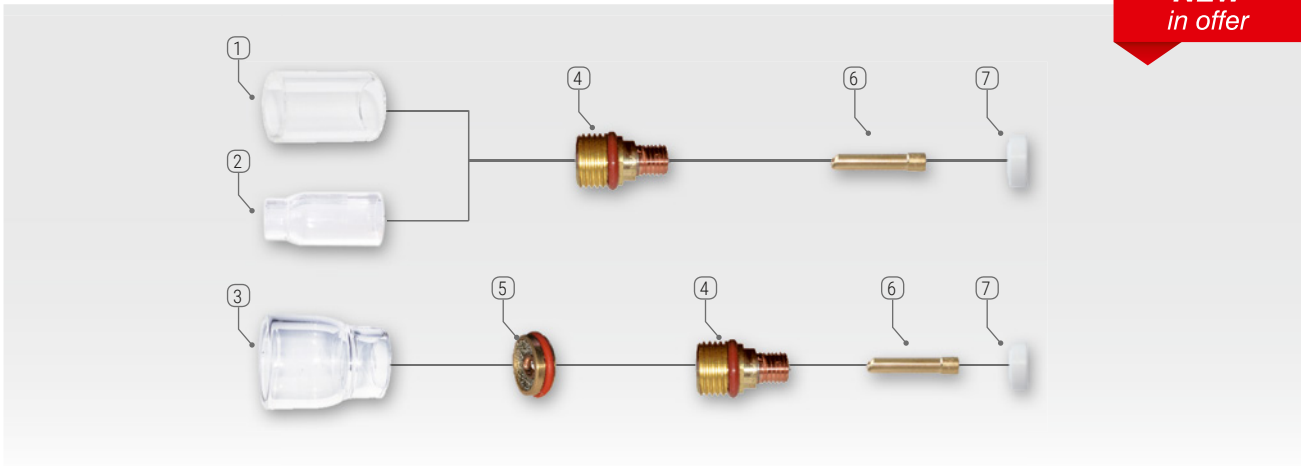

No.	Replaceable elements	Catalogue No.
1	14x32,5 transparent nozzle	56 13 013015
2	Transparent nozzle 9,5x32,5 Transparent nozzle 11x32,5	56 13 013022 56 13 013023
3	Transparent nozzle 25x19,5x28	56 13 013020
4	Gas lens 1,6 45V43 9/20 with an O-ring Gas lens 2,4 45V44 9/20 with an O-ring Gas lens 3,2 45V45 9/20 with an O-ring	56 13 013047 56 13 013048 56 13 013049
5	Adapter for 25x19,5x28 1,6 system Adapter for 25x19,5x28 2,4 system Adapter for 25x19,5x28 3,2 system	56 13 013144 56 13 013145 56 13 013146
6	Collet 1,6 25,5 mm Collet 2,4 25,5 mm Collet 3,2 25,5 mm	56 13 013081 56 13 013083 56 13 013084
7	Nozzle insulator 14x32,5 9/20	56 13 013125



- We provide custom made TIG welding torches adapted to all common welding equipment - send email to export@rywal.com.pl
- TIG welding rods - chapter 10.
- Tungsten electrodes and tungsten electrode sharpeners - see pages 82-83.

XL Cup system

Superior gas coverage, allows for longer electrode stick outs, perfect for welding in tight spaces.

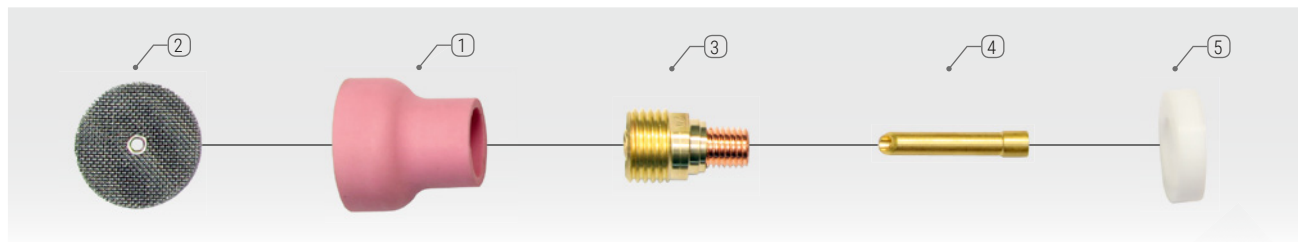

No.	Replaceable elements	Catalogue No.	Remarks
1	Ceramic cup XL 19x26 #12	56 13 000980	
	Ceramic cup XL 23x26 #14	56 13 000981	
	Ceramic cup XL 26x29 #16	56 13 000982	
2	Strainer XL 19x26 1.6	56 13 008370	for the cup #12 19x26
	Strainer XL 19x26 2.4	56 13 008371	
	Strainer XL 19x26 3.2	56 13 008372	
	Strainer XL 23x26 1.6	56 13 008375	for the cup #14 23x26
	Strainer XL 23x26 2.4	56 13 008376	
	Strainer XL 23x26 3.2	56 13 008377	
3	Strainer XL 26x29 1.6	56 13 008378	for the cup #16 26x29
	Strainer XL 26x29 2.4	56 13 008379	
	Strainer XL 26x29 3.2	56 13 008380	
3	Gas lens 9/20 1.6 45V43 MOST	56 13 008250	
	Gas lens 9/20 2.4 45V44 MOST	56 13 008271	
	Gas lens 9/20 3.2 45V45 MOST	56 13 008300	
4	Collet 1.6 25,5 mm	56 13 013081	
	Collet 2.4 25,5 mm	56 13 013083	
	Collet 3.2 25,5 mm	56 13 013084	
5	Cup insulator 14x32,5 9/20	56 13 013125	



XL Cup kits for the TIG torches T9 SGRIP and T20 SGRIP MOST

Name	Catalogue No.
XL Cup kit XL #12 2.4	56 13 001501
XL Cup kit XL #14 2.4	56 13 001505
XL Cup kit XL #16 2.4	56 13 001509



Parts compatible with 17, 18 and 26 TIG welding torches
T125/T250 for the UM17-90 torch head
T225F for UM18-70, UM18-90, UM18-180 torch heads

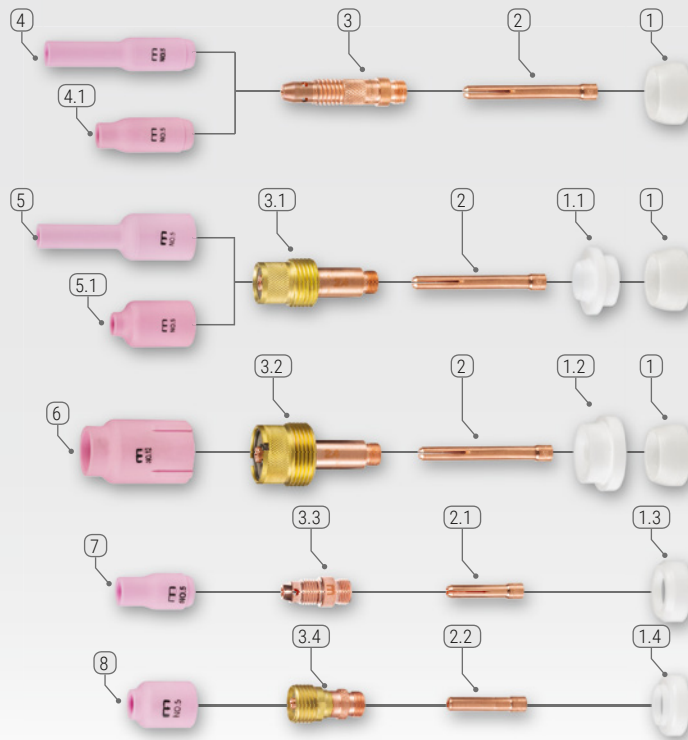

No.	Replaceable elements	Catalogue No.	Altern. ident.
1	18/26 insulator	56 13 014810	18CG
1.1	Lens insulator 18/26	56 13 014812	54N01
1.2	Jumbo 18/26 lens insulator	56 13 017813	54N63
1.3	Insulator short version 18/26	56 13 014826	18CG20
1.4	Lens insulator 18/26, short version	56 13 014822	18CGG
2	Collet 1,0 18/26	56 13 009930	10N22
	Collet 1,6 18/26	56 13 009932	10N23
	Collet 2,0 18/26	56 13 009934	10N24
	Collet 2,4 18/26	56 13 009936	10N24
	Collet 3,2 18/26	56 13 009940	10N25
2	Collet 4,0 18/26	56 13 009942	54N20
2.1	Collet short version 1,0 18/26	56 13 009990	10N22S
	Collet short version 1,6 18/26	56 13 009991	10N23S
	Collet short version 2,4 18/26	56 13 009992	10N24S
	Collet short version 3,2 18/26	56 13 009993	10N25S
2.2	Collet for a short lens 1,6 18/26	56 13 009986	13N22GL
	Collet for a short lens 2,4 18/26	56 13 009987	13N23GL
	Collet for a short lens 3,2 18/26	56 13 009988	13N24GL
3	TIG collet body 1,0 18/26	56 13 003830	10N30
	TIG collet body 1,6 18/26	56 13 003883	10N31
	TIG collet body 2,0 18/26	56 13 003914	10N32
	TIG collet body 2,4 18/26	56 13 003921	10N32
	TIG collet body 3,2 18/26	56 13 003952	10N28
3	TIG collet body 4,0 18/26	56 13 003960	406488
3.1	Gas lens 1,0 18/26	56 13 008235	45V24
	Gas lens 1,6 18/26	56 13 008252	45V25
	Gas lens 2,4 18/26	56 13 008272	45V26
	Gas lens 3,2 18/26	56 13 008301	45V27
	Gas lens 4,0 18/26	56 13 008310	45V28
3.2	Gas lens Jumbo 2,4	56 13 008276	45V64
	Gas lens Jumbo 3,2	56 13 008280	99795
3.3	TIG collet body 1,0-3,2 18/26, short version	56 13 003930	17CB20
3.4	Gas lens short version 1,6 18/26	56 13 008320	45V43L
	Gas lens short version 2,4 18/26	56 13 008321	45V44L
	Gas lens short version 3,2 18/26	56 13 008322	45V45L

No.	Replaceable elements	Catalogue No.	Altern. ident.
4	Ceramic nozzle 8,0x76 #5	56 13 001006	10N49L
	Ceramic nozzle 9,5x76 #6	56 13 001008	10N48L
	Ceramic nozzle 11,0x76 #7	56 13 001010	10N47L
4.1	Ceramic nozzle 6,5x47 #4	56 13 000768	10N50
	Ceramic nozzle 8,0x47 #5	56 13 000770	10N49
	Ceramic nozzle 9,5x47 #6	56 13 000780	10N48
	Ceramic nozzle 11,0x47 #7	56 13 000783	10N47
	Ceramic nozzle 12,5x47 #8	56 13 000784	10N46
	Ceramic nozzle 16,0x47 #10	56 13 000786	10N45
4.1	Ceramic nozzle 19,5x47 #12	56 13 000788	10N44
5	Ceramic nozzle for lens 6,5x76 #4	56 13 000950	54N18L
	Ceramic nozzle for lens 8,0x76 #5	56 13 000951	54N17L
	Ceramic nozzle for lens 9,5x76 #6	56 13 000952	54N16L
	Ceramic nozzle for lens 11,0x76 #7	56 13 000953	54N15L
5	Ceramic nozzle for lens 12,8x76 #8	56 13 000954	54N14L
5.1	Ceramic nozzle for lens 6,5x42 #4	56 13 000902	54N18
	Ceramic nozzle for lens 8,0x42 #5	56 13 000900	54N17
	Ceramic nozzle for lens 9,5x42 #6	56 13 000888	54N16
	Ceramic nozzle for lens 11,0x42 #7	56 13 000886	54N15
	Ceramic nozzle for lens 12,5x42 #8	56 13 000884	54N14
5.1	Ceramic nozzle for lens 19,5x42 #12	56 13 000882	54N19
6	Ceramic nozzle for lens Jumbo 9,5x48 #6	56 13 001115	57N75
	Ceramic nozzle for lens Jumbo 12,5x48 #8	56 13 001120	57N74
	Ceramic nozzle for lens Jumbo 16,0x48 #10	56 13 001136	53N88
	Ceramic nozzle for lens Jumbo 19,5x48 #12	56 13 001119	53N87
7	Ceramic nozzle 6,5x30 #4	56 13 000384	13N08
	Ceramic nozzle 8,0x30 #5	56 13 000386	13N09
	Ceramic nozzle 9,5x30 #6	56 13 000390	13N10
	Ceramic nozzle 11,0x30 #7	56 13 000394	13N11
	Ceramic nozzle 12,5x30 #8	56 13 000396	13N12
7	Ceramic nozzle 16,0x30 #9	56 13 000398	13N13
8	Ceramic nozzle for lens 6,5x25,5 #4	56 13 000908	53N58
	Ceramic nozzle for lens 8,0x25,5 #5	56 13 000910	53N59
	Ceramic nozzle for lens 9,5x25,5 #6	56 13 000911	53N60
	Ceramic nozzle for lens 11,0x25,5 #7	56 13 000912	53N61

System for 29x47 transparent nozzles

Very good laminar gas shield.

NEW
in offer

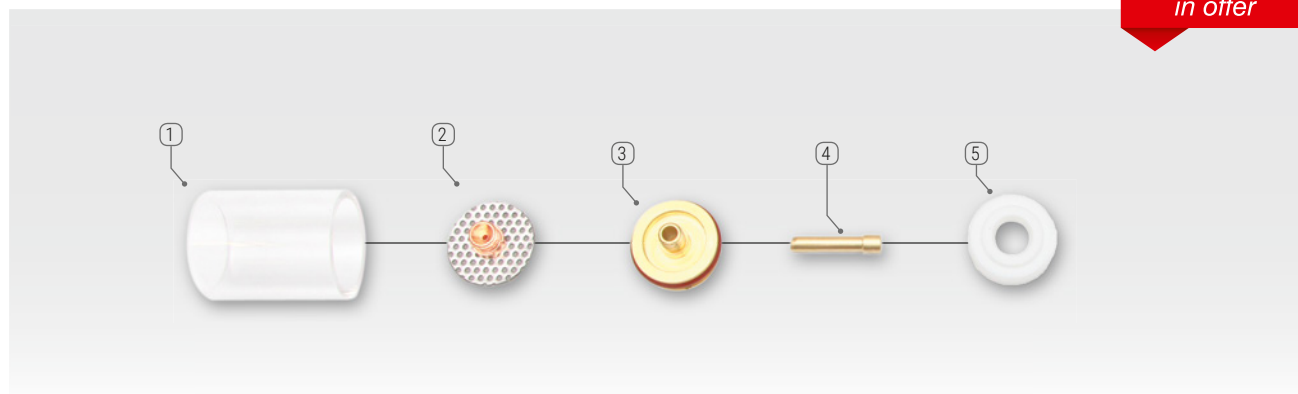

No.	Replaceable elements	Catalogue No.
1	Transparent nozzle 29x47	56 13 013000
2	Gas lens 1,0 large 29 mm	56 13 013030
	Gas lens 1,6 large 29 mm	56 13 013031
	Gas lens 2,4 large 29 mm	56 13 013033
	Gas lens 3,2 large 29 mm	56 13 013034
3	Adapter for 29x47 system	56 13 013135
4	Collet 1,0 33 mm	56 13 013070
	Collet 1,6 33 mm	56 13 013071
	Collet 2,4 33 mm	56 13 013073
	Collet 3,2 33 mm	56 13 013074
5	Nozzle insulator 29x47	56 13 013120

System for a transparent nozzle with a gas lens

NEW
in offer

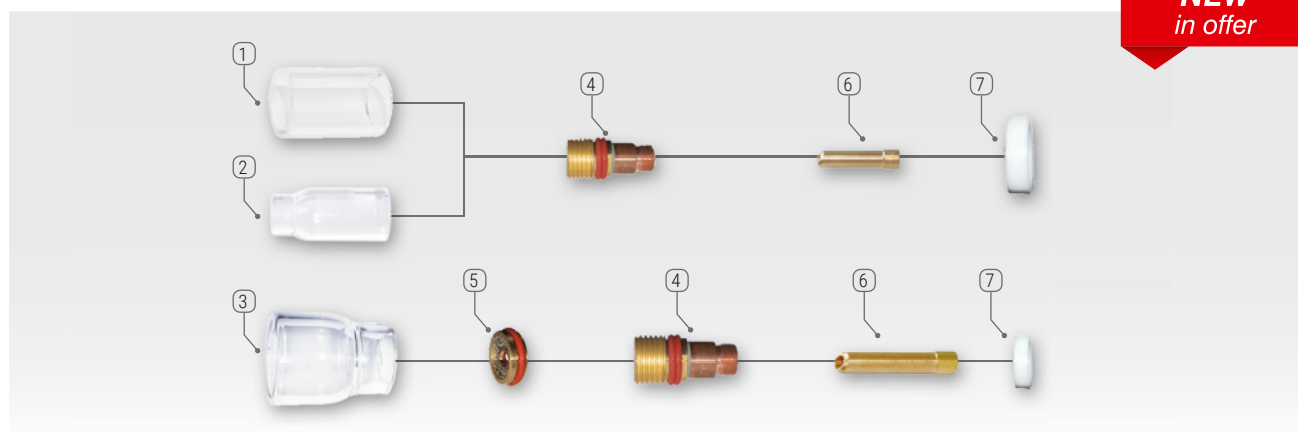

No.	Replaceable elements	Catalogue No.
1	Transparent nozzle 14x32,5	56 13 013015
2	Transparent nozzle 9,5x32,5	56 13 013022
	Transparent nozzle 11x32,5	56 13 013023
3	Transparent nozzle 25x19,5x28	56 13 013020
4	Gas lens, short 1,6 18/26 with an O-ring	56 13 013050
	Gas lens, short 2,4 18/26 with an O-ring	56 13 013051
	Gas lens, short 3,2 18/26 with an O-ring	56 13 013052
5	Adapter for 25x19,5x28 1,6 system	56 13 013144
	Adapter for 25x19,5x28 2,4 system	56 13 013145
	Adapter for 25x19,5x28 3,2 system	56 13 013146
6	Collet 1,6 33 mm	56 13 013071
	Collet 2,4 33 mm	56 13 013073
	Collet 3,2 33 mm	56 13 013074
7	Insulator for short version 17/18/26 18CG20	56 13 014826

XL Cup system

Superior gas coverage, allows for longer electrode stick outs, perfect for welding in tight spaces.

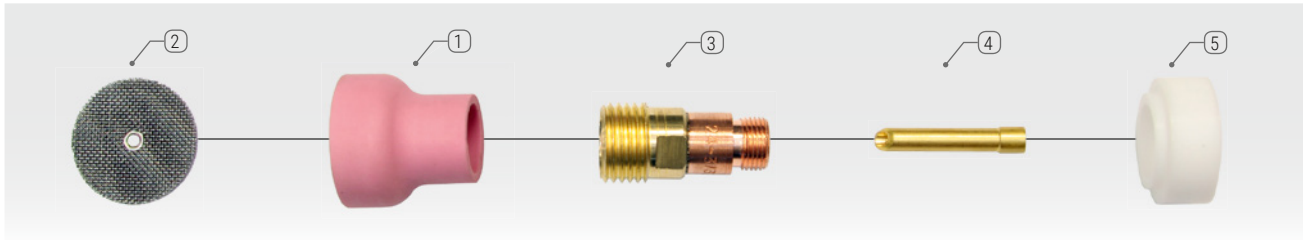

No.	Replaceable elements	Catalogue No.	Remarks
1	Ceramic cup XL 19x26 #12	56 13 000980	
	Ceramic cup XL 23x26 #14	56 13 000981	
	Ceramic cup XL 26x29 #16	56 13 000982	
2	Strainer XL 19x26 1.6	56 13 008370	for the cup #12 19x26
	Strainer XL 19x26 2.4	56 13 008371	
	Strainer XL 19x26 3.2	56 13 008372	
2	Strainer XL 23x26 1.6	56 13 008375	for the cup #4 23x26
	Strainer XL 23x26 2.4	56 13 008376	
	Strainer XL 23x26 3.2	56 13 008377	
2	Strainer XL 26x29 1.6	56 13 008378	for the cup #6 26x29
	Strainer XL 26x29 2.4	56 13 008379	
	Strainer XL 26x29 3.2	56 13 008380	
3	Gas lens stubby 17/26/18 1.6 45V43L MOST	56 13 008320	
	Gas lens stubby 17/26/18 2.4 45V44L MOST	56 13 008321	
	Gas lens stubby 17/26/18 3.2 45V45L MOST	56 13 008322	
4	Collet 1.6 33 mm	56 13 013071	
	Collet 2.4 33 mm	56 13 013073	
	Collet 3.2 33 mm	56 13 013074	
5	Cup insulator 17/26/18 18CGG MOST	56 13 014822	



XL Cup kits for the TIG torches T18 SGRIP and T26 SGRIP MOST

Name	Catalogue No.
Cup kit XL #12 2.4	56 13 001521
Cup kit XL #14 2.4	56 13 001525
Cup kit XL #16 2.4	56 13 001529



Parts compatible with 24G and 24W TIG welding torches T225F UM24-70 and UM24-90 torch heads

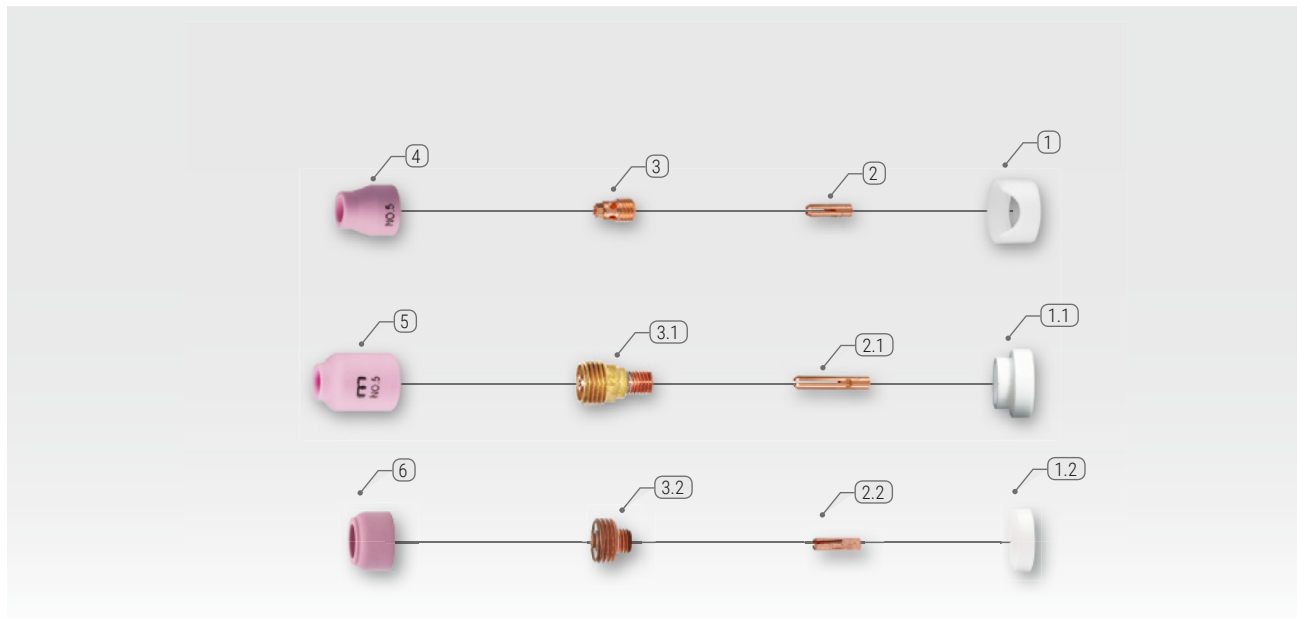

No.	Replaceable elements	Catalogue No.	Alternative designation
1	Insulator 24	56 13 014823	53N22
1.1	Lens insulator 24	56 13 014825	53N66
1.2	Lens insulator XS 24	56 13 014827	
2	Collet 1,6 24 Collet 2,4 24	56 13 009996 56 13 009997	53N14 24C332
2.1	Collet for gas lens 1,6 24 Collet for gas lens 1,6 24	56 13 010001 56 13 010002	53N54 24GLC332
2.2	Collet XS 2.4 4*15,5	56 13 009999	
3	TIG collet body 1,6 24 TIG collet body 2,4 24	56 13 003972 56 13 003973	53N19 24CB332
3.1	Gas lens 1,6 9/20/24 Gas lens 2,4 9/20/24	56 13 008250 56 13 008271	45V43 45V44
3.2	Gas lens XS 2,4	56 13 008353	
4	Ceramic nozzle 6,5x16,5 #4 Ceramic nozzle 8,0x16,5 #5 Ceramic nozzle 9,5x16,5 #6	56 13 000512 56 13 000513 56 13 000514	53N24 53N25 53N26
5	Ceramic nozzle for gas lens 6,5x25,5 #4 Ceramic nozzle for gas lens 8,0x25,5 #5 Ceramic nozzle for gas lens 9,5x25,5 #6 Ceramic nozzle for gas lens 11,0x25,5 #7	56 13 000908 56 13 000910 56 13 000911 56 13 000912	53N58 53N59 53N60 53N61
6	Ceramic nozzle XS 11x12	56 13 000521	

- We provide custom made TIG welding torches adapted to all common welding equipment - send email to export@rywal.com.pl
- TIG welding rods - chapter 10.
- Tungsten electrodes and tungsten electrode sharpeners - see pages 82-83.

Parts compatible with TIG torch 18SC

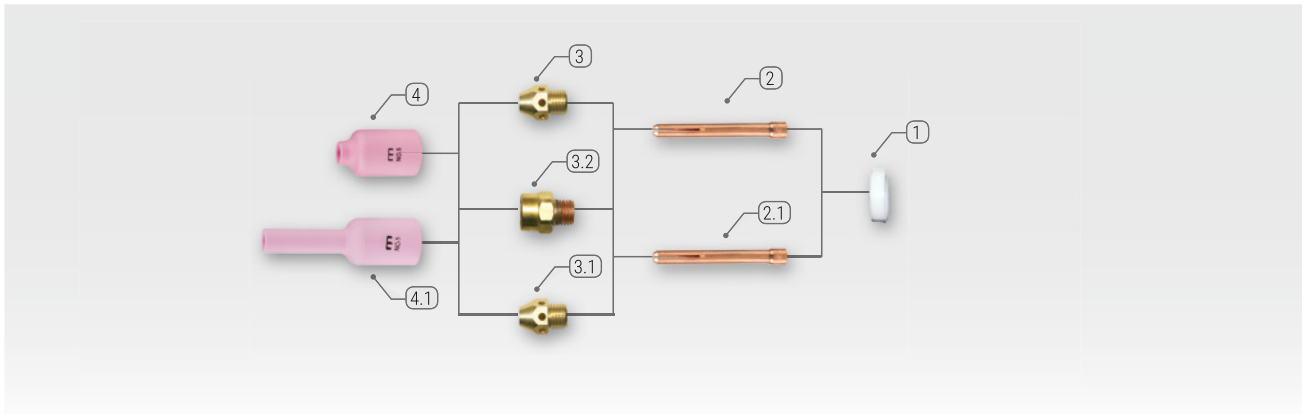

No.	Replaceable elements	Catalogue No.
1	Insulator SRT-18SC 712.6043	56 13 014818
2	Collet 17/18/26 1.0 10N22 MOST	56 13 009930
	Collet 17/18/26 1.6 10N23 MOST	56 13 009932
	Collet 17/18/26 2.0 MOST	56 13 009934
2.1	Collet 17/18/26 2.4 10N24 MOST	56 13 009936
	Collet 17/18/26 3.2 10N25 MOST	56 13 009940
3	Collet 18SC HL 4.0 712. 6065	56 13 010040
	Collet 18SC HL 4.8 712. 6066	56 13 010041
3.1	TIG collet body 0,5-3,2 mm 18SC 712.6074	56 13 003820
3.2	TIG collet body	56 13 003945
	Gas lens 18SC 2,4 mm 712.6102	56 13 008273
	Gas lens 18SC 3,2 mm 712.6103	56 13 008302
	Gas lens 18SC 4,0 mm 712.6104	56 13 008303
4	Gas lens 18SC 4,8 mm 712.6105	56 13 008312
	Ceramic nozzle 17/26/18/SC LAM. 54N18 6.5X42 MOST	56 13 000902
	Ceramic nozzle 17/26/18/SC LAM. 54N17 8.0X42 MOST	56 13 000900
	Ceramic nozzle 17/26/18/SC LAM. 54N16 9.5X42 MOST	56 13 000888
	Ceramic nozzle 17/26/18/SC LAM. 54N15 11.0X42 MOST	56 13 000886
	Ceramic nozzle 17/26/18/SC LAM. 54N14 12.5X42 MOST	56 13 000884
4.1	Ceramic nozzle 17/26/18/SC LAM. 54N19 19.5X42 MOST	56 13 000882
	Ceramic nozzle 17/18/26 LAM. 54N18L 6.5x76 MOST	56 13 000950
	Ceramic nozzle 17/26/18 LAM. 54N17L 8.0X76 MOST	56 13 000951
	Ceramic nozzle 17/26/18 LAM. 54N16L 9.5X76 MOST	56 13 000952
	Ceramic nozzle 17/26/18 LAM. 54N15L 11.0X76 MOST	56 13 000953
	Ceramic nozzle 17/18/26 LAM. 54N14L 12,5x76 MOST	56 13 000954

- We provide custom made TIG welding torches adapted to all common welding equipment - send email to export@rywal.com.pl
- TIG welding rods - chapter 10.
- Tungsten electrodes and tungsten electrode sharpeners - see pages 82-83.