

LITEFLIP AUTOPILOT

Welding made easy.

Look into the future.



SEE
WHAT YOU
CAN DO

The first flip-up with autopilot arrived.

Until today:

The semi-automated welding mask...

automatically darkens as soon as the welding arc ignites. The shade level must be set manually according to changing lighting.

New:

The fully automated welding mask...

automatically darkens as soon as the welding arc ignites. No manual shade level setting necessary. The optrel liteflip autopilot automatically adjusts to changing lighting.



Flip-up
open

Clear view

Light
state

Inactive
mode

Autopilot Range

for all important work sequences

Adjusts automatically to the changing light conditions of the current welding method.

World exclusive: automatic adjustment up to shade level 14!

shade level

1

4

5

6

7

8

9

10

11

12

13

14

BONUS

optrel liteflip autopilot:

Combines the advantages of a flip-up welding helmet with the comfort of the optrel autopilot. Combines perfectly with the optrel e3000x respiratory protection.

Welding made easy.

Super lightweight flip-up welding helmet with automatic shade level adjustment makes welding much more comfortable and easy.



Autopilot with shade levels 1 / 4 / 5-14

With a shade level range from 5 to 14 and fully automatic adjustment, the optrel **liteflip** autopilot achieves a new level of performance: All work sequences, such as measuring, testing, grinding, and other welding applications, can be handled without any manual adjustments at the helmet. And of course, without displacing the helmet itself. The welder is always protected perfectly.



Lightweight

Weighing only 530g, the **liteflip** autopilot is one of the lightest flip-up welding helmets available. Its ergonomic design minimizes strain on the head and neck, ensuring comfort throughout the work day.



Respiratory Protection

The **liteflip** autopilot is perfectly combined with the optrel e3000x PAPR respiratory system. With its integrated high-performance particle filter (TH3), welders are adequately protected against smoke, dust, and aerosols.



True-color view

The specially developed UV/IR filter allows a realistic perception of colours and at long last brings colour into the world of the welder.



2+1 Year Warranty



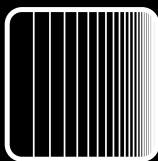





Register your optrel **liteflip** autopilot online and receive an additional year of warranty for free:
<http://register.optrel.com>



Twilight adf technology

Unlike other ADF lenses that rapidly return to light, the Twilight ADF Technology restores light more naturally, presenting a smoother transition to the eyes. This exclusive technology reduces eye fatigue on welders who are continuously welding, enabling them to work safer and more comfortably.



| Helmet system | Item no. | Main accessories | Item no. |
|--|----------|--|----------|
|  liteflip autopilot welding helmet | 1006.700 |  optrel parking buddy | 5002.900 |
|  liteflip autopilot welding helmet with industrial helmet | 1006.750 |  Front cover lens | 5000.391 |
|  liteflip autopilot fresh air helmet | 4441.700 |  Safety lens | 5000.390 |
|  liteflip autopilot fresh air helmet with industrial helmet | 4441.750 |  optrel bag for helmets | 8000.100 |

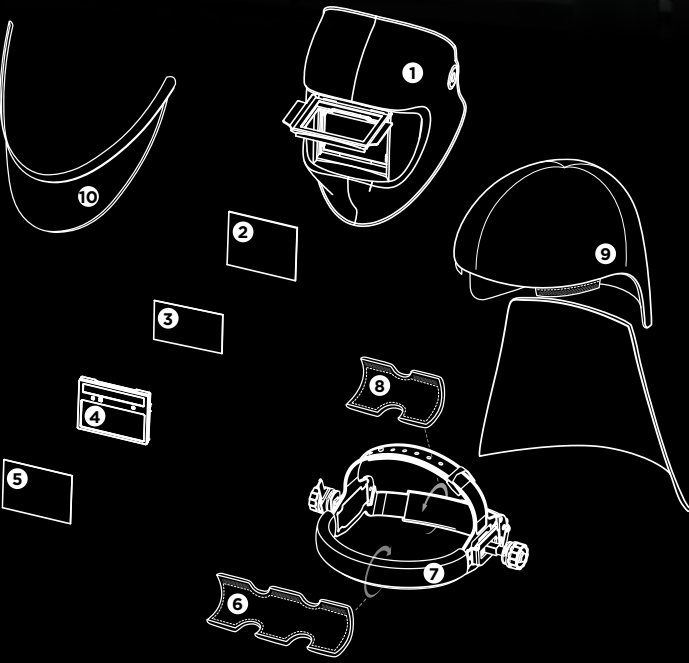

| Spare parts and accessories | Item no. |
|---|----------|
| 1 Helmet shell liteflip autopilot | 5001.916 |
| PAPR helmet shell liteflip autopilot | 4290.000 |
| 2 Safety lens (5 pcs.) | 5000.390 |
| 3 Inside cover lens (5 pcs.) | 5000.001 |
| 4 Spare ADF cartridge | 5012.490 |
| 5 Front cover lens (5 pcs.) | 5000.391 |
| 6 Cotton sweatband (2 pcs.) | 5004.073 |
| 7 Adjustable headband (including sweatband and comfortband) | 5003.250 |
| 8 Cotton sweatband (2 pcs.) | 5004.020 |
| 9a Head & neck protector, leather | 4028.016 |
| 9b Head & neck protector PAPR, leather | 4028.031 |
| 10 Chest protector, leather | 4028.015 |



Technical Data

| | | | | |
|--------------------------|--|-----------------------|---|---|
| Description | Fully automatic welding helmet (no manual adjustment necessary) with flip-up function for a clear view. True-color view, ADF with shade level range 4/5-14M with autopilot (automatic shade level adjustment), +/- 2 individual manual offset, sensitivity adjustment, and opening delay with or without twilight function. | Classification | Optical class: | 1 |
| | | EN379 | Diffusion of light class: | 1 |
| | | | Variations in luminous transmittance class: | 1 |
| | | | Angle dependence of luminous transmittance class: | 2 |
| | | Shape stability | Welding mask: up to 220°C / 428°F Front cover lens: up to 137°C / 279°F | |
| Shade levels | Open / clear view: shade level 1 Closed / inactive: shade level 4 Closed / active: shade levels 5-14 | Eye protection | Ultraviolet / Infrared Protection: maximum protection at any shade level | |
| Autopilot | Automatic shade level adjustment for shade level range 5 to 14 with individual calibration option of ± 2. | Operating temperature | -10°C to +70°C / 14°F to 158°F | |
| Power supply | Photovoltaic cell, 2 pcs batteries 3V exchangeable (CR2032) | Storage temperature | -20°C to +80°C / -4°F to 176°F | |
| Operating time batteries | Approx. 3,000 hours (operating) | Weight | Standard helmet: 530 g / 18.7 oz PAPR helmet: 730 g / 25.8 oz | |
| Sensors | 3 sensors | Application ranges | Any electric arc welding process Electrode Welding (Stick Welding, SMAW) / MIG / MAG (GMAW) / GMAW High melting rate process / Flux Cored Wire Welding / TIG welding (GTAW) / Plasma Arc Welding / Plasmacutting & Oxy-gas Welding <i>Prohibited for laser welding!</i> | |
| Sensitivity | Infinite adjustment, new with "Super High" range | Scope of delivery | Welding helmet, instruction manual, storage bag, batteries, warranty card | |
| Switching time | Light to dark: 0.100 ms at room temperature 0.100 ms at 55°C / 131°F Dark to light: 0.3 s or 1.5 s (with twilight function) | Standards | CE, ANSI Z87.1, EAC, complies with CSA Z94.3 | |
| Field of view | Flip-up open: 82 x 102 mm Flip-up closed: 50 x 100 mm | Warranty | 2 years (except batteries) 1 year warranty extension for online product registration within the first 6 month. http://register.optrel.com | |

A better view.
Better air.
Better work.



Your optrel Reseller:



optrel AG
industriestrasse 2
CH-9630 wattwil
switzerland
www.optrel.com
info@optrel.com

optrel.com



Art. no. 9412.124.00